

Operation Guide 5147

CASIO®

- The configuration of your watch may differ somewhat from that shown in the illustration.

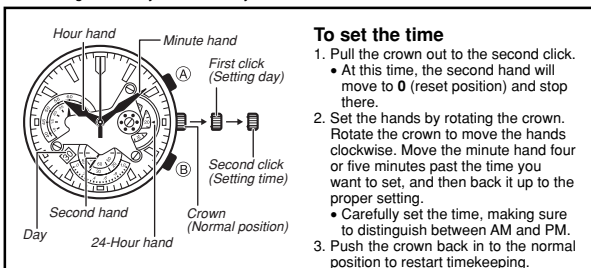

To set the time

1. Pull the crown out to the second click.
 - At this time, the second hand will move to 0 (reset position) and stop there.
2. Set the hands by rotating the crown. Rotate the crown to move the hands clockwise. Move the minute hand four or five minutes past the time you want to set, and then back it up to the proper setting.
 - Carefully set the time, making sure to distinguish between AM and PM.
3. Push the crown back in to the normal position to restart timekeeping.

To set the day

1. Pull the crown out to the first click.
2. Set the day by rotating the crown towards you.
3. Push the crown back in to the normal position.
 - Avoid changing the date setting while the current time is between 9:00 p.m. and 1:00 a.m.

Using the Stopwatch



The stopwatch lets you measure elapsed time up to 59 minutes, 59.95 seconds.

To measure elapsed time

1. Press (A) to start the stopwatch.
 2. Press (A) to stop the stopwatch.
 - You can resume the measurement operation by pressing (A) again.
 3. Check the elapsed time.
 - The example above shows an elapsed time of 2 minutes, 37.80 seconds.
 - Press (B) to reset the stopwatch.
- To return the function of the stopwatch 1/20 second hand to the timekeeping second hand (indicating the current seconds count), press (B) again. This will enter the Timekeeping Mode.

Notes:

- Do not try to perform stopwatch operations while the crown is pulled out either to the first or second click. If you try to press a button, you might accidentally cause the crown to rotate and change the current time or day setting.
- If the starting positions of the stopwatch second hand and 1/20 second hand become misaligned, use the following procedures to adjust the position of the stopwatch second hand so it points to 12 o'clock and the 1/20 second hand so it points to .0 when the stopwatch is reset.

To adjust the positions of the stopwatch hands

1. Press (B) to reset the stopwatch, and check the alignment of the stopwatch second hand and 1/20 second hand.
2. Pull out the crown to the second click.
3. Press (A) to move the stopwatch second hand.
4. If the stopwatch 1/20 second hand is aligned correctly, proceed to step 5. If the stopwatch 1/20 second hand is also misaligned, press (B) to move the stopwatch 1/20 second hand.
5. After making the adjustments you want, push the crown back in to its normal position.
 - Note that pulling the crown out also stops the timekeeping second hand. After performing the above procedure, you should also adjust the timekeeping setting.

- For a watch with an elapsed time bezel
Rotate the elapsed time bezel to align the ▽ mark with the minute hand.
After certain amount of time elapsed, read the graduation on the elapsed time bezel which the minute hand points to.
The elapsed time is indicated.



Elapsed time bezel

- Some water resistant models are equipped with a screw lock crown.
- With such models, you must unscrew the crown in the direction noted in the illustration to loosen it before you can pull it out. Do not pull too forcibly on such crowns.
- Also note that such watches are not water resistant while their crowns are loosened. Be sure to screw the crowns back in as far as they will go after making any setting.



Specifications

Accuracy at normal temperature: ± 20 seconds a month

Display: 3 analog hands (timekeeping hour and minutes, stopwatch seconds), 3 dials (timekeeping 24-hour, timekeeping seconds/stopwatch 1/20 second, stopwatch minutes), day

Stopwatch function: Measuring capacity: 59'59.95"
Measuring unit: 1/20 second
Measuring mode: Elapsed time

Battery: One silver oxide battery (Type: SR927W)
Approximately 2 years on type SR927W

Free Manuals Download Website

<http://myh66.com>

<http://usermanuals.us>

<http://www.somanuals.com>

<http://www.4manuals.cc>

<http://www.manual-lib.com>

<http://www.404manual.com>

<http://www.luxmanual.com>

<http://aubethermostatmanual.com>

Golf course search by state

<http://golfingnear.com>

Email search by domain

<http://emailbydomain.com>

Auto manuals search

<http://auto.somanuals.com>

TV manuals search

<http://tv.somanuals.com>