

User's Guide

Dell S2419H/S2419HN/S2419NX/
S2719H/S2719HN/S2719NX

Model No.: S2419H/S2419HN/S2419NX/S2719H/S2719HN/
S2719NX

Regulatory model: S2419Hc/S2419Nc/S2719Hc/S2719Nc



Notes, cautions, and warnings

 **NOTE:** A NOTE indicates important information that helps you make better use of your computer.

 **CAUTION:** A CAUTION indicates potential damage to hardware or loss of data if instructions are not followed.

 **WARNING: A WARNING indicates a potential for property damage, personal injury or death.**

Information in this document is subject to change without notice.

© 2018 Dell Inc. All rights reserved.

Reproduction of these materials in any manner whatsoever without the written permission of Dell Inc. is strictly forbidden.

Trademarks used in this text: *Dell* and the *DELL* logo are trademarks of Dell Inc.; *Microsoft* and *Windows* are either trademarks or registered trademarks of Microsoft Corporation in the United States and/or other countries, *Intel* is a registered trademark of Intel Corporation in the U.S. and other countries; and *ATI* is a trademark of Advanced Micro Devices, Inc. ENERGY STAR is a registered trademark of the U.S. Environmental Protection Agency. As an ENERGY STAR partner, Dell Inc. has determined that this product meets the ENERGY STAR guidelines for energy efficiency.

Other trademarks and trade names may be used in this document to refer to either the entities claiming the marks and names or their products. Dell Inc. disclaims any proprietary interest in trademarks and trade names other than its own.

Contents

About your monitor	5
Package contents	5
Product features	6
Identifying parts and controls	7
Monitor specifications	10
Plug and play capability	19
LCD monitor quality and pixel policy	19
Maintenance guidelines.....	19
Setting up the monitor	20
Connecting the stand	20
Connecting your monitor	22
Organizing cables	23
Removing the stand	23
Operating your monitor	25
Power on the monitor.....	25
Using the control buttons	25
Using the on-screen display (OSD) menu	27
Setting up your monitor	36
Using tilt.....	38

Troubleshooting 39

- Self-Test..... 39
- Built-in diagnostics 40
- Common problems..... 41
- Product-specific problems 43



Appendix 44



- FCC notices (U.S. Only) and other regulatory information..... 44
- Contacting Dell 44



About your monitor

Package contents

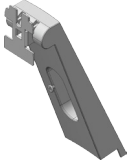
Your monitor ships with the components shown below. Ensure that you have received all the components and see [Contacting Dell](#) for more information if something is missing.

-  **NOTE:** Some items may be optional and may not ship with your monitor. Some features or media may not be available in certain countries.
-  **NOTE:** To set up with any other stand, please refer to the respective stand setup guide for setup instructions.

	<ul style="list-style-type: none">• Monitor
	<ul style="list-style-type: none">• Stand riser
	<ul style="list-style-type: none">• Stand base
	<ul style="list-style-type: none">• Power Cable (Varies by Countries)
	<ul style="list-style-type: none">• Power Adapter

	<ul style="list-style-type: none"> • HDMI Cable
	<ul style="list-style-type: none"> • Quick Setup Guide • Safety and Regulatory Information

Product features

The **Dell S2419H/S2419HN/S2419NX/S2719H/S2719HN/S2719NX** flat panel display has an active matrix, Thin-Film Transistor (TFT), Liquid Crystal Display (LCD), anti-static, and LED backlight. The monitor features include:

- **S2419H/S2419HN/S2419NX:** 60.47 cm (23.8 inch) viewable area display (measured diagonally). 1920 x 1080 resolution, plus full-screen support for lower resolutions.
- **S2719H/S2719HN/S2719NX:** 68.6 cm (27 inch) viewable area display (measured diagonally). 1920 x 1080 resolution, plus full-screen support for lower resolutions.
- Borderless monitor.
- Wide viewing angle to allow viewing from a sitting or standing position, or while moving from side-to-side.
- HDMI connectivity makes it simple and easy to connect with legacy and new systems.
- **S2419H/S2719H:** Build-in Speaker (5 W)x2
- Plug and play capability if supported by your system.
- On-Screen Display (OSD) adjustments for ease of set-up and screen optimization.
- Energy Saver feature for Energy Star compliance.
- Security-lock slot.
- TCO-Certified Displays.
- BFR/PVC-Reduced (Its circuit boards are made from BFR/PVC-free laminates.)
- Arsenic-Free glass and Mercury-Free for the panel only.
- High Dynamic Contrast Ratio (8,000,000:1).
- 0.3 W standby power when in the sleep mode.
- Energy Gauge shows the energy level being consumed by the monitor in real time.
- Optimize eye comfort with a flicker-free screen and ComfortView feature which minimizes blue light emission.

Identifying parts and controls

Front view

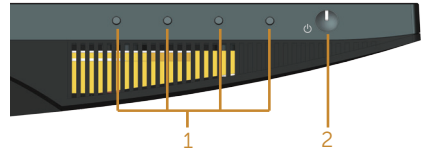

Control buttons

Label	Description
1	Function buttons (For more information, see Operating your monitor)
2	Power On/Off button

Back view



Back View with monitor stand

Label	Description	Use
1	Security-lock slot	Secures monitor with security lock (security lock not included).
2	Regulatory label (including Barcode serial number and Service Tag label)	Lists the regulatory approvals. Refer to this label if you need to contact Dell for technical support. The Dell service tag is used for Dell warranty and customer service management purposes and for records of the base system.
3	Regulatory information engraving.	Lists the regulatory approvals.
4	Stand release button	Releases stand from monitor.
5	Cable management slot	Uses to organize cables by placing them through the slot.

Side view

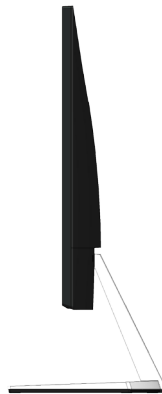

Bottom view



Bottom view without monitor stand (S2419H/S2719H)



Bottom view without monitor stand (S2419HN/S2419NX/S2719HN//S2719NX)

Label	Description	Use
1	Speakers	Speakers
2	Power-adapter port	To connect the monitor power cable using a 12V DC adapter.
3	HDMI1 port	Connect your computer with HDMI cable.
4	HDMI2 port	Connect your computer with HDMI cable.
5	Audio Line out port	Connect to external speakers (Optional Purchase)*

*Headphone usage is not supported for the audio line out port.

Monitor specifications

Model	S2419H/S2419HN/ S2419NX	S2719H/S2719HN/ S2719NX
Screen type	Active matrix-TFT LCD	
Panel type	In-Plane Switching	
Viewable image		
Diagonal	604.70 mm (23.81 in)	686.00 mm (27 in)
Horizontal, Active Area	527.04 mm (20.75 in)	597.89 mm (23.54 in)
Vertical, Active Area	296.46 mm (11.67 in)	336.31 mm (13.24 in)
Area	1562.46 cm ² (242.15 in ²)	2010.76 cm ² (311.67 in ²)
Pixel pitch	0.2745 mm	0.3114 mm
Pixel per inch (PPI)	92	81
Viewing angle	178° (vertical) typical 178° (horizontal) typical	178° (vertical) typical 178° (horizontal) typical
Brightness	250 cd/m ² (typical)	250 cd/m ² (typical)
Contrast ratio	1000 to 1 (typical) 8,000,000 to 1 (Dynamic Contrast)	1000 to 1 (typical) 8,000,000 to 1 (Dynamic Contrast)
Faceplate coating	Low Haze with 3H hardness	
Backlight	LED edgelight system	
Response time	5 ms typical (G to G)	
Color depth	16.7 million colors	
Color gamut	CIE 1976 (84%), CIE 1931 (72%), >99% sRGB	
Dell display manager compatibility	Yes	
Connectivity	2xHDMI 1.4 (HDCP)	
Border width (edge of monitor to active area)	5.3 mm (Top) 5.3 mm (Left/Right) 8.3 mm (Bottom)	6.7 mm (Top) 6.8 mm (Left/Right) 8.4 mm (Bottom)
Security	Security lock slot (cable lock optional purchase)	
Adjustability	Tilt (5°/21°)	

Resolution specifications

Model	S2419H/S2419HN/ S2419NX	S2719H/S2719HN/ S2719NX
Horizontal scan range	31 kHz to 83 kHz (automatic)	31 kHz to 83 kHz (automatic)
Vertical scan range	56 Hz to 76 Hz (automatic)	56 Hz to 76 Hz (automatic)
Maximum preset resolution	1920 x 1080 at 60 Hz for HDMI 1.4 (HDCP) port.	1920 x 1080 at 60 Hz for HDMI 1.4 (HDCP) port.

Supported video modes

Model	S2419H/S2419HN/ S2419NX	S2719H/S2719HN/ S2719NX
Video display capabilities (HDMI)	480p, 480i, 576p, 720p, 1080p, 576i, 1080i	480p, 480i, 576p, 720p, 1080p, 576i, 1080i

Preset display modes

S2419H/S2419HN/S2419NX/S2719H/S2719HN/S2719NX

Display Mode	Horizontal Frequency (kHz)	Vertical Frequency (Hz)	Pixel Clock (MHz)	Sync Polarity (Horizontal / Vertical)
VESA, 720 x 400	31.5	70.1	28.3	-/+
VESA, 640 x 480	31.5	60.0	25.2	-/-
VESA, 640 x 480	37.5	75.0	31.5	-/-
VESA, 800 x 600	37.9	60.3	40.0	+/+
VESA, 800 x 600	46.9	75.0	49.5	+/+
VESA, 1024 x 768	48.4	60.0	65.0	-/-
VESA, 1024 x 768	60.0	75.0	78.8	+/+
VESA, 1152 x 864	67.5	75.0	108.0	+/+
VESA, 1280 x 1024	64.0	60.0	108.0	+/+
VESA, 1280 x 1024	80.0	75.0	135.0	+/+
VESA, 1600 x 900	60.0	60.0	108.0	+/+
VESA, 1600 x 1080	67.5	60.0	148.5	+/+

Electrical specifications

Model		S2419H/S2419HN/S2419NX/S2719H/S2719HN/S2719NX
Video input signals		HDMI 1.4 (HDCP), 600mV for each differential line, 100 ohm input impedance per differential pair
AC/DC Adapter	Input voltage/ frequency/current	Delta adapter ADP-40DD B: 100 VAC to 240 VAC/50 Hz to 60 Hz \pm 3 Hz/1.5 A (Max.). Lite-On adapter PA-1041-81: 100 VAC to 240 VAC/50 Hz to 60 Hz \pm 3 Hz/1.2 A (Max.).
	Output voltage/ current	Output: 12VDC/3.33A
Inrush current		No damage when cold start at 100 VAC~240 VAC

Physical characteristics

Model		S2419H/S2419HN/S2419NX	
Signal cable type		Digital: detachable, HDMI, 19 pins	
Front-frame gloss (minimum)		Black frame - 85 gloss units	
Dimensions (with stand)			
Height		413.4 mm (16.28 in)	
Width		539.0 mm (21.22 in)	
Depth		152.8 mm (6.01 in)	
Dimensions (without stand)			
Height		315.2 mm (12.41 in)	
Width		539.0 mm (21.22 in)	
Depth		47.4 mm (1.87 in)	
Stand dimensions			
Height		171.6 mm (6.76 in)	
Width		249.0 mm (9.80 in)	
Depth		152.8 mm (6.01 in)	
Weight	S2419H	S2419HN/S2419NX	
Weight with packaging	6.02 kg (13.27 lb)	5.81 kg (12.81 lb)	
Weight with stand assembly and cables	4.08 kg (8.99 lb)	3.87 kg (8.53 lb)	
Weight without stand assembly (no cables)	3.09 kg (6.81 lb)	2.88 kg (6.35 lb)	
Weight of stand assembly	0.52 kg (1.15 lb)	0.52 kg (1.15 lb)	

Model	S2719H/S2719HN/S2719NX	
Signal cable type	Digital: detachable, HDMI, 19 pins	
Front-frame gloss (minimum)	Black frame - 85 gloss units	
Dimensions (with stand)		
Height	454.6 mm (17.9 in)	
Width	612.7 mm (24.12 in)	
Depth	186.7 mm (7.35 in)	
Dimensions (without stand)		
Height	356.5 mm (14.04 in)	
Width	612.7 mm (24.12 in)	
Depth	45.8 mm (1.8 in)	
Stand dimensions		
Height	176.7 mm (6.96 in)	
Width	257.2 mm (10.13 in)	
Depth	186.7 mm (7.35 in)	
Weight	S2719H	S2719HN/S2719NX
Weight with packaging	7.86 kg (17.33 lb)	7.65 kg (16.87 lb)
Weight with stand assembly and cables	5.17 kg (11.40 lb)	4.96 kg (10.93 lb)
Weight without stand assembly (no cables)	4.05 kg (8.93 lb)	3.84 kg (8.47 lb)
Weight of stand assembly	0.66 kg (1.46 lb)	0.66 kg (1.46 lb)

Environmental characteristics

Model	S2419H	S2419HN/ S2419NX	S2719H	S2719HN/ S2719NX
Temperature				
Operating	0°C to 40°C (32°F to 104°F)			
Non-operating	<ul style="list-style-type: none"> • Storage: -20°C to 60°C (-4°F to 140°F) • Shipping: -20°C to 60°C (-4°F to 140°F) 			
Humidity				
Operating	10% to 80% (non-condensing)			
Non-operating	<ul style="list-style-type: none"> • Storage 5% to 90% (non-condensing) • Shipping 5% to 90% (non-condensing) 			
Altitude				
Operating (maximum)	5,000 m (16,400 ft)			
Non-operating (maximum)	12,192 m (40,000 ft)			
Thermal dissipation	<ul style="list-style-type: none"> • 112.60 BTU/hour (maximum) • 81.89 BTU/hour (typical) 	<ul style="list-style-type: none"> • 71.65 BTU/hour (maximum) • 61.42 BTU/hour (typical) 	<ul style="list-style-type: none"> • 122.84 BTU/hour (maximum) • 88.72 BTU/hour (typical) 	<ul style="list-style-type: none"> • 81.89 BTU/hour (maximum) • 68.24 BTU/hour (typical)

Power management modes

If you have VESA's DPM compliance display card or software installed in your PC, the monitor can automatically reduce its power consumption when not in use. This is referred to as Power Save Mode*. If the computer detects input from the keyboard, mouse or other input devices, the monitor automatically resumes functioning. The following table shows the power consumption and signaling of this automatic power saving feature.

* Zero power consumption in off mode can only be achieved by disconnecting the power cable from the monitor.

S2419H

VESA Modes	Horizontal Sync	Vertical Sync	Video	Power Indicator	Power Consumption
Normal operation	Active	Active	Active	White	33 W (maximum) 24 W (typical)
Active-off mode	Inactive	Inactive	Blanked	White (Glowing)	Less than 0.3 W
Switch off	-	-	-	Off	Less than 0.3 W

Energy Star		Power Consumption
P _{ON}		17 W
E _{TEC}		53.83 Kwh

S2419HN/S2419NX

VESA Modes	Horizontal Sync	Vertical Sync	Video	Power Indicator	Power Consumption
Normal operation	Active	Active	Active	White	21 W (maximum) 18 W (typical)
Active-off mode	Inactive	Inactive	Blanked	White (Glowing)	Less than 0.3 W
Switch off	-	-	-	Off	Less than 0.3 W

Energy Star		Power Consumption
P _{ON}		17 W
E _{TEC}		53.83 Kwh

S2719H

VESA Modes	Horizontal Sync	Vertical Sync	Video	Power Indicator	Power Consumption
Normal operation	Active	Active	Active	White	36 W (maximum) 26 W (typical)
Active-off mode	Inactive	Inactive	Blanked	White (Glowing)	Less than 0.3 W
Switch off	-	-	-	Off	Less than 0.3 W

Energy Star	Power Consumption
P _{ON}	20 W
E _{TEC}	63.03 Kwh

S2719HN/S2719NX

VESA Modes	Horizontal Sync	Vertical Sync	Video	Power Indicator	Power Consumption
Normal operation	Active	Active	Active	White	24 W (maximum) 20 W (typical)
Active-off mode	Inactive	Inactive	Blanked	White (Glowing)	Less than 0.3 W
Switch off	-	-	-	Off	Less than 0.3 W

Energy Star	Power Consumption
P _{ON}	20 W
E _{TEC}	63.03 Kwh

NOTE:

P_{ON}: Power consumption of on mode as defined in Energy Star 7.0 version.

E_{TEC}: Total energy consumption in KWh as defined in Energy Star 7.0 version.

This document is informational only and reflects laboratory performance. Your product may perform differently, depending on the software, components and peripherals you ordered and shall have no obligation to update such information. Accordingly, the customer should not rely upon this information in making decisions about electrical tolerances or otherwise. No warranty as to accuracy or completeness is expressed or implied.

The OSD functions only in the normal operation mode. When any button is pressed in the Active-off mode, one of the following messages will be displayed:

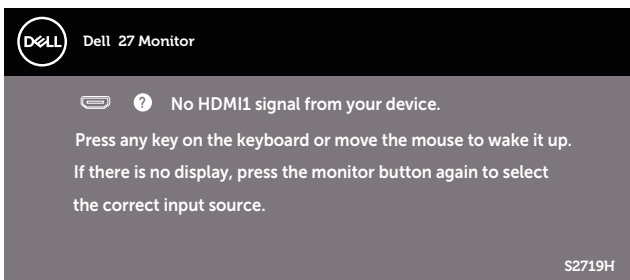
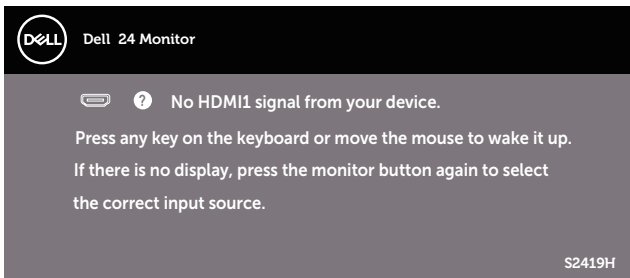

Activate the computer and the monitor to gain access to the OSD.



NOTE: This monitor is **ENERGY STAR** -certified.



Pin assignments

HDMI connector

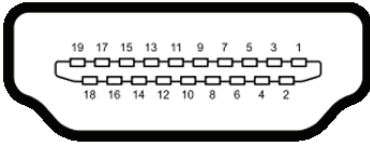

Pin Number	19-pin Side of the Connected Signal Cable
1	TMDS DATA 2+
2	TMDS DATA 2 SHIELD
3	TMDS DATA 2-
4	TMDS DATA 1+
5	TMDS DATA 1 SHIELD
6	TMDS DATA 1-
7	TMDS DATA 0+
8	TMDS DATA 0 SHIELD
9	TMDS DATA 0-
10	TMDS CLOCK+
11	TMDS CLOCK SHIELD
12	TMDS CLOCK-
13	CEC
14	Reserved (N.C. on device)
15	DDC CLOCK (SCL)
16	DDC DATA (SDA)
17	DDC/CEC Ground
18	+5V POWER
19	HOT PLUG DETECT

Plug and play capability

You can install the monitor in any Plug and Play-compatible system. The monitor automatically provides the computer system with its Extended Display Identification Data (EDID) using Display Data Channel (DDC) protocols so the system can configure itself and optimize the monitor settings. Most monitor installations are automatic, you can select different settings if desired. For more information about changing the monitor settings, see [Operating your monitor](#).

LCD monitor quality and pixel policy

During the LCD Monitor manufacturing process, it is not uncommon for one or more pixels to become fixed in an unchanging state which are hard to see and do not affect the display quality or usability. For more information on Dell Monitor Quality and Pixel Policy, see Dell Support site at www.dell.com/support/monitors.

Maintenance guidelines

Cleaning your monitor

 **WARNING:** Before cleaning the monitor, unplug the monitor power cable from the electrical outlet.



 **CAUTION:** Read and follow the [Safety Instructions](#) before cleaning the monitor.

For best practices, follow the instructions in the list below while unpacking, cleaning or handling your monitor:

- To clean your screen, lightly dampen a soft, clean cloth with water. If possible, use a special screen-cleaning tissue or solution suitable for the anti-static coating. Do not use benzene, thinner, ammonia, abrasive cleaners or compressed air.
- Use a lightly-dampened cloth to clean the monitor. Avoid using detergent of any kind as some detergents leave a milky film on the monitor.
- If you notice white powder when you unpack your monitor, wipe it off with a cloth.
- Handle your monitor with care as the black-colored monitor may get scratched and show white scuff marks.
- To help maintain the best image quality on your monitor, use a dynamically changing screen saver and turn Off your monitor when not in use.

Setting up the monitor

Connecting the stand

-  **NOTE:** The stand is detached when the monitor is shipped from the factory.
-  **NOTE:** This is applicable for a monitor with a stand. When any other stand is bought, please refer to the respective stand setup guide for the set up instructions.

To attach the monitor stand:

1. Place the monitor on a soft cloth or cushion.



2. Fit the stand riser and stand base together, and then turn the screw in the stand base.

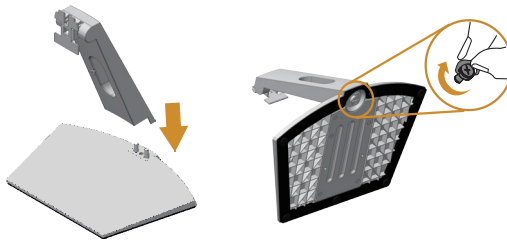

3. Fit the two tabs on the upper part of the stand to the groove on the back of the monitor. Press the stand until it snaps into place.



4. Inserting the stand until the snap locked.



Connecting your monitor

⚠ WARNING: Before you begin any of the procedures in this section, follow the [Safety Instructions](#).

📝 NOTE: Do not connect all cables to the computer at the same time. It is recommend to route the cables through the cable-management slot before you connect them to the monitor.

To connect your monitor to the computer:

1. Turn Off your computer and disconnect the power cable.
2. Connect the audio or HDMI cable from your monitor to the computer.

Connecting the HDMI cable

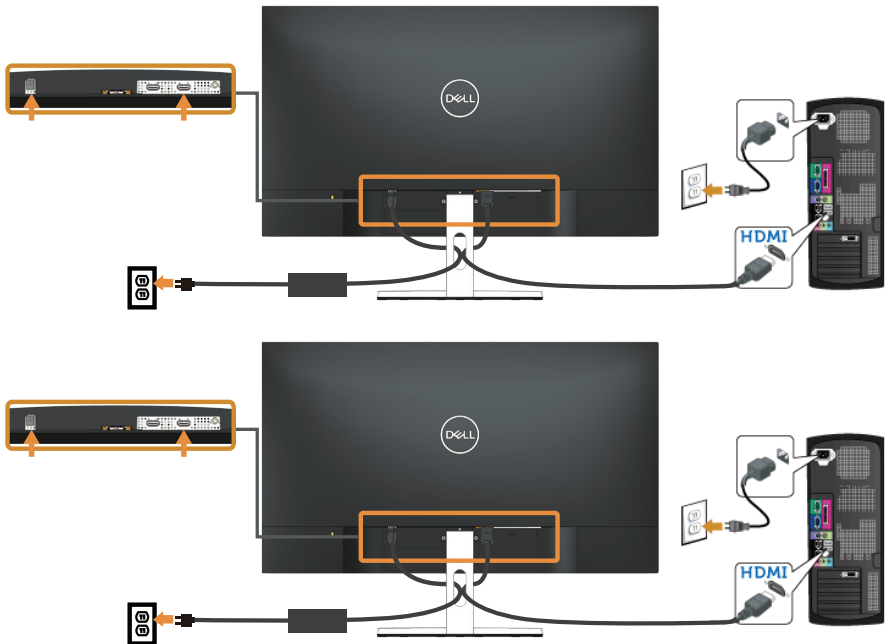

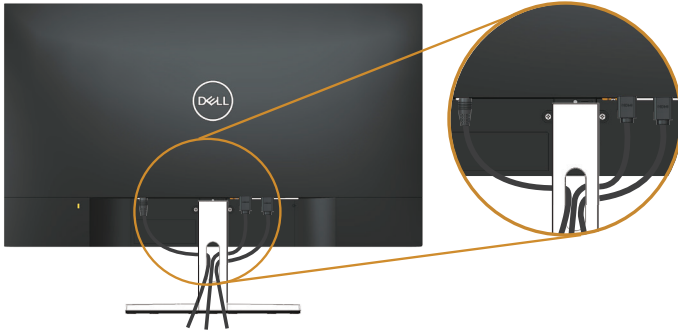

Organizing cables

Use the cable-management slot to organize the cables connected to your monitor.



Removing the stand

-  **NOTE:** To prevent scratches on the LCD screen while removing the stand, ensure that the monitor is placed on a soft and clean surface.
-  **NOTE:** This is applicable for a monitor with a stand. When any other stand is bought, please refer to the respective stand setup guide for the set-up instructions.

To remove the stand:

1. Place the monitor on a soft cloth or cushion along the desk.



2. Tilt the stand downwards to access to the release button.



3. Use a long screwdriver to press on the release button.

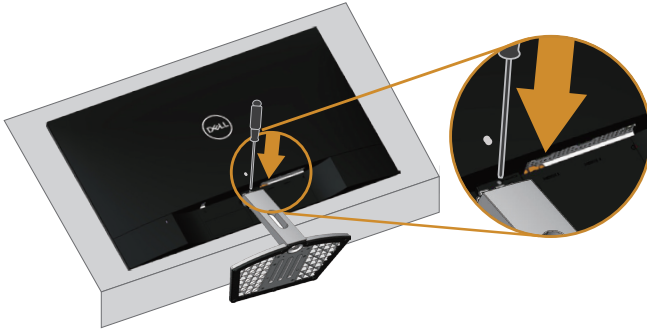

4. While pressing on the release button, pull the stand out.

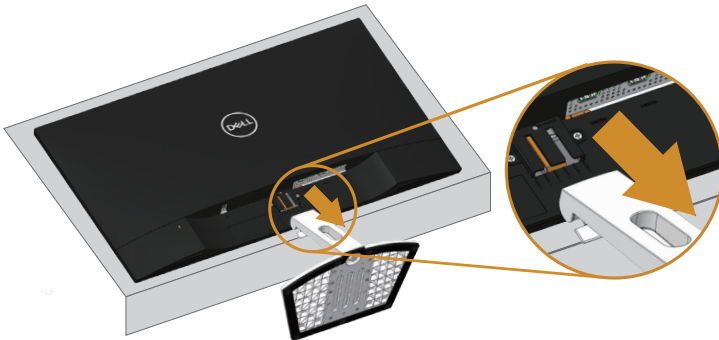

Operating your monitor

Power on the monitor

Press the  button to turn on the monitor.

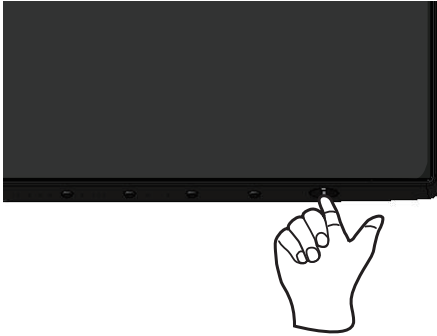

Using the control buttons



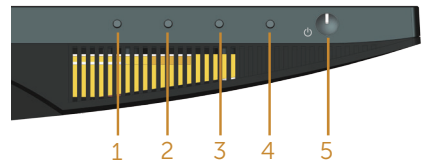
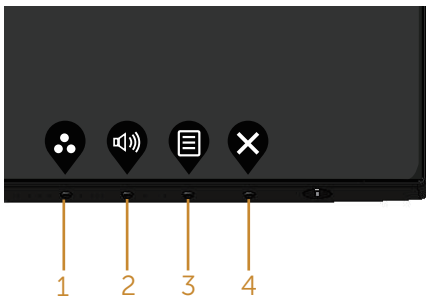

Use the control buttons on the bottom of the monitor to adjust the image being displayed.



Control buttons

The following table describes the control buttons:





Control Buttons	Description
1  Shortcut key/Preset Modes	Use this button to choose from a list of preset modes.

2		Use the buttons to adjust the volume. Minimum is '0' (-). Maximum is '100' (+).
	Shortcut key/Input Source	
3		Use the Menu button to launch the On-Screen Display (OSD) and select the OSD Menu. See Accessing the OSD menu .
4		Use this button to go back to the main menu or exit the OSD main menu.
	Exit	
5		Use the Power button to turn the monitor on and off.
	Power On/Off button (with LED indicator)	Solid white light indicates the monitor is On and fully functional. Blinking white light indicates the power save mode.

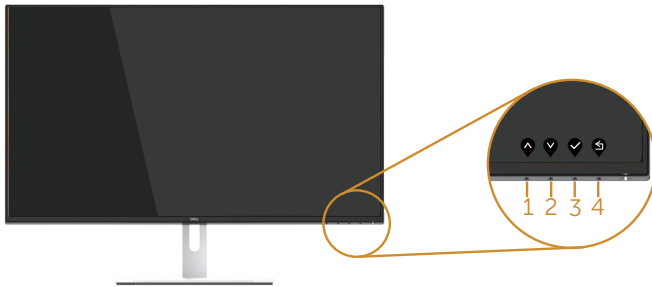
OSD controls

Use the buttons on the bottom of the monitor to adjust the image settings.



Control Buttons	Description
1  Up	Use the Up button to increase values or move up in a menu.
2  Down	Use the Down button to decrease values or move down in a menu.
3  OK	Use the OK button to confirm your selection in a menu.
4  Back	Use the Back button to go back to the previous menu.

Using the on-screen display (OSD) menu







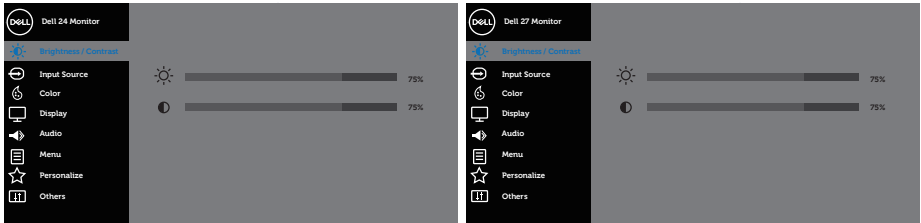

Accessing the OSD menu











 **NOTE:** Any changes you make are automatically saved when you move to another menu, exit the OSD menu, or wait for the OSD menu to automatically close.

1. Press the  button to display the OSD main menu.

Main Menu for HDMI input

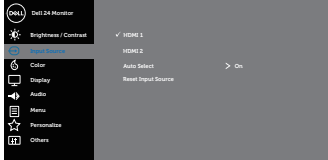
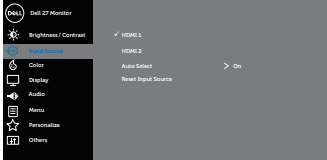

2. Press the  and  buttons to move between the setting options. As you move from one icon to another, the option name is highlighted. See the following table for a complete list of all the options available for the monitor.
3. Press the  button once to activate the highlighted option.
4. Press  and  button to select the desired parameter.
5. Press  and then use the  and  buttons, according to the indicators on the menu, to make your changes.
6. Select the  button to return to the main menu.

Icon	Menu and Submenus	Description
	Brightness/ Contrast	Use this menu to activate brightness/contrast adjustment.  
	Brightness	Brightness adjusts the luminance of the backlight. Press the  button to increase the brightness and press the  button to decrease the brightness (min. 0 / max. 100). NOTE: Manual adjustment of brightness is disabled when dynamic contrast is switched on.
	Contrast	Adjust the brightness first, and then adjust the contrast only if further adjustment is necessary. Press the  button to increase the contrast and press the  button to decrease the contrast (min. 0 / max. 100). The contrast function adjusts the degree of difference between darkness and lightness on the monitor screen.
	Input Source	Use the input source menu to select between the different video signals that may be connected to your monitor.  
	HDMI 1	Select HDMI 1 input when you are using the HDMI1 connector. Push  to select the HDMI 1 input source.
	HDMI 2	Select HDMI 2 input when you are using the HDMI2 connector. Push  to select the HDMI 2 input source.
	Auto Select	Select auto select to scan for available input signals.
	Reset Input Source	Select this option to restore default Input Source.



Color

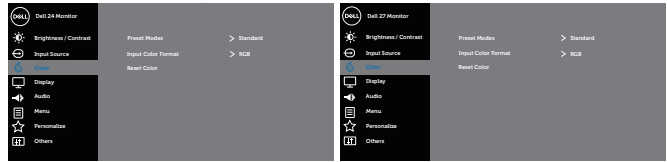

Use color to adjust the color setting mode.









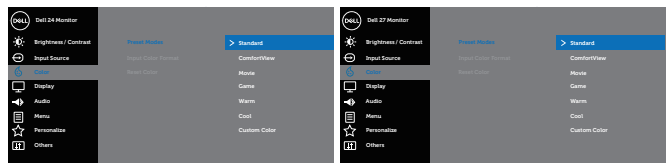

Preset Modes

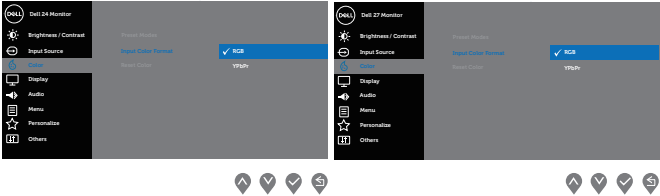







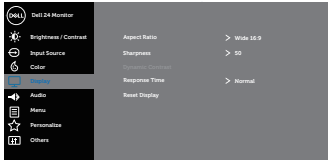

When you select preset modes, you can choose Standard, ComfortView, Movie, Game, Warm, Cool or Custom Color from the list.





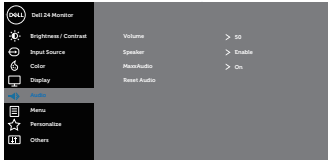
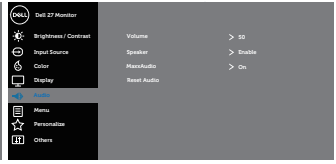

- **Standard:** Loads the monitor's default color settings. This is the default preset mode.
- **ComfortView:** Decreases the level of blue light emitted from the screen to make viewing more comfortable for your eyes.
- **Movie:** Loads color settings ideal for movies.
- **Game:** Loads color settings ideal for most gaming applications.
- **Warm:** Increases the color temperature. The screen appears warmer with a red/yellow tint.
- **Cool:** Decreases the color temperature. The screen appears cooler with a blue tint.
- **Custom Color:** Allows you to manually adjust the color settings.

Press the  and  buttons to adjust the three colors (R, G, B) values and create your own preset color mode.

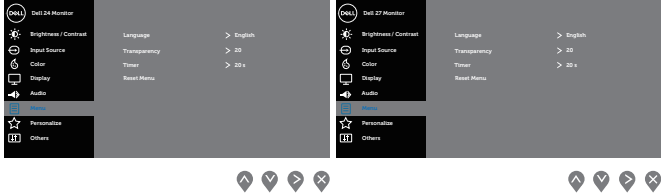

<p>Input Color Format</p>	<p>Allows you to set the video input mode to:</p> <ul style="list-style-type: none"> • RGB: Select this option if your monitor is connected to a computer or DVD player using the HDMI cable. • YPbPr: Select this option if your DVD player supports only YPbPr output. 
<p>Hue</p>	<p>This feature can shift the color of the video image to green or purple. This is used to adjust the desired flesh tone color. Use  or  to adjust the hue from 0 to 100.</p> <p>Press  to increase the green shade of the video image.</p> <p>Press  to increase the purple shade of the video image.</p> <p>NOTE: Hue adjustment is available only when you select Movie or Game preset mode.</p>
<p>Saturation</p>	<p>This feature can adjust the color saturation of the video image. Use  or  to adjust the saturation from 0 to 100.</p> <p>Press  to increase the monochrome appearance of the video image.</p> <p>Press  to increase the colorful appearance of the video image.</p> <p>NOTE: Saturation adjustment is available only when you select movie or game preset mode.</p>
<p>Reset Color</p>	<p>Allows your monitor color settings to the factory settings.</p>

	Display	<p>Use the display to adjust image.</p>   <p style="text-align: center;">   </p>
	Aspect Ratio	Adjusts the image ratio to Wide 16:9, 4:3 or 5:4.
	Sharpness	This feature can make the image look sharper or softer. Use  or  to adjust the sharpness from 0 to 100.
	Dynamic Contrast	Allows you to increase the level of contrast to provide sharper and more detailed image quality. Press the  button to select the dynamic contrast on or off. NOTE: Dynamic contrast provides higher contrast if you select game or movie preset mode.
	Response Time	User can select between Normal, Fast or Super fast.
	Reset Display	Select this option to restore default display settings.
	Audio	  <p style="text-align: center;">   </p>
	Volume	Use the buttons to adjust the volume. Minimum is '0' (-). Maximum is '100' (+).
	Speaker	Allows you to enable or disable speaker function.
	MaxxAudio	MaxxAudio is a suite of advanced audio enhancement tools. This item is to define the action which is used to On/Off MaxxAudio.
	Reset Audio	Select this option to restore default display settings.

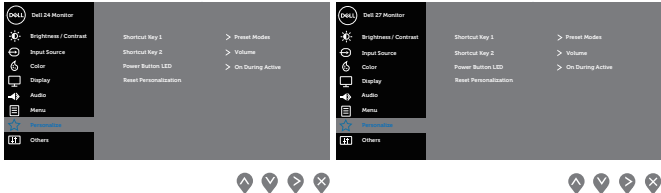
	<p>Menu</p>	<p>Select this option to adjust the settings of the OSD, such as, the languages of the OSD, the amount of time the menu remains on screen and so on.</p> 
	<p>Language</p>	<p>Language options set the OSD display to one of the eight languages (English, Spanish, French, German, Brazilian Portuguese, Russian, Simplified Chinese, or Japanese).</p>
	<p>Transparency</p>	<p>Select this option to change the menu transparency by pressing the  or  buttons from 0 to 100.</p>
	<p>Timer</p>	<p>OSD hold time: sets the length of time the OSD will remain active after the last time you pressed a button.</p> <p>Use  or  to adjust the slider in 1 second increments, from 5 to 60 seconds.</p>
	<p>Reset Menu</p>	<p>Reset all OSD settings to the factory preset values.</p>
	<p>Personalize</p>	<p>Users can choose a feature from Shortcut key 1, Shortcut key 2, Power Button LED or Reset Personalization, Preset Modes or Volume and set it as a shortcut key.</p> 
	<p>Shortcut Key 1</p>	<p>User can select one of the following: Preset Modes, Brightness/Contrast, Input Source, Aspect Ratio, Volume to set the shortcut key 1.</p>
	<p>Shortcut Key 2</p>	<p>User can select one of the following: Preset Modes, Brightness/Contrast, Input Source, Aspect Ratio, Volume to set the shortcut key 2.</p>
	<p>Power Button LED</p>	<p>Allows you to set the power LED indicator On During Active or Off During Active to save energy.</p>
	<p>Reset Personalization</p>	<p>Allows you to restore shortcut key to the default setting.</p>



Others

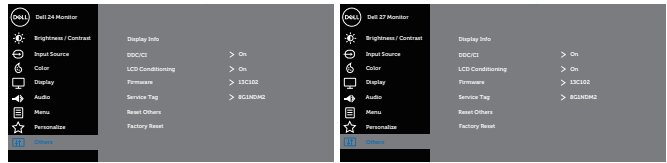

Display Info

Press to display the information about the display.

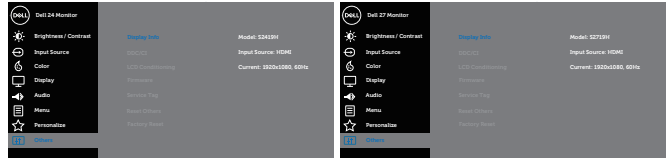

DDC/CI

DDC/CI (display data channel/command interface) allows your monitor parameters (brightness, color balance and etc..) to be adjustable via the software on your computer.

You can disable this feature by selecting disable.

Enable this feature for best user experience and optimum performance of your monitor.

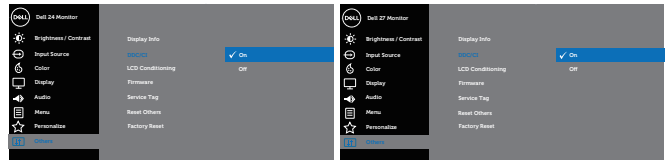

LCD Conditioning

Helps reduce minor cases of image retention. Depending on the degree of image retention, the program may take some time to run. To start LCD conditioning, select **Off**.

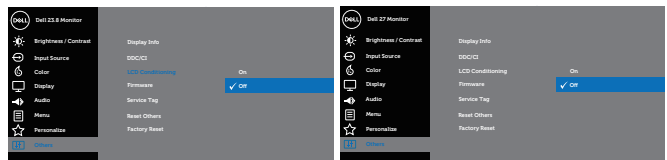

Firmware

Display the version of the firmware about the display.

Service Tag

Display the service tag number of the display.

Reset Other

Reset all settings under the **Others** setting menu to the factory preset values.

Factory Reset

Reset all settings to the factory preset values.

 **NOTE:** Your monitor has a built-in feature to automatically calibrate the brightness to compensate for LED aging.

OSD warning messages

When the **Dynamic Contrast** feature is enabled (in these preset modes: **Game** or **Movie**), the manual brightness adjustment is disabled.

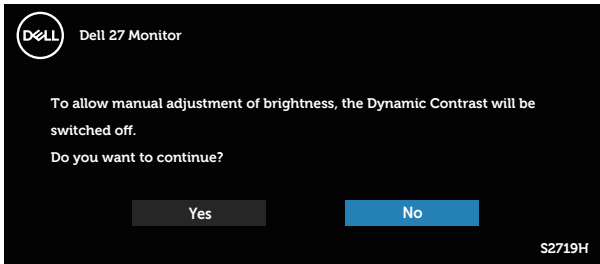
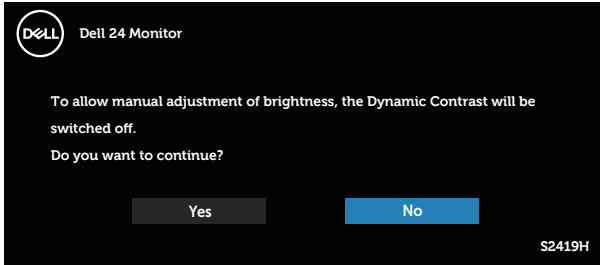

Before the **DDC/CI** function is disabled, the following message is displayed:

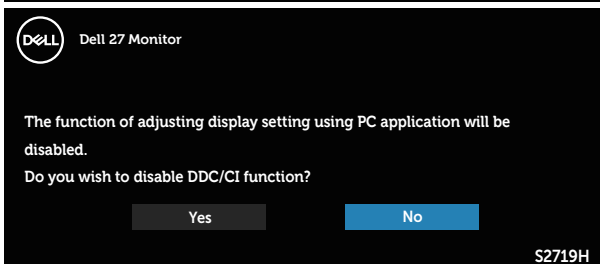
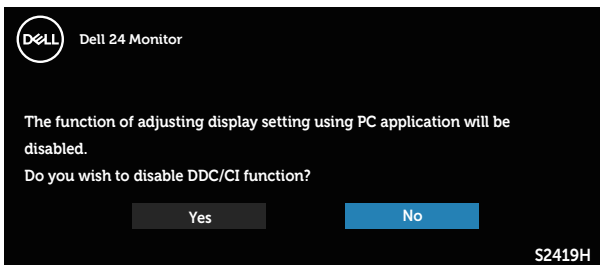

When the monitor enters the **Power Save Mode**, the following message appears:

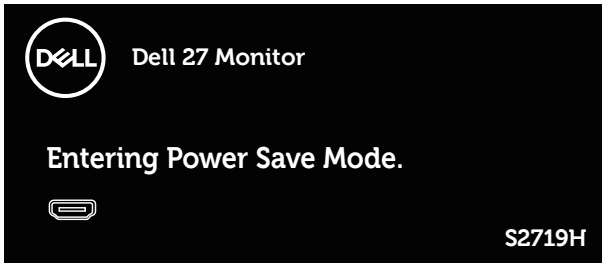
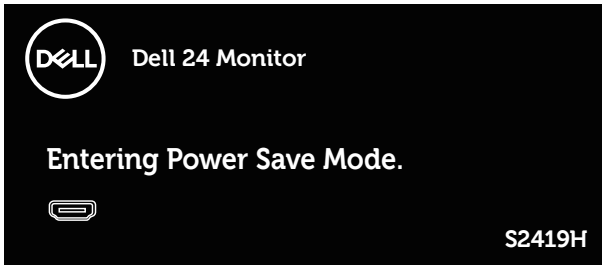

If HDMI cable is not connected, a floating dialog box as shown below appears. The monitor will enter Power Save Mode after 4 minutes if left at this state.

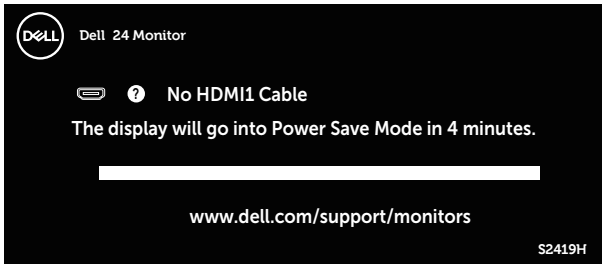

See [Troubleshooting](#) for more information.

Setting up your monitor

Setting the maximum resolution

To set the maximum resolution for the monitor:

In Windows 7, Windows 8, Windows 8.1 and Windows 10:

1. For Windows 8 and Windows 8.1, select the Desktop tile to switch to classic desktop.
2. Right-click on the desktop and click **Screen Resolution**.
3. Click the Dropdown list of the Screen Resolution and select **1920 x 1080**.
4. Click **OK**.

If you do not see 1920 x 1080 as an option, you may need to update your graphics driver. Depending on your computer, complete one of the following procedures:

If you have a Dell desktop or portable computer:

- Go to www.dell.com/support, enter your computer's Service Tag, and download the latest driver for your graphics card.

If you are using a non-Dell computer (portable or desktop):

- Go to the support site for your computer and download the latest graphic drivers.
- Go to your graphics card website and download the latest graphic drivers.

If you have a Dell desktop or a Dell portable computer with internet access

1. Go to www.dell.com/support, enter your service tag, and download the latest driver for your graphics card.
2. After installing the drivers for your graphics adapter, attempt to set the resolution to **1920 x 1080** again.



NOTE: If you are unable to set the resolution to **1920 x 1080**, please contact Dell to inquire about a graphics adapter that supports these resolutions.

If you have a non Dell desktop, portable computer, or graphics card

In Windows 7, Windows 8, Windows 8.1 and Windows 10:

1. For Windows 8 and Windows 8.1 only, select the Desktop tile to switch to classic desktop.
2. Right-click on the desktop and click **Personalization**.
3. Click **Change Display Settings**.
4. Click **Advanced Settings**.
5. Identify your graphics controller supplier from the description at the top of the window (e.g. NVIDIA, ATI, Intel etc.).
6. Refer to the graphic card provider website for updated driver (for example, <http://www.ATI.com> OR <http://www.AMD.com>).
7. After installing the drivers for your graphics adapter, attempt to set the resolution to **1920 x 1080** again.

Using tilt

 **NOTE:** The stand is detached when the monitor is shipped from the factory.

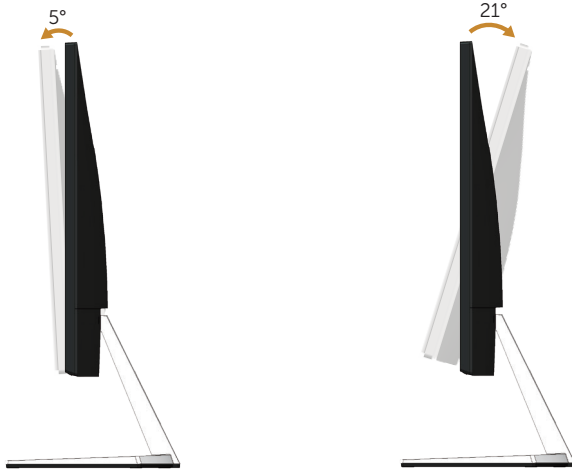

Troubleshooting

⚠ WARNING: Before you begin any of the procedures in this section, follow the [Safety Instructions](#).

Self-Test

Your monitor provides a self-test feature that allows you to check if your monitor is functioning properly. If your monitor and computer are properly connected but the monitor screen remains dark, run the monitor self-test by performing the following steps:

1. Turn off both your computer and the monitor.
2. Disconnect all video cables from the monitor. This way, the computer doesn't have to be involved.
3. Turn on the monitor.

If the monitor is working correctly, it detects that there is no signal and one of the following message appears. While in self-test mode, the power LED remains white.

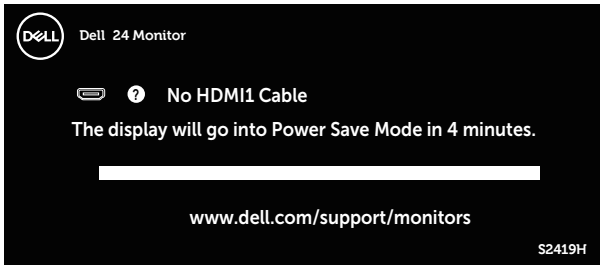

✍ NOTE: This box also appears during normal system operation, if the video cable is disconnected or damaged.

4. Turn Off your monitor and reconnect the video cable; then turn on your computer and the monitor.

If your monitor remains dark after you reconnect the cables, check your video controller and computer.

Built-in diagnostics

Your monitor has a built-in diagnostic tool that helps you determine if any screen abnormality you experience is an inherent problem with your monitor, or with your computer and video card.

 **NOTE:** You can run the built-in diagnostics only when the video cable is unplugged and the monitor is in self-test mode.

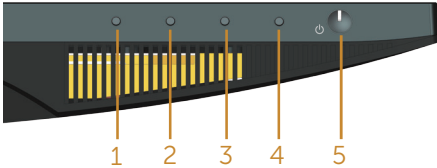

To run the built-in diagnostics:

1. Ensure that the screen is clean (no dust particles on the surface of the screen).
2. Unplug the video cable(s) from the back of the computer or monitor. The monitor then goes into the self-test mode.
3. Press and hold Button 1 for 5 seconds. A gray screen appears.
4. Carefully inspect the screen for abnormalities.
5. Press Button 1 on the bottom of the monitor again. The color of the screen changes to red.
6. Inspect the display for any abnormalities.
7. Repeat steps 5 and 6 to inspect the display in green, blue, black, white and text screens.

The test is complete when the text screen appears. To exit, press Button 1 again.

If you do not detect any screen abnormalities upon using the built-in diagnostic tool, the monitor is functioning properly. Check the video card and computer.

Common problems

The following table contains general information about common monitor problems you might encounter and the possible solutions:

Common Symptoms	Possible Solutions
No Video/Power LED off	<ul style="list-style-type: none">• Ensure that the video cable connecting the monitor and the computer is properly connected and secure.• Verify that the power outlet is functioning properly using any other electrical equipment.• Ensure that the power button is pressed.• Ensure that the correct input source is selected via the Input Source menu.
No Video/Power LED on	<ul style="list-style-type: none">• Increase brightness and contrast controls using the OSD.• Perform monitor self-test feature check.• Check for bent or broken pins in the video cable connector.• Run the built-in diagnostics.• Ensure that the correct input source is selected via the Input Source menu.
Poor Focus	<ul style="list-style-type: none">• Eliminate video extension cables.• Reset the monitor to Factory Settings (Factory Reset).• Change the video resolution to the correct aspect ratio.
Shaky/Jittery Video	<ul style="list-style-type: none">• Reset the monitor to Factory Settings (Factory Reset).• Check environmental factors.• Relocate the monitor and test in another room.
Missing Pixels	<ul style="list-style-type: none">• Cycle power On-Off.• Pixel that is permanently Off is a natural defect that can occur in LCD technology.• For more information on Dell Monitor Quality and Pixel Policy, see Dell Support site at: www.dell.com/support/monitors.
Stuck-on Pixels	<ul style="list-style-type: none">• Cycle power On-Off.• Pixel that is permanently off is a natural defect that can occur in LCD technology.• For more information on Dell Monitor Quality and Pixel Policy, see Dell Support site at: www.dell.com/support/monitors.
Brightness Problems	<ul style="list-style-type: none">• Reset the monitor to Factory Settings (Factory Reset).• Adjust brightness & contrast controls via OSD.
Geometric Distortion	<ul style="list-style-type: none">• Reset the monitor to Factory Settings (Factory Reset).• Adjust horizontal & vertical controls via OSD.
Horizontal/Vertical Lines	<ul style="list-style-type: none">• Reset the monitor to Factory Settings (Factory Reset).• Perform monitor self-test feature check and determine if these lines are also in self-test mode.• Check for bent or broken pins in the video cable connector.• Run the built-in diagnostics.

Synchronization Problems	<ul style="list-style-type: none"> ● Reset the monitor to Factory Settings (Factory Reset). ● Perform monitor self-test feature check to determine if the scrambled screen appears in self-test mode. ● Check for bent or broken pins in the video cable connector. ● Restart the computer in the <i>safe mode</i>.
Safety Related Issues	<ul style="list-style-type: none"> ● Do not perform any troubleshooting steps. ● Contact Dell immediately.
Intermittent Problems	<ul style="list-style-type: none"> ● Ensure that the video cable connecting the monitor to the computer is connected properly and is secure. ● Reset the monitor to Factory Settings (Factory Reset). ● Perform monitor self-test feature check to determine if the intermittent problem occurs in self-test mode.
Missing Color	<ul style="list-style-type: none"> ● Perform monitor self-test feature check. ● Ensure that the video cable connecting the monitor to the computer is connected properly and is secure. ● Check for bent or broken pins in the video cable connector.
Wrong Color	<ul style="list-style-type: none"> ● Change the Color Setting Mode in the Color Settings OSD to Graphics or Video depending on the application. ● Try different Preset Modes in Color settings OSD. Adjust R/G/B value in Custom Color in Color settings OSD. ● Change the Input Color Format to RGB or YPbPr in the Color settings OSD. ● Run the built-in diagnostics.
Image retention from a static image left on the monitor for a long period of time	<ul style="list-style-type: none"> ● Use the Power Management feature to turn off the monitor at all times when not in use (for more information, see Power management modes). ● Alternatively, use a dynamically changing screensaver.
Video Ghosting or Overshooting	<ul style="list-style-type: none"> ● Change the Response Time in the Display OSD to Fast or Normal depending on your application and usage.

Product-specific problems

Specific Symptoms	Possible Solutions
Screen image is too small	<ul style="list-style-type: none">• Check the Aspect Ratio setting in the Display settings OSD.• Reset the monitor to Factory Settings (Factory Reset).
Cannot adjust the monitor with the buttons on the bottom of the panel	<ul style="list-style-type: none">• Turn Off the monitor, unplug the power cord, plug it back, and then turn On the monitor.• Check if the OSD menu is locked. If yes, press and hold the menu button for 10 seconds to unlock. (For more information, see Lock).
No Input Signal when user controls are pressed	<ul style="list-style-type: none">• Check the signal source. Ensure the computer is not in standby or sleep mode by moving the mouse or pressing any key on the keyboard.• Check if the video cable is plugged in properly. Disconnect and reconnect the video cable if necessary.• Reset the computer or video player.
The picture does not fill the entire screen	<ul style="list-style-type: none">• Due to different video formats (aspect ratio) of DVDs, the monitor may display in full screen.• Run the built-in diagnostics.

Appendix

WARNING: Safety Instructions

 **WARNING: Use of controls, adjustments, or procedures other than those specified in this documentation may result in exposure to shock, electrical hazards, and/or mechanical hazards.**

For information on safety instructions, see the *Product Information Guide*.

FCC notices (U.S. Only) and other regulatory information

For FCC notices and other regulatory information, see the regulatory compliance website located at www.dell.com/regulatory_compliance.

Contacting Dell

For customers in the United States, call 800-WWW-DELL (800-999-3355).

 **NOTE:** If you do not have an active Internet connection, you can find contact information on your purchase invoice, packing slip, bill, or Dell product catalog.

Dell provides several online and telephone-based support and service options. Availability varies by country and product, and some services may not be available in your area.

To get online Monitor support content:

1. Visit www.dell.com/support/monitors.

To contact Dell for sales, technical support, or customer service issues:

1. Visit www.dell.com/support.
2. Verify your country or region in the **Choose A Country/Region** drop-down menu at the bottom of the page.
3. Click **Contact Us** on the left side of the page.
4. Select the appropriate service or support link based on your need.
5. Choose the method of contacting Dell that is convenient for you.

 **WARNING: For displays with glossy bezels the user should consider the placement of the display as the bezel may cause disturbing reflections from surrounding light and bright surfaces.**

Free Manuals Download Website

<http://myh66.com>

<http://usermanuals.us>

<http://www.somanuals.com>

<http://www.4manuals.cc>

<http://www.manual-lib.com>

<http://www.404manual.com>

<http://www.luxmanual.com>

<http://aubethermostatmanual.com>

Golf course search by state

<http://golfingnear.com>

Email search by domain

<http://emailbydomain.com>

Auto manuals search

<http://auto.somanuals.com>

TV manuals search

<http://tv.somanuals.com>