

jWIN

Headset with *Bluetooth*[®] Wireless
Technology



**Instruction Manual
JB-TH220**

Please read this manual carefully before operating and save it
for future reference.

Have a question? Please visit <http://www.jWIN.com>

USER SAFETY GUIDE

INSTRUCTIONS ON ENVIRONMENT PROTECTION

Do not dispose of this product in the usual household garbage at the end of its life cycle; bring it to a collection point for the recycling of electrical and electronic appliances.

This symbol on the product means the instructions for use or the packaging will inform about the methods of disposal. The materials are recyclable as mentioned in its marking. By recycling, material recycling, and other forms of re-utilization of old appliances, you make an important contribution to the protection of the environment. Please inquire at your local community administration for an authorized disposal location.



Important Safety Instructions

1. **Read instructions** – All safety and operating instructions should be read before the appliance is operated.
2. **Retain instructions** – The safety and operating instructions should be retained in a secure place for future reference.
3. **Heed warnings** – All warnings on the appliance and in the operating instructions should be observed.
4. **Follow instructions** – All operating and use instructions should be followed.
5. **Water and moisture** – The appliance should not be used near water (bathtub, kitchen sink, laundry tub, pool, etc.).
6. **Heat** – The appliance should be situated away from heat

USER SAFETY GUIDE

Important Safety Instructions-Continued

sources such as radiators, heat registers, stoves, or other appliances (including amplifiers) that produce heat.

- 7. Power sources** – The appliance should be connected to a power supply only of the type described in the operating instructions or as marked on the appliance.
- 8. Cleaning** – The appliance should be cleaned with a dry cloth.
- 9. Objects and liquids entry** – Care should be taken so that objects do not fall and liquids are not spilled into the device's openings.
- 10. Servicing** – The user should not attempt to service the appliance beyond that described in the user's operating instructions. All other servicing should be referred to qualified service professional.

FCC Notice (USA)

This device complies with Part 15 of the FCC Rules. Operation is subject to the following two conditions: (1) this device may not cause harmful interference, and (2) this device must accept any interference received, including interference that may cause undesired operation. Refer to 47 CFR Sec. 15.19.

This equipment has been tested and found to comply with the limits for a Class B digital device, pursuant to Part 15 of the FCC Rules. These limits are designed to provide reasonable protection against harmful interference in a residential installation. This equipment generates, uses, and can radiate radio frequency energy and, if not installed and used in accordance with the instructions, may cause harmful interference to radio

USER SAFETY GUIDE

FCC Notice (USA)-Continued

communications, which can be determined by turning the equipment off and on, the user is encouraged to try to correct the interference by one or more of the following measures:

- Reorient or relocate the receiving antenna.
- Increase the separation between the equipment and receiver.
- Connect the equipment into an outlet on a circuit different from that to which the receiver is connected.
- Consult the dealer or an experienced radio/TV technician for help.

NOTE: Changes or modifications not expressly approved by the party responsible for compliance could void the user's authority to operate the equipment. Refer to 47 CFR Sec. 15.21.

Industry Canada Notice to Canadian Users

Operation is subject to the following two conditions: (1) this device may not cause harmful interference, and (2) this device must accept any interference received, including interference that may cause undesired operation of the device. Refer to IC RSS 210 Sec. 5.11. The term "IC" before the certification or registration number only means that the registration was performed based on a Declaration of Conformity and that Industry Canada technical specifications were met. It does not imply that Industry Canada (IC) approved this equipment. Refer to Self-Marking 6(f) and RSP 100 Sec. 4.

USER SAFETY GUIDE

Additional Safety Instructions

- When not in use, keep your device in a safe place where it will not be bent or crushed.
- Keep this device away from children. Some small and detachable parts might be swallowed by children and result in harm to them.

About Electromagnetic Interference (EMI)

This device is designed and manufactured not to exceed the exposure limit for radio frequency energy, which is set by the Federal Communications Commission of the U.S government.

The term "EMI" is short for the electromagnetic interference caused by the electromagnetic field generated by electronic devices. In fact, most electrical appliances and devices emit electric and magnetic fields, and most of modern electronic devices are susceptible to the EMI if they are inadequately shielded or designed.

- If you use any personal medical device, such as a pacemaker, please consult the manufacture of your medical device to determine if it is adequately shielded from EMI. Your physician might assist you in obtaining this information.
- Please turn off this device if you are instructed to do so, especially on an airplane or in a hospital.
- Please keep away from medical instruments in a hospital or medical unit while using this device.

USER SAFETY GUIDE

IMPORTANT NOTES ON HEARING

Your hearing is very important to you and to us. We strongly recommend you to follow the guideline below in order to prevent possible damage to or loss of hearing.

Hearing experts caution that listening to loud sounds can damage hearing over time. With continuous listening to loud sounds, hearing adapts and will give the impression that volume has reduced. What seems normal may, in fact, be harmful. To guard against this before hearing adapts, set the volume at a low level and slowly increase the volume level until sound can be heard comfortably and clearly without distortion. Damage to hearing is accumulative and is irreversible. Ringing or discomfort in the ears indicates that the volume is too loud. Once a comfortable listening level has been established, do not increase the volume level further.

CAUTION!

If you experience a ringing sound in your ear, lower the volume or discontinue the use of this product.

TABLE OF CONTENTS

GETTING STARTED

Introduction.....	8
What's Included in the Package.....	8
What is <i>Bluetooth</i> wireless technology?	9
Location of Controls.....	10
Charging the Headset.....	10
Turning on the Headset.....	11
Turning off the Headset.....	11
Pairing the Headset using <i>Bluetooth</i> Wireless Technology.....	12

OPERATING INSTRUCTIONS

Making a call.....	14
Answering a call.....	15
Ending a call.....	15
Rejecting an Incoming Call.....	16
Transferring Calls between Devices.....	16
Adjusting the Volume.....	16

TROUBLESHOOTING GUIDE

Questions and answers about the product.....	17
--	----

SPECIFICATIONS

Technical information about the product.....	17
--	----

GETTING STARTED

Headset with *Bluetooth* Wireless Technology

Thank you for purchasing the JB-TH220. This headset has been designed wireless mobile phone connection using *Bluetooth* wireless technology. Please keep this manual in a safe place for future reference.

- Answer mobile phone calls hands free
- Supports the headset (HSP), hands-free (HFP) profiles
- Standby time up to 170 hours
- Continuous talking time up to 6 hours
- Communication range up to 33ft
- Compliant with *Bluetooth* wireless technology V2.0 and EDR

What's included in the package?

- Headset
- Charger
- USB charging cable
- Instruction manual
- Warranty card



GETTING STARTED

What is *Bluetooth* wireless technology?

Bluetooth wireless technology is a short-range wireless communication technology intended to replace the cables connecting electronic devices while maintaining the high level of security. With *Bluetooth* wireless technology, two devices can be connected at the same time without the need to face each other or the concern of interference from other wireless communication within its optimum range of 33 feet.

Through a process called "Pairing," two or more devices with *Bluetooth* wireless technology can interact with each other without interference from other wireless platforms nearby, including other *Bluetooth* wireless communications between unrelated devices.

GETTING STARTED

LOCATION OF CONTROLS

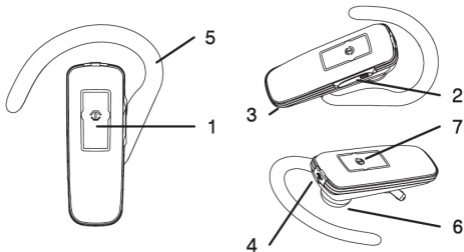

- | | |
|--------------------------|----------------------|
| 1. Multi-function button | 5. Ear clip |
| 2. Volume +/- button | 6. Earpiece/receiver |
| 3. Microphone | 7. LED indicator |
| 4. Charging port | |

Charging the Headset

Fully charge the headset by connecting the charger to the mini-USB port on the top of the headset. The red indicator will light up when charging. Once fully charged, the red indicator will go out.

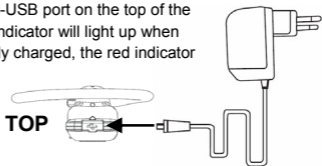

GETTING STARTED

Turning on the Headset

Press and hold the **Multi-function** button for approximately three (3) seconds until the blue indicator light begins flashing.

Note: The blue indicator will continuously flash when the power is on.



Turning off the Headset

Press and hold the **Multi-function** button for approximately five (5) seconds until the red indicator flashes briefly.

Note: No light will flash when the power is off.

GETTING STARTED

Pairing the headset with mobile phones using *Bluetooth* wireless technology

1. With the power turned off, press and hold the **Multi-function** button for approximately 3 to 5 seconds. Blue and Red lights will blink alternatively.
2. Set both the JB-TH220 and the mobile phone to **SEARCH** mode following the pairing instructions included with the phone, placing both units close together. Typically mobile phones have a *Bluetooth* menu from which **SEARCH** can be selected.



3. The mobile phone with *Bluetooth* wireless technology will identify the Headset.

4. Confirm with "yes," or "ok."

5. When asked for a passkey or PIN, enter **0000** (4 zeros) and press "yes," or "ok."



6. Phone and headset have successfully paired.

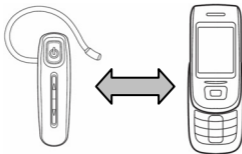

GETTING STARTED

Notes on Pairing

This headset will not be recognized by your mobile phone unless it is properly paired. The JB-TH220 cannot pair with mobile phones which are not equipped with *Bluetooth* wireless technology. To ensure that correct pairing is accomplished, it is important to follow both these instructions and those which accompany the corresponding mobile phone.

Wearing the Headset

The JB-TH220 can be worn on either the left or right ear.

1. Place the ear hook over the right ear with earpiece in the ear.



2. For placement in the left ear, lift the ear hook as shown.

3. Rotate the ear hook on the swivel.



4. The JB-TH220 can now be worn comfortably on the left ear.

OPERATING INSTRUCTIONS

Making a Call

This headset must also be paired with your phone, enabled by *Bluetooth* wireless technology in order to make a call.

- Normal dialing:**
 - Dial the telephone number on your mobile phone.
 - When the call connects, it will be heard through the headset.
- Last number redial:** After a call has been made, the number can be redialed by short-pressing the **Multi-function** button two (2) times.
- Voice dial function:** If your mobile phone supports voice dialing, set up voice tags using the instructions for your phone. For the best connection with JB-TH220, pair and use this unit when establishing voice tags.
 - Press and hold the **Multi-function** button for approximately three (3) seconds.
 - Say the name of the person you wish to call.
 - The number of the selected person will dial and be connected.



Touch

OPERATING INSTRUCTIONS

Answering a Call

Be certain the headset is properly paired with a mobile phone featuring *Bluetooth* wireless technology before answering a call.

1. An incoming phone call will be indicated by a ring. Press the **Multi-function** button **once** to answer the call.
2. If the headset is off when there is an incoming call, press the **Multi-function** button to turn on the headset and answer the call as usual.

Notes on Answering a Call

- When there is an incoming call, some phones might not ring when paired with JB-TH220, but there will be a **beeping** sound from the headset. Press the **Multi-function** button to answer the phone when you hear this beep.
- Similarly, some phones may not send an incoming call signal to the headset. Press the **Multi-function** button when the phone rings.

Ending a Call

There are several ways to end a phone call.

1. Press the **Multi-function** button on the headset.
2. Press the **End** key on the mobile phone.
3. A call will also end as the person on the other end hangs up.

Note: Your mobile phone with *Bluetooth* wireless technology must be paired with the JB-TH220 BEFORE these functions are attempted.

OPERATING INSTRUCTIONS

Rejecting an Incoming Call

When there is an incoming call, press and hold the **Multi-function** button for approximately 3 to 5 seconds and release to reject the call.

Transferring Calls between Devices

1. To transfer a current call to your mobile phone when using the JB-TH220, press the **Multi-function** button for three (3) seconds. The call will no longer be communicated through the JB-TH220. Use your mobile phone as normal.
2. To transfer a current call to the JB-TH220 when using your mobile phone, press the **Multi-function** button for 3 seconds. The call will now be communicated through the headset.

Adjusting the Volume

1. To adjust the volume, press the **Volume Up (▲)** or **Volume Down (▼)** button.
2. Press and hold the **Volume Up (▲)** or **Volume Down (▼)** buttons to adjust the sound level continuously

TROUBLESHOOTING GUIDE

1. The headset does not work with my mobile phone.

Be certain that your mobile phone is equipped with *Bluetooth* wireless technology. This headset will only work with such mobile phones. Additionally, your mobile phone must be paired with the headset BEFORE all other pairing.

2. There is interference on the headset with my phone.

The maximum distance for *Bluetooth* wireless communication is 33 feet (10 meters). When this distance is approached, background noise will increase. Also, a poor signal on the mobile phone may contribute to degradation the quality of sound as well.

3. There is no sound.

Ensure that both the mobile phone and the JB-TH220 are turned on, set up, and paired correctly. Be certain that the volume is turned up on both devices.

Specifications

- Bluetooth spec. v2.0+EDR compliance
- Headset (HSP) and Hands-free Profile (HFP) supported
- Bluetooth Class II
- Typically 6 hrs Talk Time
- Typically 170 hrs Stand-by Time
- Rechargeable Lithium Polymer Battery

jWIN

TEL: 516-626-7188

FAX: 516-626-7105

website: www.jWIN.com

© 2007 jWIN Electronics Corp. All rights reserved. The *Bluetooth* word mark and logos are owned by Bluetooth SIG, Inc. and any use of such marks by jWIN Electronics Corp. is under license. No portion of this printed material or product enclosed herewith including design, shape and graphics, may be reproduced or transmitted in any form without the expressed written consent of jWIN Electronics Corp. by any means, electronic or mechanical, including photocopying, recording or the use of an information storage and retrieval system. Any unauthorized distribution or reproduction of this printed material or product, or any portion thereof, will be prosecuted to the fullest possible extent of the law. Mobile phone not included in this package

Printed in China

Free Manuals Download Website

<http://myh66.com>

<http://usermanuals.us>

<http://www.somanuals.com>

<http://www.4manuals.cc>

<http://www.manual-lib.com>

<http://www.404manual.com>

<http://www.luxmanual.com>

<http://aubethermostatmanual.com>

Golf course search by state

<http://golfingnear.com>

Email search by domain

<http://emailbydomain.com>

Auto manuals search

<http://auto.somanuals.com>

TV manuals search

<http://tv.somanuals.com>