

plantronics®

LEARN MORE

MARQUE™ M155™

DESIGNED IN SANTA CRUZ, CALIFORNIA

TAKE A GOOD LOOK

CALL BUTTON

- **Take a call** (1 tap or say "Answer")
- **Reject a call** (1-second press or say "Ignore")
- **Redial** (2 taps)
- **Initiate phone's voice-dialing** (2-second press)
- **Reconnect lost Bluetooth® connection** (1 tap if the headset can't automatically reconnect)
- **Activate pairing mode after initial set up** (press until red/white LED flashes)

POWER SWITCH

- **On** (slide to reveal green)
- **Off** (slide to conceal green)

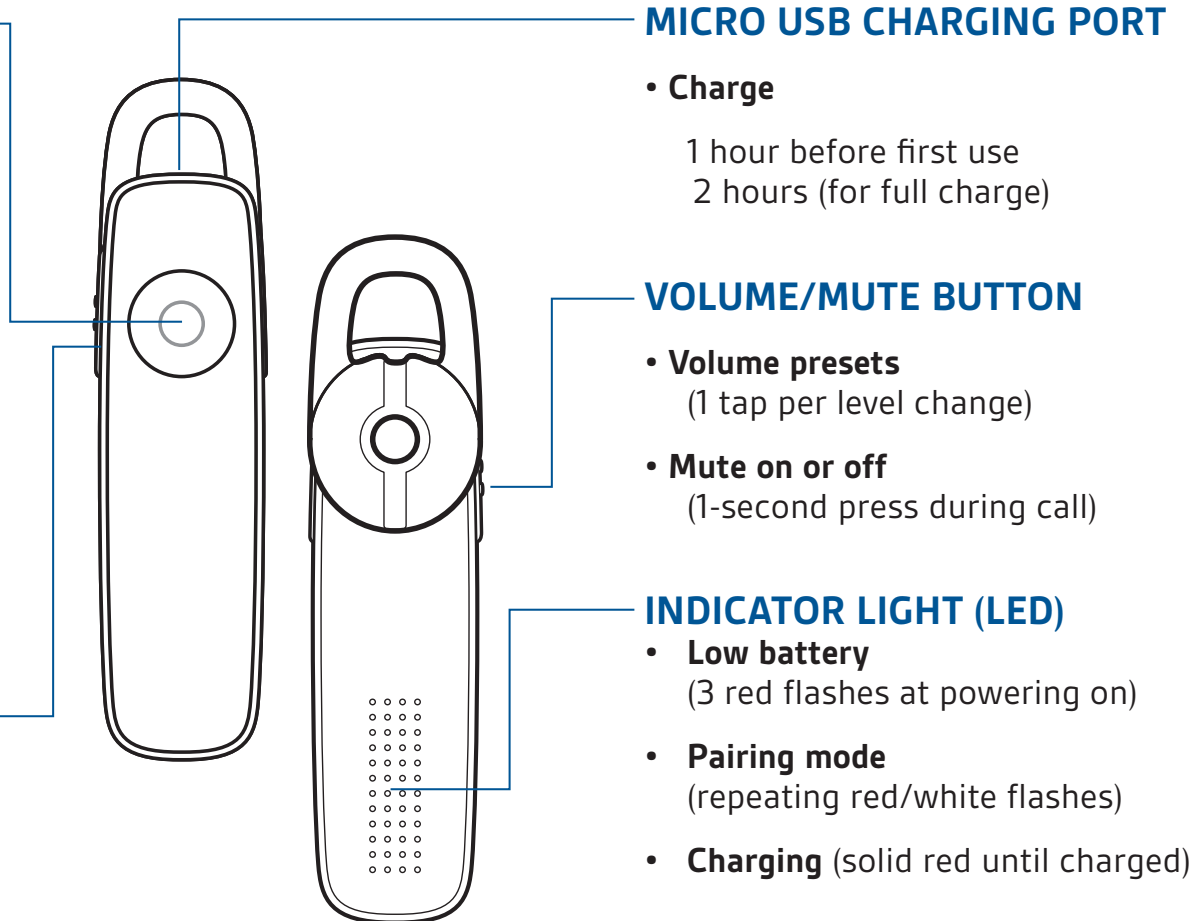

MICRO USB CHARGING PORT

- **Charge**
 - 1 hour before first use
 - 2 hours (for full charge)

VOLUME/MUTE BUTTON

- **Volume presets** (1 tap per level change)
- **Mute on or off** (1-second press during call)

INDICATOR LIGHT (LED)

- **Low battery** (3 red flashes at powering on)
- **Pairing mode** (repeating red/white flashes)
- **Charging** (solid red until charged)

AMP UP YOUR ANDROID OR iPHONE

Simplify the Set Up:

If you have an Android smartphone, download the MyHeadset™ app then turn on your new headset. The app will finish the pairing process with just one on-screen tap.

Download the Companion App:

Our free MyHeadset app gives you tips, tricks and tools for your Android or iPhone. A quick download from the Android marketplace or the Apple app store gets you going.

- One-tap pairing to your Android
- Record a memo then email it
- Learn about A2DP audio streaming
- Check out product FAQs and user guide

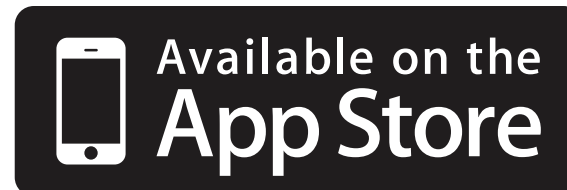

CONNECT TO YOUR PHONE

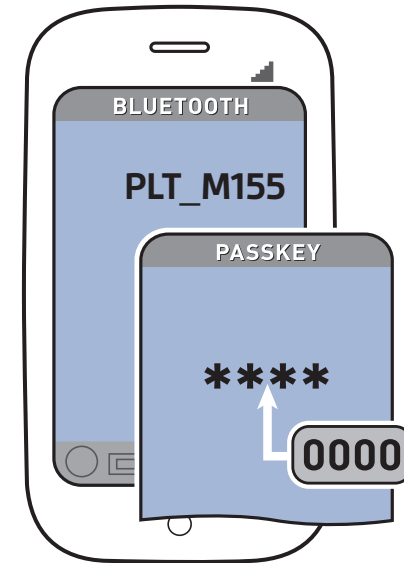
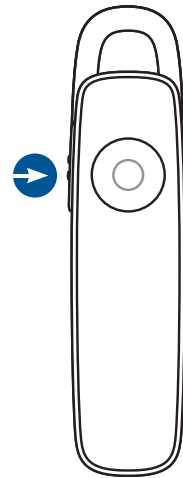

“Pairing” is the set-up process of introducing your headset to your phone. Before using your headset for the first time, you must pair it with your Bluetooth-enabled phone.

“Multipoint” lets you pair this headset with two phones so you can answer a call from either phone.

1. READY

First Time, Right Out of the Box:

Put on the headset and slide power switch to turn it on. The LED flashes red/white to indicate pairing mode.

Pair New or Second Phone:

Turn on headset. Press Call button until the LED flashes red/white for pairing mode.

2. SET

Activate the Bluetooth feature on your phone, then use phone menus to “add,” “search” or “scan” new Bluetooth devices.

Phones Have Different Menus to Select from, for example:

iPhone: Settings > General > Bluetooth > On (starts the search for devices)

BlackBerry® smartphone: Settings/options > Bluetooth: On > Search for devices

Android™: Settings > Wireless & Networks > Bluetooth: On > Scan for devices

3. CONNECT

Select “PLT_M155” from the list of Bluetooth devices shown on your phone.

If phone asks for a passcode, enter four zeros (0000). You may see **** on screen.

Some phones also ask to confirm headset connection after pairing.

Headset LED will stop flashing red/blue once successfully paired/connected.

You can now make a call using your phone’s keypad or voice-dialing feature.

FIND YOUR FIT

The loop of the gel eartip tucks into the back curve of your ear for a stable fit.

Try on the headset. The eartip is positioned to suit most people, but you may want to rotate it to best fit your left or right ear.

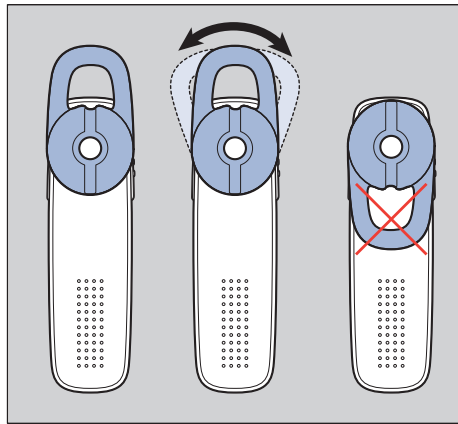

If the gel eartip feels loose or tight in your ear, then replace it with one of the two alternate size eartips.

To remove the eartip, pull the loop of the eartip away from the speaker stem. (Don't pull on the speaker base and stem.)

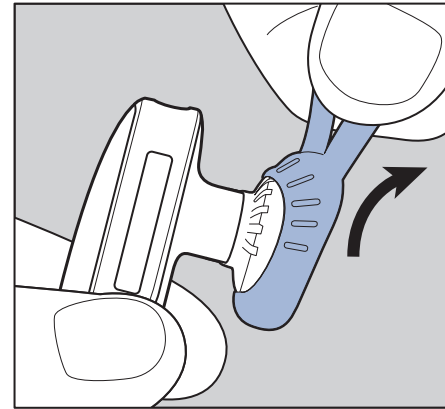

Tuck the bottom of the new eartip over the speaker and pull the eartip over the speaker. (Don't push the speaker through the gel eartip.)

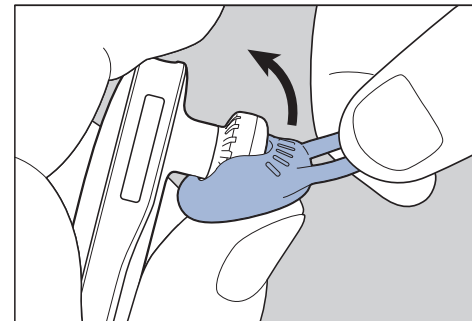

TIPS

Stay Near Your Phone

Bluetooth has a working “range” of up to 33 feet between the phone and headset before audio degrades and the connection is lost.

Know How to Reconnect

Your headset tries to reconnect a lost connection. If it can't, then tap the Call button once or manually reconnect via the phone's Bluetooth device menu.

Use Multipoint One Call at a Time

Once you have activated multipoint and paired your two phones, it's easy to answer calls from either phone.

When already on a call, you will hear a ringtone notification of the incoming call from the second paired phone.

To answer a second call from the other phone, you must end the current call (tap Call button) so new call automatically answers.

If you choose not to answer the second call, it will go to voicemail.

Play Tunes and Take Calls

If you are listening to any streaming audio when your phone rings, the audio will pause to allow you to answer or ignore the incoming call. Once the call ends or is ignored, the streaming audio resumes playback.

Use Your Voice

After being prompted by the headset, you can just say “answer” or “ignore” to incoming calls - no need to press any buttons.

You can disable this voice-controlled feature. With the headset powered on, simultaneously press the call button and vol button until you see the white LED flash twice. To reactivate the feature, just repeat the steps and you will again see the white LED flash twice.

SPECIFICATIONS

Talk Time	Up to 5 hours
Standby Time	Up to 9 days
Operating Distance (Range)	Up to 33 feet (10 meters), Class II
Headset Weight	7 grams
Charge Connector	Micro USB charging
Battery Type	Rechargeable non-replaceable lithium ion polymer
Charge Time (Maximum)	2 hours for full
Power Requirements	5V DC – 180mA
Bluetooth Version	Bluetooth v3.0
Bluetooth Profiles	Hands-Free (HFP) Profile 1.6 and Headset (HSP) Profile 1.2 Advanced Audio Distribution Profile (A2DP)
Operating Temperature	32°F - 104°F (0 - 40°C)
Storage Temperature	32°F - 104°F (0 - 40°C)
Charging Temperature	32°F - 104°F (0 - 40°C)

NEED MORE HELP?

Don't return to the store - call our friendly customer support team at 1-866-363-2583 (USA) or visit plantronics.com/support for local numbers outside the US.

© 2011 Plantronics, Inc. All Rights Reserved. Bluetooth is a registered trademark of Bluetooth SIG, Inc. and any use by Plantronics is under license. All other trademarks are the property of their respective owners.

Patents US 5,712,453; D628188; Patents Pending. 86818-06 (9-11) ROW-EN



Free Manuals Download Website

<http://myh66.com>

<http://usermanuals.us>

<http://www.somanuals.com>

<http://www.4manuals.cc>

<http://www.manual-lib.com>

<http://www.404manual.com>

<http://www.luxmanual.com>

<http://aubethermostatmanual.com>

Golf course search by state

<http://golfingnear.com>

Email search by domain

<http://emailbydomain.com>

Auto manuals search

<http://auto.somanuals.com>

TV manuals search

<http://tv.somanuals.com>