

Savi™ Office WO200

Wireless headset system

with Optional HL10™ lifter

User guide

Welcome

Congratulations on purchasing your new Plantronics product. This guide contains instructions for setting up and using your Savi Office WO200 (WO1 base and WH200/WH210 headset) wireless headset system. Please refer to the separate [safety instructions](#) for important product safety information prior to installation or use of the product.

Refer to the CD for Animated set up instructions.

Contents

1 Package Contents and Features	4
1.1 Savi Base.....	4
1.2 Savi Headset.....	5
1.3 HL10 Lifter (Optional).....	6
2 Base Set Up	7
2.1 Attaching Charge Cradle to Base	7
2.2 Connecting Base to Desk Phone.....	7
2.3 Connecting Power Supply to Base.....	7
2.4 Positioning Base.....	7
3 Headset Set Up	8
3.1 Fitting Headset	8
3.2 Docking and Charging the Headset.....	8
4 Configure and Test Call	9
4.1 Checking Configuration	9
4.2 Making a Test Call with Desk Phone	9
5 Lifter Set Up (Optional)	10
5.1 Installing Lifter.....	10
5.2 If You Do Not Hear a Dial Tone	10
5.3 Additional Parts (if required).....	11
6 PC Set Up	12
6.1 Installing USB Cable.....	12
6.2 Installing PerSono Suite Software	12
6.3 Making a Test Call with PC.....	12
7 Using Your Savi Office Professional Wireless Headset System	13
Powering up Headset	13
Placing, Answering and Ending Calls with Desk Phone	13
Placing, Answering and Ending Calls with PC	14
Switching Between Desk Phone and PC Audio	14
Mixing Desk Phone and PC Audio	14
Muting the Headset	15
Subscribing a Master Headset	15
Conferencing In Up to Three Additional Headsets	15
Setting Default Line to Desk Phone or PC.....	16
Toggling On/Off Over-the-Air Subscription.....	16
Setting the Range	16
Ending Subscription	16
Placing the Headset in Sleep Mode	16
Subscription Button Indicator Light.....	16
Desk Phone and PC Talk Buttons Indicator Lights.....	16
Talk Time.....	17
Desk Phone and PC Talk Buttons “Rules to Live By”	17
Headset Call Control Button Functions.....	17
Headset Indicator Light	17
Headset Tones	17
8 PerSono Suite Software	18
Audio Control.....	18
Softphone Support	20
Settings Screen – Headset and Base	21
Help for Base Settings.....	22
PC Panel Screen.....	24
Advanced settings	24
Security screen	24
Support screen	25
Updates	25
9 Troubleshooting and Common Questions	26

1 Package contents and features

1.1 Savi WO1 base

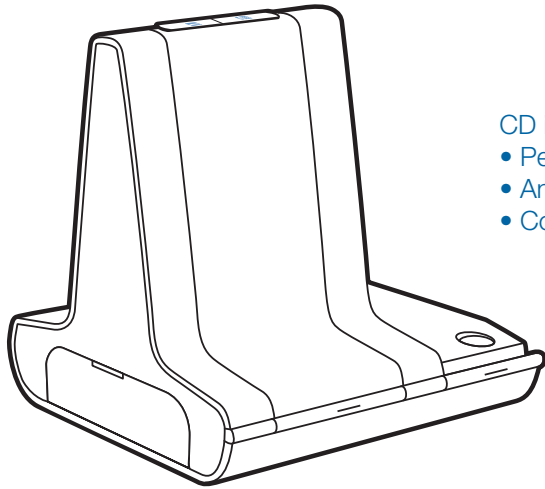

Base

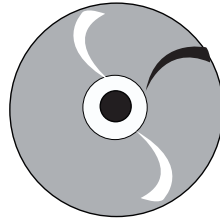

CD includes:

- PerSono® Suite™ software
- Animated setup guide
- Complete user guide

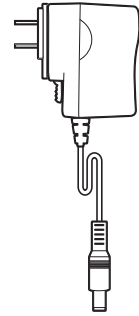

Base power supply

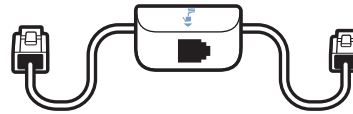

Telephone interface cable

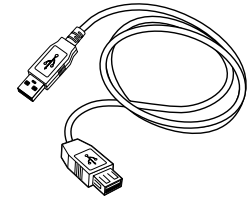

USB cable

Savi WO1 base features

PC talk button
Indicator light
Desk phone talk button
Indicator light

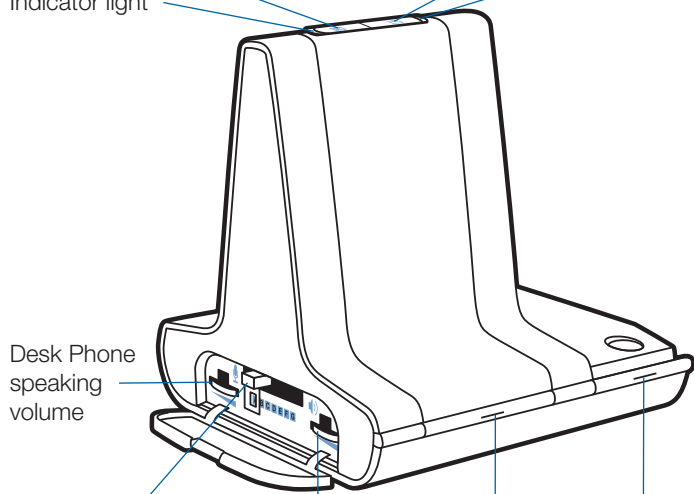

Desk Phone speaking volume

Configuration switch

Desk Phone speaking volume

Subscription button and indicator light

Charging indicator light

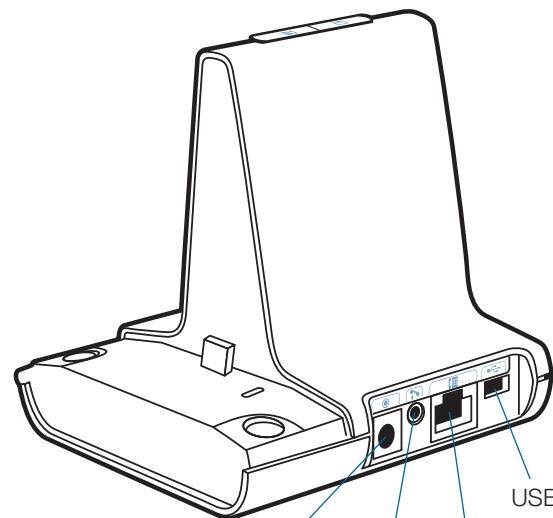

Power jack

Handset lifter jack

Telephone interface cable jack

USB port

1.2 Savi WH200/WH210 headset

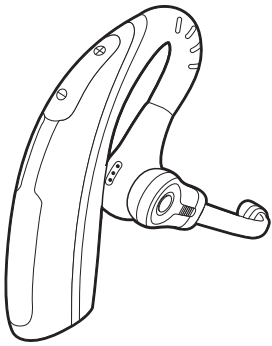

Headset with pre-installed ear tip

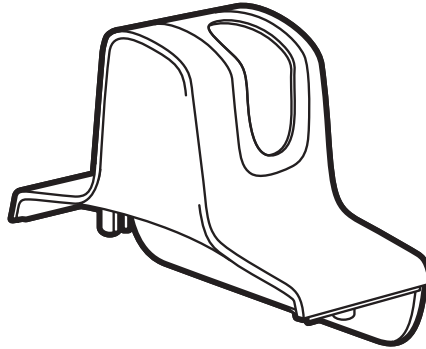

Charging cradle



Ear tips

Savi WH200/WH210 headset features

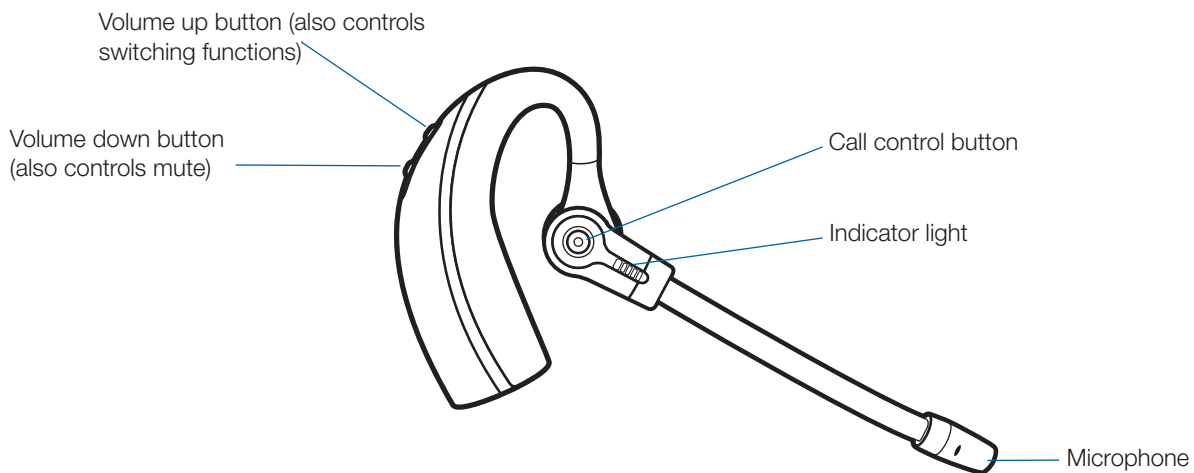

1.3 HL10 lifter (optional)

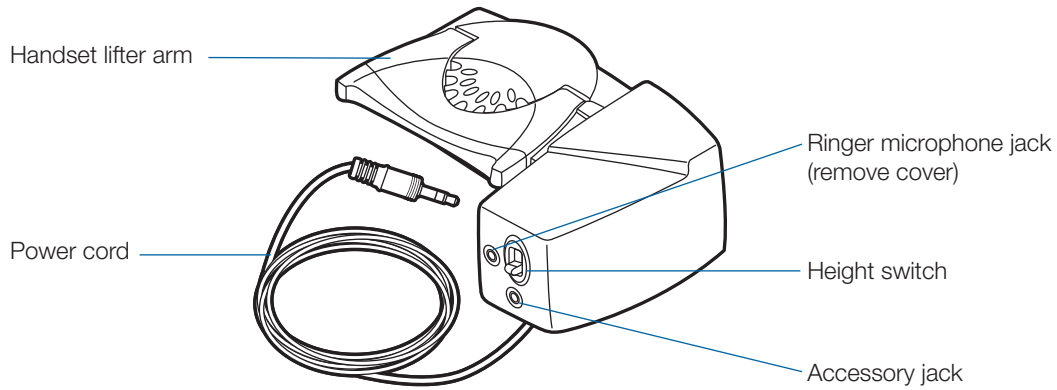

HL10 lifter

Additional HL10 lifter parts (if required)

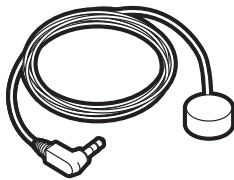

Ringer microphone

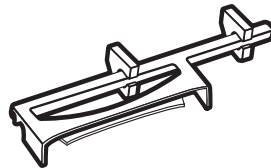

Extender
arm



For Nortel i2004
phones only

2 Base set-up

2.1 Attaching charging cradle to base

- 1 **Connect the headset charging cradle to the base.** Push firmly on the cradle until the cradle snaps into place.

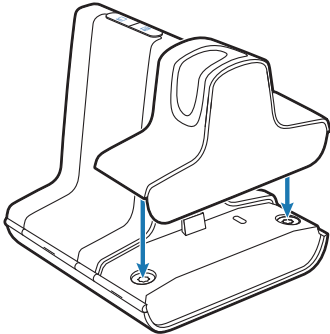

2.2 Connecting base to desk phone

- 1 **Connect the telephone interface cable to the telephone interface cable jack on the base.**
- 2 **Disconnect the handset coil cord from the desk phone.**
- 3 **Connect the telephone interface cable to the now open handset port on the desk phone.**
- 4 **Connect the handset coil cord to the telephone interface cable junction box.**
- 5 **Place the handset back on the telephone cradle.**

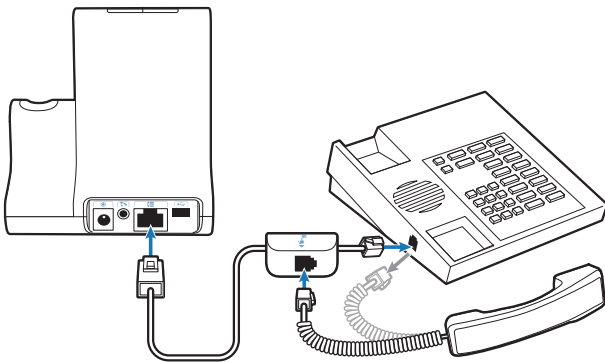

NOTE If your phone has a built-in headset port, you should only use the headset port if you will not be using the HL10 lifter. In this configuration, you must press both the headset button on your phone and the call control button on the headset to answer or end calls.

2.3 Connecting power supply to base

- 1 **Connect the base power supply into the power jack on the base.**
- 2 **Connect the power supply to outlet.**

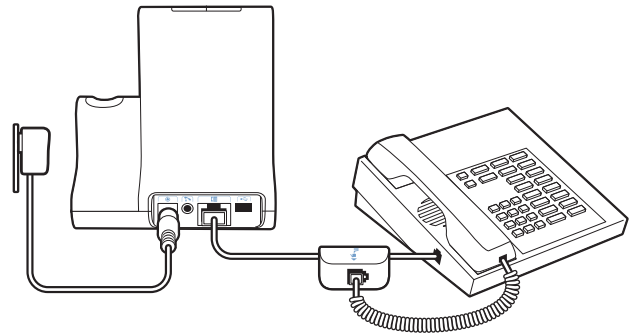

2.4 Positioning base

The minimum recommended separation between your desk phone and the base is 15 cm.

The minimum recommended separation between the base and computer is 30 cm. Incorrect position can cause noise and interference problems.

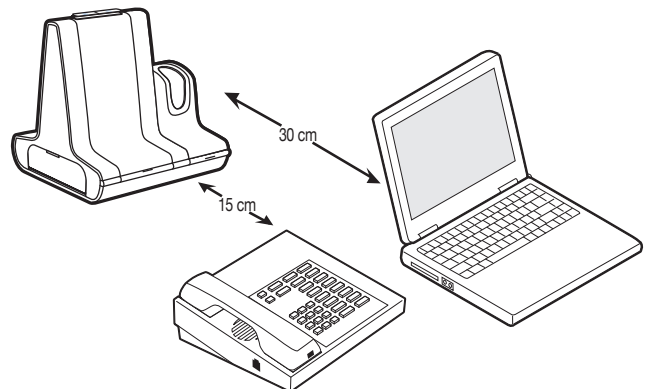

3 Headset set-up

3.1 Fitting headset

The headset comes with a pre-installed ear tip. To install a different ear tip, see the following:

- 1 Remove the pre-installed ear tip by pushing in and turning the ear tip **CLOCKwise**, then pull firmly.

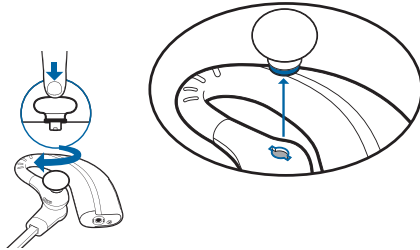

- 2 Choose the size and style of ear tip that fits most comfortably. Align ear tip tabs with notches in headset. Push in firmly and twist **ANTI-clockwise**.

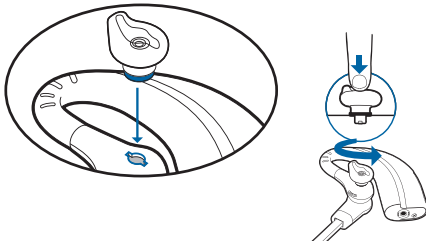

NOTE When installing a gel tip, ensure the raised part of the ear tip is pointed towards the curved section of the headset as shown.

- 3 Slide the headset over and behind your ear, then press gently towards your ear.

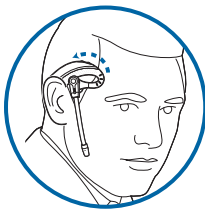

- 4 Rotate the microphone boom until it is pointed towards your mouth.



- 5 The headset can be converted for wearing on left ear as follows:

- a. Rotate the microphone boom up.

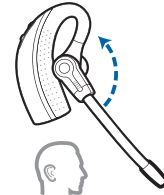

- b. Turn microphone boom around.

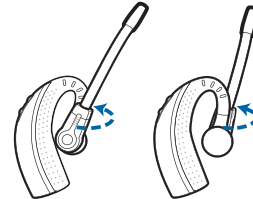

- c. Rotate microphone boom down.

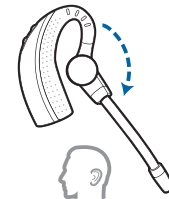

3.2 Docking and charging the headset

- 1 Gently push the headset into the charging cradle.

The charging indicator light on the base will flash green to indicate that the headset battery is charging.

- 2 Charge for at least 20 minutes prior to the first use.

A full charge takes 3 hours. The indicator light will turn solid green.

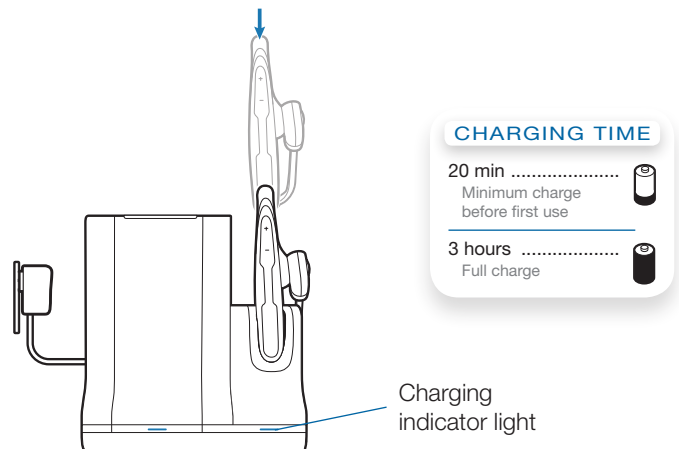

4 Configuration and test call

4.1 Checking configuration

- 1 If your desk phone has a volume control set it to mid-range.
- 2 On the base, ensure the Configuration switch is set to "A" and the Desk phone speaking volume and Desk phone listening volume are both set to 3.

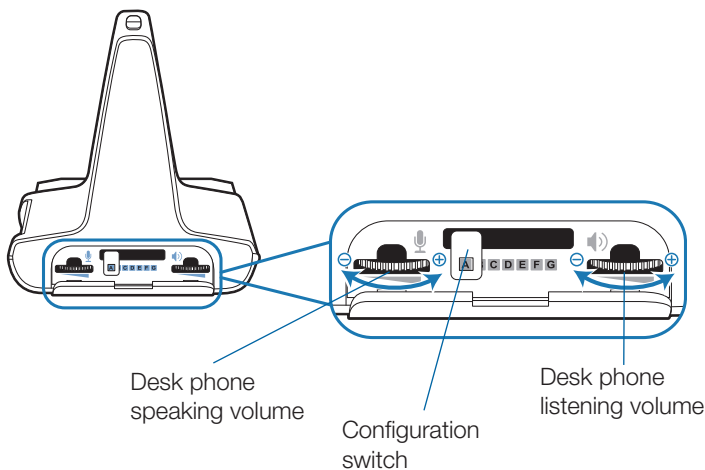

NOTE For most phones, these factory default settings will sound the best.

- 3 With your headset on, press the call control button on the headset.
- 4 Remove the headset from desk phone cradle.
- 5 Listen for a dial tone. If the dial tone sounds clear, press the call control button on headset and continue with Step 6. **Making a test call with desk phone.**
- 6 You can also fine tune the listening volume on the headset by pressing the volume up button [+] to increase the volume and the volume down button [-] to decrease the volume.

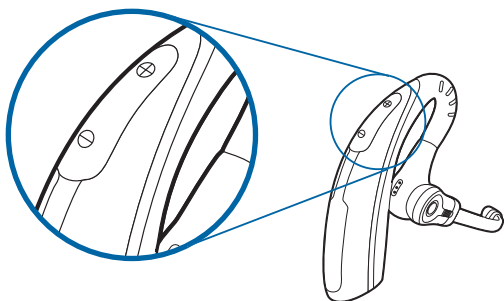

- 7 If the dial tone still does not sound clear, adjust the Configuration Switch until the dial tone sounds the best.

NOTE Multiple settings might work with your phone; however, only one is the optimal position.

- 8 Press the call control button on the headset to complete configuration.
- 9 Replace the headset into the desk phone cradle.

4.2 Making a test call with desk phone

- 1 If your desk phone has a volume control, ensure it is set to mid-range.
- 2 With your headset on, press the call control button on the headset.
- 3 Remove the headset from desk phone cradle.
- 4 Dial the number using your desk phone.
- 5 If the listening volume is too loud or too soft, adjust the listening volume on the headset by pushing the volume up button [+] to increase the volume and the volume down button [-] to decrease the volume.
- 6 If the listening volume is still too loud or too soft adjust the Desk phone listening volume on the base. A setting that is too high can produce an uncomfortable echo for you.
- 7 If the speaking volume is too loud or too soft for your listener, adjust the Desk phone speaking volume on the base to the best setting for your listener. A setting that is too high can produce an uncomfortable echo for you and a distorted sound for you listener.
- 8 Press the call control button on the headset to end the test call.
- 9 Replace the headset into the desk phone cradle.

 For your safety, do not use headset at high volumes for extended periods of time. Doing so can cause hearing loss. Always listen at moderate levels. For more information on headsets and hearing visit: www.plantronics.com/healthandsafety.

5 Lifter set-up (optional)

5.1 Installing lifter

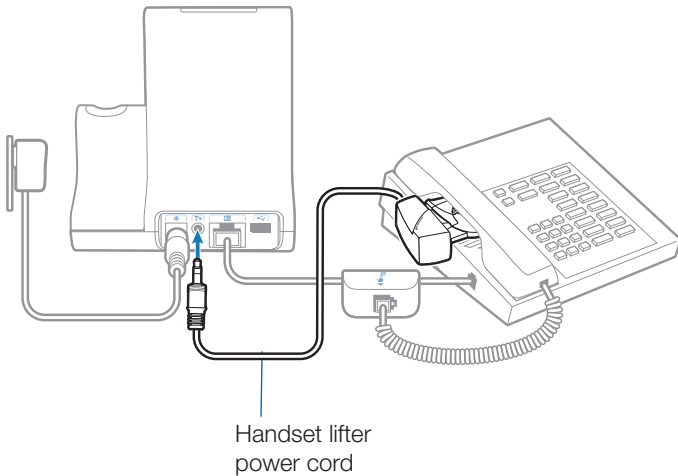

- 1 Firmly press the handset lifter power cord into the handset lifter jack.
- 2 While wearing your headset, slide the handset lifter arm under the handset until the lifter base touches the side of the phone.
- 3 Slide the lifter up to where it nearly touches the handset earpiece.

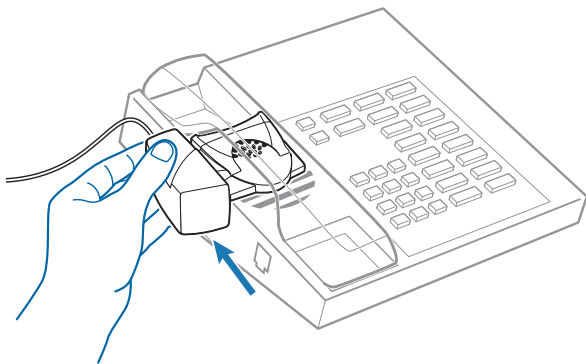

- 4 Press the call control button on your headset to activate the lifter.
- 5 If you hear a dial tone, the lifter is set correctly and needs no adjustment.
6. Remove the protective strips from the 3 mounting tapes on the underside of the lifter.

- 7 Gently place the lifter on the desk phone in the pre-determined position.
- 8 Press firmly to adhere.

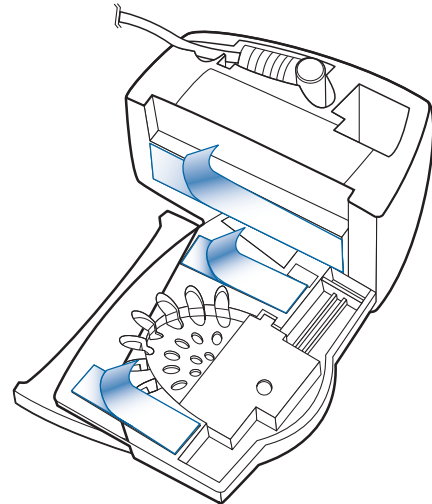

5.2 If you do not hear a dial tone

- 1 If you do not hear a dial tone, raise the lifter height switch to the next highest position.

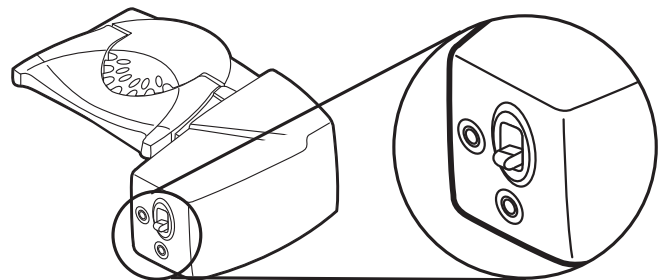

- 2 Repeat Steps 2 to 5 in Section 5.1 as necessary until you hear a dial tone.
- 3 When you hear a dial tone, secure the lifter as described in Steps 6 to 8.

5.3 Additional parts (if required)

Extender arm

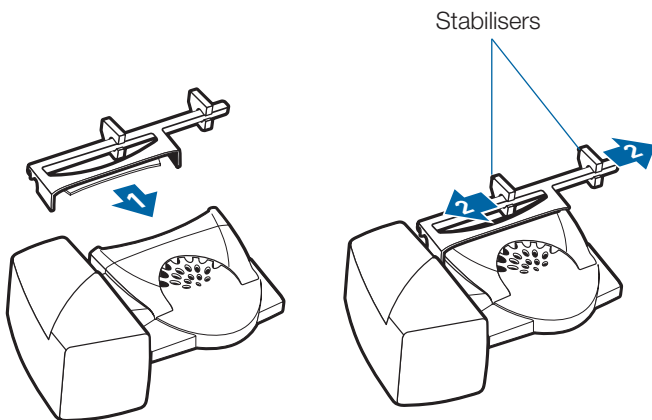

Use extender arm when the handset lifter needs additional stability lifting and returning handset to cradle.

- 1 Slide extender arm onto lifter.**
- 2 Stabilisers can be shifted left and right.** Position stabilisers on outside of handset to gently grip the phone.

Ringer microphone

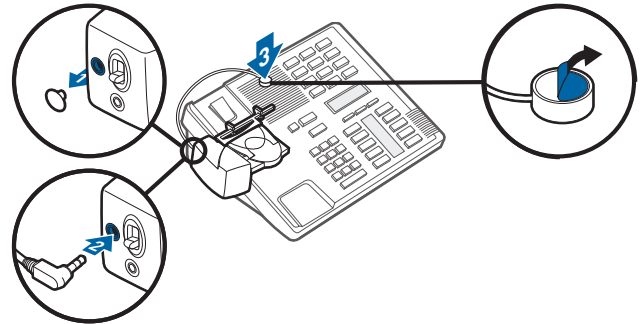

Use ringer microphone only when the telephone speaker is not located directly under the handset.

- 1 Remove cover from ringer microphone jack on back of lifter.**
- 2 Connect ringer microphone plug.**
- 3 Place ringer microphone over phone speaker.** Remove adhesive tape and attach.

For Nortel i2004 phones only

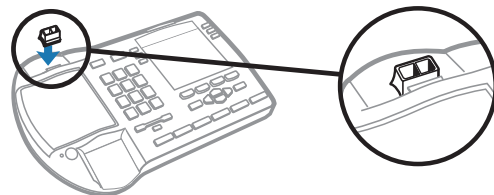

6 PC set-up

6.1 Installing USB cable

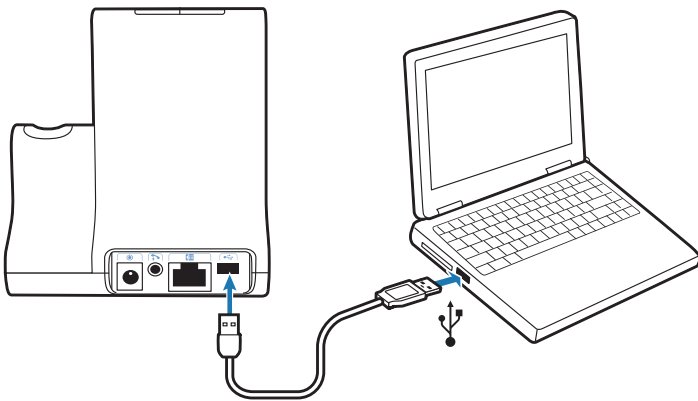

- 1 Connect the USB cable to the USB port on the back of the base.
- 2 Connect the other end of the USB cable to the USB port of the PC.

6.2 Installing PerSono Suite software

- 1 In the interactive setup guide located on the CD, select [Step 6.2 Installing PerSono Suite Software](#).
- 2 Click on the graphic of the CD labelled "PerSono Suite Software".
- 3 Follow installation instructions shown on screen.

6.3 Making a test call with PC

- 1 Ensure the PerSono Suite software is running on your PC. You will see a headset icon in the lower right-hand portion of the PC tray bar when PerSono Suite software is running.



- 2 With your headset on, press the PC talk button on the base.
- 3 Dial the number using your softphone application.
- 4 Adjust listening and speaking volume over the PC as follows:

For Windows® XP Systems-

Go to the "Voice" tab of the "Sounds and Audio Devices" option in your PC control panel.

- "Voice playback" volume is your receive volume
- "Voice recording" volume is your transmit volume

For Windows Vista® Systems-

Go to the "Playback" tab for listening volume or "Recording" tab for speaking volume of the "Sound" option in your PC control panel.

- "Speakers Level" volume is your receive volume
- "Microphone Level" volume is your transmit volume

- 5 You can also fine-tune the listening volume on the headset by pressing the [+] to increase the volume and the [-] to decrease the volume.

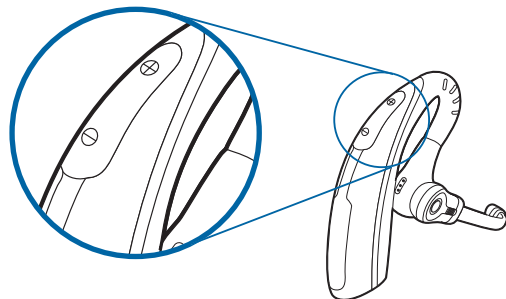

- 6 To end the test call, press the call control button on the headset.

7 Using your Savi Office wireless headset system

IMPORTANT It is highly recommended that you install the PerSono Suite software. Though your Savi Office system will operate without the software, running it without the software will limit the system's full capabilities.

Powering up headset

If the headset battery is charged, the headset is automatically on. The headset does not have an on/off button.

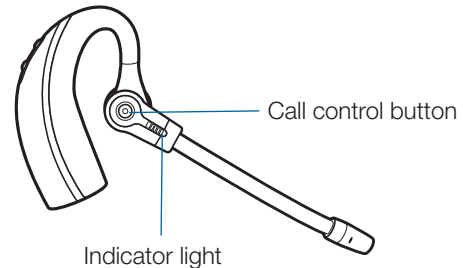

Placing, answering and ending calls with desk phone

	Phones with handset lifter or electronic hookswitch	Phones without handset lifter or electronic hookswitch
To place a call	<ol style="list-style-type: none">1. Briefly press call control button on headset* or briefly press base desk phone talk button2. Dial number	<ol style="list-style-type: none">1. Briefly press call control button on headset* or briefly press base desk phone talk button2. Remove handset from cradle**3. Dial number
To answer a call	<ol style="list-style-type: none">1. Briefly press call control button on headset or briefly press base desk phone talk button	<ol style="list-style-type: none">1. Briefly press call control button on headset or briefly press base desk phone talk button2. Remove handset from cradle**
To end a call	<ol style="list-style-type: none">1. Briefly press call control button on headset or briefly press base desk phone talk button	<ol style="list-style-type: none">1. Briefly press call control button on headset or briefly press base desk phone talk button2. Return handset to cradle**

* Assumes your default line is set to desk phone.

** To place, answer and end calls with desk phones that have a headset button, without a handset lifter, you will need to press the headset button on the desk phone instead of removing the handset from the cradle.

Placing, answering and ending calls with PC

	With PerSono Suite software*	Without PerSono Suite software
To place a call	1. Dial number from the supported softphone application***	1. Briefly press call control button on headset** or briefly press base PC talk button 2. Dial number from softphone application
To answer a call	1. Briefly press call control button on headset or briefly press base PC talk button	1. Briefly press call control button on headset** or briefly press base PC talk button 2. Answer call using softphone application
To end a call	1. Briefly press call control button on headset or briefly press base PC talk button	1. Briefly press call control button on headset** or briefly press base PC talk button 2. Hang up call using softphone application

*Assumes use of supported softphone

**Assumes your default line is set to PC

*** Automatically bringing up the PC radio link is not supported when placing an outbound call in Microsoft Office Communicator.

Switching between desk phone and PC audio

You can switch back and forth between desk phone and PC audio in the following ways:

Headset	Base	PerSono Suite software*
Press the volume up button (at least 1½ seconds) until the base talk button indicator light of the desired device becomes solid green.	Briefly press (less than one second) the base talk button of the device that you want to switch to.	Click the active (green) PC or desk phone icon to put it on hold. Click the other red icon (on-hold) to activate it.

* Desk phone and PC audio links have to be brought up by the headset or base. You cannot initiate an audio link via the Audio Control Screen in the PerSono Suite software.

Mixing desk phone and PC audio

You can mix desk phone and PC audio in the following ways:

Base	PerSono Suite software*
Simultaneously hold the desk phone and PC talk buttons down (at least 1½ seconds) until both indicator lights become solid green.	Click any red (on-hold) icon to activate it. When all three icons (headset/desk phone/PC) are green and all arrows are green, the audio of the devices are mixed.

* Desk phone and PC audio links have to be brought up by the headset or base. You cannot initiate an audio link via the Audio Control Screen in the PerSono Suite software.

Muting the headset

You can mute/unmute the headset in the following ways:

Headset	Base	PerSono Suite software*
Press the volume down button (at least 1½ seconds) until the base talk button indicator light for the active call becomes solid red.	Briefly pressing (less than one second) a red desk phone or PC talk button on the base will unmute the headset. You cannot mute the headset using the desk phone or PC talk buttons.	Click the green headset icon. The headset icon will turn red indicating the headset transmit is muted. Clicking the headset icon again will unmute the headset.

* Desk phone and PC audio links have to be brought up by the headset or base. You cannot initiate an audio link via the Audio Control Screen in the PerSono Suite software.

Subscribing a master headset

The headset and base are subscribed to each other at the factory. In the event that you need to subscribe a new master headset to the base you can do so one of two ways. You can subscribe a master headset to the base with the headset docked (secure subscription) or undocked (over-the-air subscription). In either case, the system must be idle (not on a call).

Headset docked	Headset undocked
Double press the subscription button on the base. The subscription light will flash red and green. When the subscription light becomes solid green, the headset and base are subscribed to one another.	Double press the subscription button on the base. The subscription light will flash red and green. Press the volume up button on the headset for three seconds until the indicator light turns solid green. When the subscription light on the base becomes solid green, the headset and base are subscribed to one another.

NOTE If the subscription process times out after two minutes or if the subscription process fails, the subscription light will become solid red for four seconds and then return to its previous state. If this occurs, try to subscribe the headset again.

Conferencing in up to three additional headsets

While on a call, you can subscribe up to three additional headsets to your base for conferencing. As you add headsets to the base, an additional headset icon will appear in the PerSono Suite Software screen with a number from 1 to 3 indicating the number of additional headsets subscribed to the base.

Guests may conference in as described below:

1 While you are on a call:

a) Place the guest's headset into primary user's charging cradle.

OR

b) Place the guest's headset into over-the-air subscription mode by pushing the headset volume up button for three seconds until the indicator light becomes solid green.

2 Briefly press (less than one second) the subscription button on the base.

The subscription light will flash yellow and green.

3 The subscription light will then turn solid yellow and you will hear a tone in the master headset indicating that a guest wishes to join the call.

4 If you press the call control button on the master headset within five seconds, the guest is joined to the call.

If you do not press the call control button within five seconds, the request to join the call is rejected and the guest will hear an error tone in their headset.

5 Guests may leave the conference call by pressing their call control button.

When they do you will hear a single tone in the master headset as each guest leaves the call.

To see how many headsets are subscribed to the base, refer to the lower left-hand corner of the PerSono Suite Software screen. The first headset is the master headset and the number inside the next headset is the number of guest headsets subscribed to the base. The examples below show 1, then 2, then 3, guest headsets subscribed to the base in addition to the master headset.



Setting default line to desk phone or PC

The Savi Office system is supplied with the desk phone as the default outbound line. This means any call initiated from the headset with the call control button will open desk phone audio. You can change your default outbound line from the base talk buttons.

While the system is in idle mode, press and hold the PC talk button or the desk phone talk button for three seconds to select that device as your default outbound line. The talk button indicator light will flash green for four seconds, confirming the new setting.

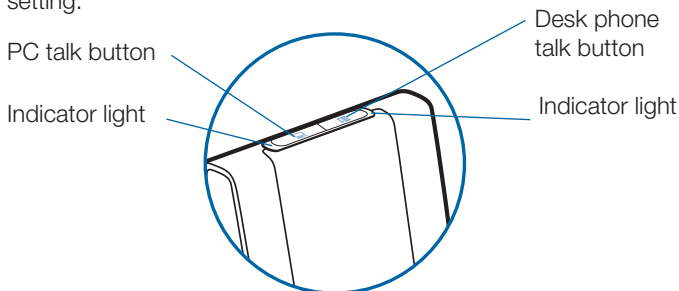

Toggling on/off over-the-air subscription

The Savi Office system is supplied with the over-the-air subscription enabled. You can toggle on or off over-the-air subscription using the subscription button on the base. With the master headset **UNDOCKED** and the system idle, press the subscription button for three seconds. The subscription button will flash green for four seconds if over-the-air subscription is on and red for four seconds if off.

Setting the range

With the master headset **DOCKED** and the system idle, press the subscription button for three seconds. Both the desk phone and the PC talk buttons will flash green for high range. If you press the subscription button again for three seconds, the talk buttons will flash yellow for medium range. If you press the subscription button again for three seconds, the talk buttons will flash red for low range.

Ending subscription

If the base is in subscription mode (secure or over-the-air) and you want to stop the base from searching for a headset, press the subscription button again. The subscription light will turn solid red for four seconds and then return to its previous state.

Placing the headset in sleep mode

If you won't be using the headset for a long duration and the headset will not be in the charge cradle, you can put the headset in sleep mode by pressing the call control button for three seconds while in an idle state. To exit sleep mode, press the headset call control button again for three seconds.

Subscription button indicator light

Master headset subscribed to base	Solid green
Base in master subscribing mode	Flashes red and green
Base conferencing in additional guest headset(s)	Flashes yellow and green
Active conference call with guest headsets subscribed to base	Solid yellow

Desk phone and PC talk buttons indicator lights

No active audio link	Off
Incoming call	Flashes green
Active audio link	Solid green
Master headset muted	Solid red
Call on hold	Flashes red
Seeking Audio Link*	Solid yellow

* When bringing up a link from the base, the talk button will be solid yellow until a link is established. This could take up to several seconds especially for wideband audio and/or when in moderate to high density environments. If you press the talk button when the indicator light is yellow, it will terminate the search for an audio link.

Talk time

The Savi WO200 Office system will provide up to 6 hours of talk time. Talk time will be reduced when operating in wideband mode and/or if the headset is used consistently at a far distance from the base.

Desk phone and PC talk buttons “Rules to live by”

Button (indicator light) state	If button is pressed
Off	Solid green
Flashing green	Solid green
Solid green	Off
Solid red	Solid green
Flashing red	Solid green

NOTE If in any state, you hold down both the PC and desk phone talk buttons for 1½ seconds both indicator lights will turn solid green and the audio from both devices will be mixed.

Headset call control button functions

Type of Press	Function
Short press	Places, answers, or ends calls
Short press volume up	Increases volume
Short press volume down	Decreases volume
While in a link, long press volume up (at least 1½ seconds)	Switches between desk phone and PC audio
While in a link, long press volume down (at least 1½ seconds)	Mutes or unmutes headset
While not in a link, long press volume up (at least 1½ seconds)	Places headset in subscription mode
While not in a link, long press volume down (at least 1½ seconds)	Enables and disables headset in-use indicator light

Headset indicator light

Headset status	Headset indicator light
Headset charging	Off
Headset fully charged	Off
Headset in use	Flashes green
Subscribing	Solid green

Toggle on/off headset in use indicator light

If you are not on a call, you can toggle the headset in use indicator light on and off by pressing the headset volume down button for three seconds.

Headset tones

Out of range warning

If you are on a call and go out of the operating range, you will hear three low tones. You will hear a single mid tone when you are back in range.

If you stay out of range, active calls will be suspended. Calls will be re-established when you walk back into range. If you remain out of range for more than 5 minutes, the system will drop the call.

If you are not on a call and go out of the operating range and press the call control button, you will hear a single tone for the button press and three low tones for the failure to make a link.

Low battery warning

If you are on a call, you will hear a repeated single low tone every 15 seconds indicating that the battery is low. You should recharge the headset immediately.

If you are not on a call and press the call control button, you will hear three low tones indicating that the battery is low. You should recharge the headset immediately.

Mute warning

When mute is activated, you will hear three high tones. These tones will repeat every 15 seconds while mute is active.

When unmuted, you will hear three low tones.

8 PerSono Suite software

It is highly recommended that you install the PerSono Suite software. Though your Savi Office system will operate without the software, running it without the software will limit the system's capabilities.

PerSono Suite software allows you to do the following with your Savi Office system:

- Answer/end calls from the PC remotely with the headset (requires use of supported softphone)
- Mute/mix audio paths between the headset/desk phone/PC via a clickable interactive Audio Control Screen.
- Customise your headset and base settings to your personal preferences
- Automatically manage your PC multimedia so you never miss a call
- Quickly access links to product support and software/firmware upgrade information

Audio control

When the PerSono Suite software is launched and running the headset icon will appear in the PC tray bar. To bring up the PerSono Suite Software, double-click the headset icon. On the left of the screen you will see a menu selection with Audio Control highlighted. In the center is the clickable interactive screen where you can mute/mix the audio paths between the headset/desk phone/PC.

Audio links cannot be initiated or ended via the clickable interactive Call Audio Control Screen. This can only be done by using the headset call control button or the base talk buttons.

Icons and arrows

Icons

- Grey = device idle
- Green = device active
- Solid red headset = headset transmit muted
- Blinking red PC = PC on hold (all audio paths to and from PC are muted)
- Blinking red desk phone = desk phone on hold (all audio paths to and from desk phone are muted)

Arrows

- Grey = audio path idle
- Green = audio path active
- Red = audio path muted

Interactive rules

The headset, PC and desk phone icons are all clickable.

- When you click a green headset icon, it will turn red and the headset transmit will be muted. Clicking the red headset icon will turn it back to green and unmute the headset.

- When you click a green PC or desk phone icon, it will turn red and start to blink, indicating the device has been put on hold. Clicking a blinking red PC or desk phone icon will turn it back to green, indicating the device is active again.

Examples

All devices idle



Active desk phone call, PC idle

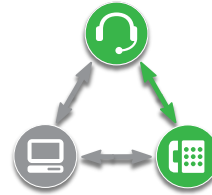

Active PC call, desk phone on hold

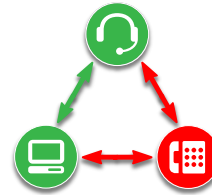

All devices mixed



All devices mixed, headset muted



When you are listening to multimedia through a supported media player on your PC, and there are no calls that are active or on-hold, a music note will replace the PC icon.

Active multimedia, desk phone idle



If PerSono Suite software is configured to manage your multimedia automatically when a call comes in, the music note will disappear and then be brought back up once all your calls have ended.

In order to mix multimedia from your PC with an active desk phone call, you must follow these steps:



1 Start with your active desk phone call.

2 Bring up the PC audio link and put your active desk phone call on hold by pressing the PC talk button on the base.

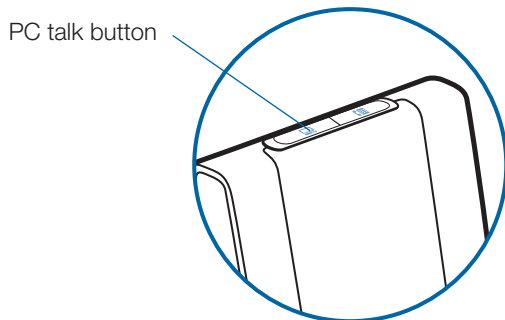

3 Launch your media player on your PC and start playing multimedia.

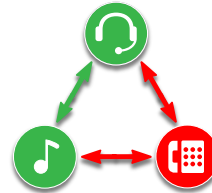

4 Click on the red desk phone icon to bring the desk phone off hold, and your multimedia will now be mixed with your desk phone audio.

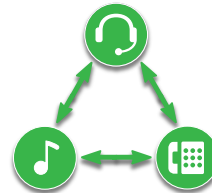

Battery life

At the lower left-hand corner of the screen (and for all software screens), you will see one of the following icons indicating the approximate charge left in the headset battery.

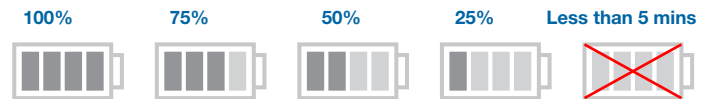

Subscribed master headset

The single headset icon next to the battery icon shows the primary headset currently subscribed to the base. Additional headsets can be added for call conferencing. Please refer to [Conferencing in up to three additional headsets](#) on page 15 for more information.



Softphone support

For a list softphones supported by PerSono Suite refer to www.plantronics.com/SoftphoneCompatibility. PerSono Suite software supports all the softphones on the list with no additional steps by the user except Skype™.

To allow Skype to be a supported softphone in PerSono Suite please follow these steps:

- 1 **Ensure PerSono Suite software is running on your PC.**
You will see a headset icon in the lower right portion of the PC tray bar when PerSono Suite software is running.



- 2 If Skype is running on your PC, Skype will notify you of the event that “PerSonoSuite.exe wants to use Skype”. Go to the “new event” tab located in the upper right of the Skype window and click on the red flag. You then will need to click on the “PerSonoSuite.exe” link to be taken to the “Manage API Access Control” screen.

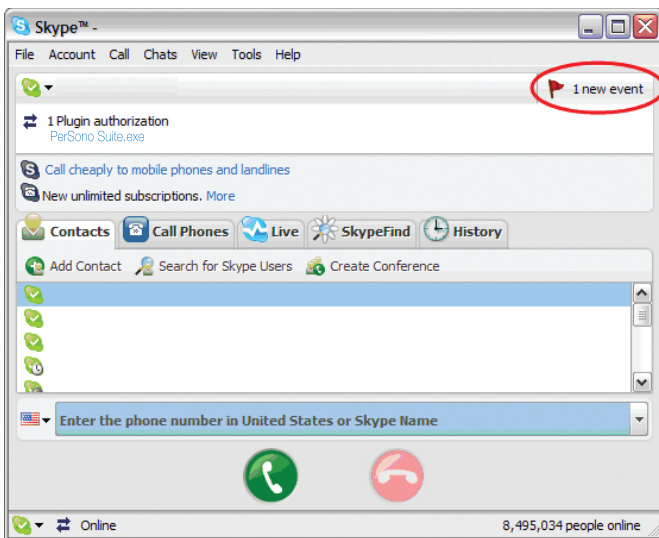

- 3 The “Manage API Access Control” screen will pop up stating that “Another program is trying to access Skype”. The name of the program will appear as “PerSonoSuite.exe” with the publisher “Plantronics, Inc.” You must select “Allow this program to use Skype” and click OK.

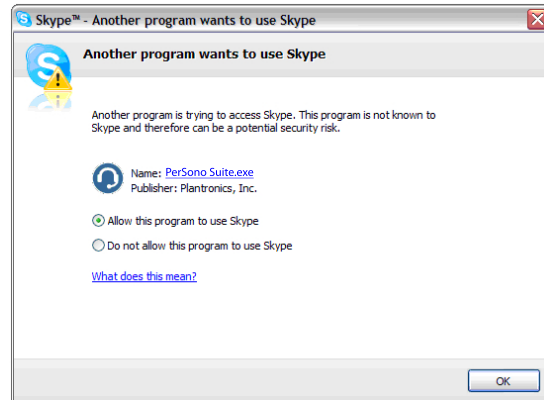

- 4 To confirm that PerSono Suite is now supporting Skype, go to the “PC Panel” tab in PerSono Suite and ensure that Skype is listed under “Softphones”.

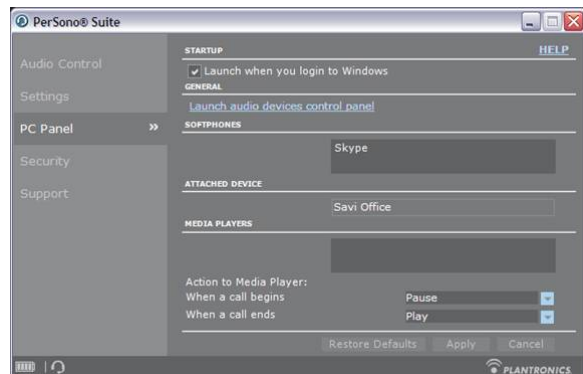

Settings screen – headset and base

The Settings screen allows you to customise the base and headset to your preference. The Savi Office system is supplied with the default settings and can be changed as described in the Settings column below.

NOTE Some parameters may appear as grayed out. PerSono Suite automatically grays out parameters that do not apply to a particular Plantronics device.

Settings – headset

	Feature	Settings	Default
	Mute tone	Standard/low/off	Standard
	Ring tone – desk phone	Sound 1/sound 2/sound 3	Sound 1
	Ring tone volume – desk phone	Standard/low/off	Standard
	Ring tone – PC	Sound 1/sound 2/sound 3	Sound 2
	Ring tone volume – PC	Standard/low/off	Standard
	System tones	Standard/low/off	Standard
	Second inbound call	Ring continuously/ring once/ignore	Ring continuously

Settings – base

	Feature	Settings	Default
General	Auto answer	On/off	Off
	Default Line	Desk phone/PC	Desk phone
	Over-the-Air subscription	On/off	On
	Range	High/med/low	High
	Ring both headset and PC	On/off	On
Audio	Anti-startle	On/off	Off
	Audio limiting	80 dB/85 dB/off	Off
	G616	On/off	Off
	Audio bandwidth – desk phone	Wideband/narrowband	Narrowband
	Audio bandwidth – PC	Wideband/narrowband	Narrowband
	Tone Control – desk phone	7 settings of bass/treble mix	Middle setting
	Tone Control – PC	7 settings of bass/treble mix	Middle setting

Help for base settings

Default settings

Auto answer Auto answer saves the user a button press to establish the radio link between headset and base unit. **Off**

When auto answer is set to OFF, you must press the headset call control button or base PC/desk phone talk button to answer an incoming call.*

When auto answer is set to ON, an incoming call will be answered when the headset is removed from the charging cradle.*

Default line Default line sets user preference for outbound desk phone or PC, when headset call control button is pressed. **Desk phone**

When default line is set to desk phone and you press the headset call control button to initiate a call, the desk phone will be taken off the hook. You then need to dial the phone number from the desk phone.*

When default line is set to PC and you press the headset call control button, an audio link will be brought up between your PC and headset. You then can place an outbound call via your soft phone application or listen to streaming audio via a media player.

Over-the-air subscription Over-the-air subscription allows a headset to be subscribed to the base without physically docking the headset. Required when conferencing various models of Plantronics Savi headsets. **On**

When over-the-air subscription is set to ON you can subscribe a headset to your base without physically docking the headset into the charging cradle.

When over-the-air subscription is set to OFF you can only subscribe a headset to the base by physically docking the headset into the charging cradle.

For information on how to subscribe a master headset to the base, see [Subscribing a master headset](#) on page 15.

For information on how to temporarily subscribe guest headsets to the base for a conference call, see [Conferencing in up to three additional headsets](#) on page 15.

Range** Range can be minimised to help with desk phone/PC buzzing, improve user density, or restrict range of users. **High**

When range is set to HIGH, a user will have up to 107 meters of range.

When range is set to MEDIUM, a user will have up to 45 meters of range.

When range is set to LOW, a user will have up to 15 meters of range.

Audio bandwidth** The system will support both narrowband and wideband audio from the desk phone and PC. **Narrowband desk phone and PC**

Wideband audio delivers heightened speech clarity and life-like fidelity. However, wideband audio consumes more battery power and has more stringent access criteria, which reduces the number of systems that can be deployed in a small area.

Your desk phone must support wideband audio to experience the benefit of selecting "wideband" for that device. All PCs support wideband audio.

When switching between narrowband and wideband audio, you must re-establish the audio link for the changes to take effect.

*Assumes use of lifter or EHS cable with desk phone and/or use of a softphone that is supported by PerSono Suite software.

** When bringing up a link from the base, the talk button will be solid yellow until a link is established. This could take up to several seconds especially for wideband audio and/or when in moderate to high density environments. If you press the talk button when the indicator light is yellow, it will terminate the search for an audio link.

Help for base settings

Default
Settings

Anti-startle	Anti-startle provides advanced hearing protection against sudden loud sounds. When Anti-startle is set to ON, the system identifies and eliminates sudden loud sounds and rapidly reduces them to a comfortable level. When Anti-startle is set to OFF, the headset caps sound levels at 118 dBA to protect your hearing.	Off
---------------------	---	------------

Audio limiting	Audio Limiting provides advanced hearing protection for daily noise exposure. When Audio Limiting is turned ON, the system monitors and controls sound to ensure action levels do not exceed 80 dBA or 85 dBA (whichever is selected) specified by current and imminent EU legislation*. When Audio Limiting is set to OFF, the headset caps sound levels at 118 dBA to protect your hearing.	Off
-----------------------	---	------------

*The noise monitoring feature is based on an average acoustic coupling between the headset and ear. Please follow the instructions for recommended wearing position on page 8.

G616	G616 Acoustic Limiting provides additional hearing protection against acoustic shock. When G616 Acoustic Limiting is set to ON, the system provides additional acoustic shock protection. Sound levels are limited to 102 dBA as recommended in the G616:2006 guideline issued by the Australian Communications Industry Forum (ACIF). When G616 Audio Limiting is set to OFF, the headset caps sound levels at 118 dBA to protect your hearing.	Off
-------------	--	------------

Tone control	The system allows you to customize the desk phone and PC tones independently to optimize your listening experience with just the right amount of treble and bass from each device.	Middle setting desk phone and PC
---------------------	--	---

Ring both headset and PC	This parameter gives you the option to have the PC ringtone played on both the headset as well as the PC speaker. When this parameter is set to OFF, the PC ringtone will only be heard on either the headset or the PC speaker based on how the PC audio has been set up. When this parameter is set to ON, the PC ringtone will be heard on both the PC speaker as well as the headset.	On
---------------------------------	---	-----------

PC panel screen

- Choose whether you want PerSono Suite software to launch when you login to Windows.
- See a list of supported softphones running on your PC.
- See which Plantronics device is attached to your PC and working with PerSono Suite software.
- Customise how you want the PerSono Suite software to manage your multimedia when a call begins/ends.

Advanced settings

Microsoft Office Communicator dial tone enabled

If this feature is set to ON, when a PC radio link is established, Microsoft Office Communicator will assume the user is trying to place a VOIP call and provide a dial tone.

If this feature is set to OFF, when a PC radio link is established, Microsoft Office Communicator will sit idle.

“Microsoft Office Communicator dial tone enabled” can be set to ON or OFF.

Microsoft Office Communicator certified product:
Default setting = ON

Standard product: Default setting = OFF

Audio sensing enabled

Audio sensing is a special feature supported by Plantronics wireless devices that can detect audio signal at the USB port and automatically establish a PC radio link between the base and wireless headset without the user having to press the PC call control button. If the parameter “Microsoft Office Communicator dial tone enabled” is set to ON, every time the user presses the PC call control button, the Microsoft Office Communicator dial tone will be heard. However, the user may have pressed the PC call control button to listen to music etc., and does not want to hear the dial tone. In this case, if the user sets the “Audio sensing enabled” parameter to “ON”, the radio link will be established automatically when any PC audio is detected at the USB port, thus eliminating the need for the user to press the PC call control button.

“Audio sensing enabled” can be set to ON or OFF.

Microsoft Office Communicator certified product:
Default setting = ON

Standard product: Default setting = OFF

Security screen

PerSono Suite software allows the base settings to be locked so another user cannot change the settings. This requires the creation of a password for the system. To create a password so you can lock/unlock base settings complete the following:

1 From the security screen, create and confirm your new password. Press OK.

A new security screen will appear.

2 Reenter your password.

3 Press OK.

This will bring up the base settings page.

4 Select your settings from the menu and lock/unlock each feature as desired.

5 Press Confirm to save the settings.

Once you have created your password, you can change your password as follows:

1 From the security screen, click the arrow to the right of “Reset Password”.

The security screen will expand.

2 Enter your current password, enter your new password, and reenter your new password.

3 Press Confirm to reset your password.

IMPORTANT If you forget your password you need to call your local Plantronics Technical Support for a skeleton password.

1 From the security screen, enter the skeleton password. Press OK.

The security screen will expand.

2 Reenter the skeleton password, enter your new password, and reenter your new password.

3 Press Confirm to reset your password.

NOTE You will not be able to access the base settings page using the skeleton password. You must first reset your password and then enter your new password to access the base settings page.

Support screen

The support screen provides on-line access to this printable user guide, frequently asked questions, how to contact Plantronics, and software upgrade information. The current version of software and firmware currently running on your system is also shown here.

Updates

All the required software and firmware for your Plantronics device can be remotely updated if and when updates are available. You can control how frequently the system will check for available updates. When updates are available, you can view all pending updates and decide when to download and install any one of them.

The particular version of PerSono Suite software and headset/base firmware running on your system is always reflected in the VERSIONS fields.

Notify me when updates are available: By enabling this check box, you will activate a periodic automatic check for available software and firmware updates.

When this parameter is enabled, automatic check for updates will be activated and the frequency field will be highlighted allowing you to choose the frequency of checking for updates, e.g., once every 3 months, once every month or once every week.

When this parameter is disabled, automatic check for software/firmware updates is disabled.

Check For Updates: You can choose to check for available software/firmware updates at any time by clicking on the Check For Updates button.

Available Updates: Following an automatic or manual check for updates, this field will be populated with any applicable software and firmware updates.

Install: It is important to note that automatic checks for updates does not include automatic download and install. The actual download and install will only occur when you select at least one item for the Available Updates list and click on this Install button.

9 Troubleshooting and common questions

I can't hear a dial tone at the headset.

Make sure your headset is charged.
Make sure your headset is subscribed to base. See [Subscribing a master headset](#) on page 15.
Press the call control button on your headset.
Make sure the lifter is lifting the handset high enough to operate the hookswitch; set to a higher setting if necessary.
Adjust the configuration switch on the base until a dial tone is heard.
Fine-tune the listening volume by pressing volume up [+] button on the headset.
If the volume is still too low, adjust the master listening volume on the base.
If the volume is still too low, adjust the desk phone listening volume on the base.

I hear static.

Make sure there is at least 30 cm between your base and your computer, and 15 cm between your base and your telephone. If adjusting the distance doesn't help, your headset is going out of range, move closer to the base.

The sound is distorted when using my Savi Office system with my desk phone.

Lower the desk phone speaking volume and/or Desk Phone Listening Volume on the base. For most telephones, the correct setting is position 3.
If your desk phone has a volume control, lower until the distortion disappears.
If the distortion is still present, adjust the headset volume control to lower the headset speaker volume. If the distortion persists, lower the Desk Phone Listening Volume on the base.
Make sure there is 30 cm between your base and your computer, and 15 cm between your base and your telephone.

I hear echo in the headset when using my desk phone.

Adjust the Configuration Switch. The most commonly used position is "A", which is the default position.
Lower the Desk Phone Listening Volume on the base. For most telephones, the correct setting is position 3.
If the audio level is too low in this position, adjust the headset volume control to increase the headset speaker volume.
Lower the Desk Phone Speaking Volume on the base. For most telephones, the correct setting is position 3.
If your speaking volume is too low for your listener in this position, adjust the position of the headset to make sure the microphone is as close as possible to your mouth.

People I talk to can hear a buzz in the background.

Move the base further away from your phone.
Base power supply is plugged into a power strip. Plug the power supply into the wall directly.

Talk time performance is significantly degraded even after a full recharge.

Battery is wearing out. Contact www.plantronics.com/support for factory service information.

The handset lifter is installed, but does not lift the handset.

Ensure the handset lifter power cord is firmly pushed into the handset lifter jack on the base.

I can no longer hear any audio through my PC speakers.

For Windows XP Systems:

Refer to the “Audio” tab of the “Sounds and Audio Devices” option in your PC Control Panel.

- Under “Sound playback” change the default setting from Savi Office to your PC speakers. Click “OK” to confirm your change.

For Windows Vista Systems:

Refer to the “Sound” option in your PC Control Panel.

- Under the “Playback” tab change the default setting from “Speakers Savi Office” to your PC speakers. Click “OK” to confirm your change

No audio connection to PC.

Unplug USB and power cables from base. Reconnect power cable first. Wait for power LED to illuminate, then re-connect USB cable. Quit and then restart your PC audio or softphone application.



Plantronics, Inc.

345 Encinal Street

Santa Cruz, CA 95060

United States

www.plantronics.com

For product support, contact us at www.plantronics.com/support.

© 2010 Plantronics, Inc. All rights reserved. Plantronics, the logo design, HL10, Persono Suite, Savi, and Sound Innovation are trademarks or registered trademarks of Plantronics, Inc. Windows is a registered trademark of Microsoft Corporation. Nortel is a trademark of Nortel Networks. Skype is a registered trademark of Skype Limited. All other trademarks are property of their respective owners.

Patents US 5,210,791; D539,266; D469,756; Australia 147229; France 651,857-651,865; Germany 40108524.4; GB Regd.Des.No. 2104923; Patents Pending.

82213-17(01.10)

Free Manuals Download Website

<http://myh66.com>

<http://usermanuals.us>

<http://www.somanuals.com>

<http://www.4manuals.cc>

<http://www.manual-lib.com>

<http://www.404manual.com>

<http://www.luxmanual.com>

<http://aubethermostatmanual.com>

Golf course search by state

<http://golfingnear.com>

Email search by domain

<http://emailbydomain.com>

Auto manuals search

<http://auto.somanuals.com>

TV manuals search

<http://tv.somanuals.com>