

# SCOOBY-DOO!™

Shower Radio  
USE & CARE GUIDE  
MODEL SD8SR



Congratulations! You are the proud owner of the Scooby Doo Shower Radio. To obtain maximum satisfaction and enjoyment, please follow these simple guidelines.

1. **Do not submerge the Scooby Doo Shower Radio in water.** It is water resistant, not waterproof!
2. **Insert 3 AA ALKALINE batteries (not included) into the Battery Compartment.**
3. **Signal Reception.**

Turn on the Radio and move it around to various locations and positions on the wall to determine a suitable location that provides good reception.

Avoid locations that lie directly in the path of the shower stream.

## OPERATING INSTRUCTIONS

PRODUCT MAY VARY SLIGHTLY FROM ILLUSTRATIONS

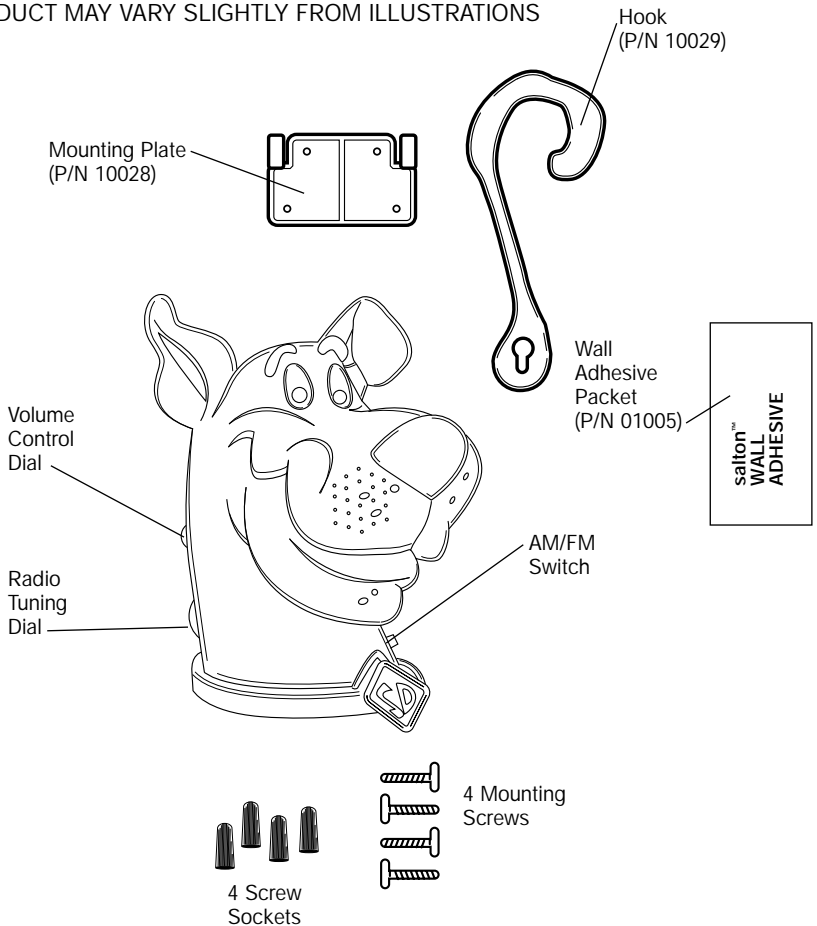

## INSTALLATION OPTIONS: ATTACHING THE HOOK

1. Put the Hook Screw into the round hole on the Hook and then lift the Hook upwards until the Screw slides into the smaller groove on the Hook.
2. Place Hook with Radio securely attached onto your shower head pipe.

## WALL MOUNTING WITH ADHESIVE

1. Select a spot on the wall that is as smooth as possible, such as a smooth ceramic tile. Thoroughly clean the spot of all soap, oil or other films using a household cleaning solvent such as Acetone or nail polish remover. DO NOT use tile cleaner or other wax-based substances. Allow area to dry completely. Room temperature should be at 60 to 70°F.
2. For best results, hold Wall Adhesive Packet (supplied in package) at a 45-degree angle and apply sealant to Mounting Plate, approximately 1/8" bead and 1/4" from edges. Use entire contents.
3. Place Mounting Plate against clean wall surface using enough pressure to displace air, but not adhesive.
4. Allow the Adhesive to cure for 24 hrs.
5. Slide the Radio onto the secured Mounting Plate.

## WALL MOUNTING WITH SCREWS

1. Place Mounting Plate against a clean wall surface and mark the spots on the wall where you will be drilling. Remove the Mounting Plate from the wall.
2. Drill 4 holes in the wall that match the placement of the holes in the Mounting Plate.
3. Insert a Screw Socket into each of the 4 holes.
4. Place Mounting Plate against the wall in the correct position and drill in the 4 Screws.
5. Slide the Radio onto the secured Mounting Plate.



4 Screw  
Sockets



4 Mounting  
Screws

## ATTACHING THE HOOK

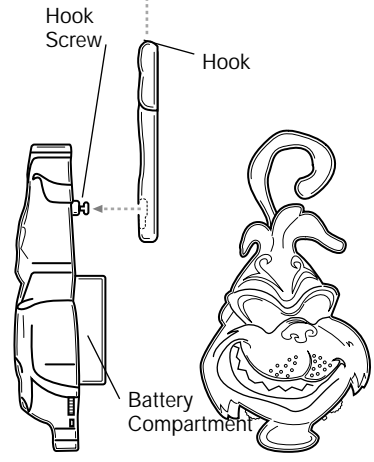

## WALL MOUNTING WITH ADHESIVE

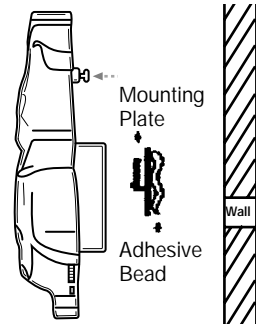

## WALL MOUNTING WITH SCREWS

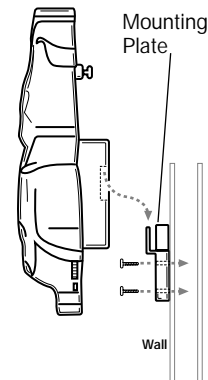

# LIMITED ONE YEAR WARRANTY

**Warranty:** This product is warranted by Salton, Inc. to be free from defects in materials or workmanship for a period of (1) year from the original purchase date. This product warranty covers only the original consumer purchaser of the product.

**Warranty Coverage:** This warranty is void if the product has been damaged by accident in shipment, unreasonable use, misuse, neglect, improper service, commercial use, repairs by unauthorized personnel, normal wear and tear, improper assembly, installation or maintenance abuse or other causes not arising out of defects in materials or workmanship. This warranty is effective only if the product is purchased and operated in the USA, and does not extend to any units which have been used in violation of written instructions furnished with the product or to units which have been altered or modified or to damage to products or parts thereof which have had the serial number removed, altered, defaced or rendered illegible.

**Implied Warranties:** ANY IMPLIED WARRANTIES WHICH THE PURCHASER MAY HAVE ARE LIMITED IN DURATION TO ONE (1) YEAR FROM THE DATE OF PURCHASE. Some states do not allow limitations on how long an implied warranty lasts, so the above limitation may not apply to you.

**Warranty Performance:** During the above one-year warranty period, a product with a defect will be either repaired or replaced with a reconditioned comparable model (at our option) when the product is returned to the Repair Center, or the purchase price refunded. The repaired or replacement product will be in warranty for the balance of the one-year warranty period and an additional one-month period. No charge will be made for such repair or replacement.

**Service and Repair:** Should the appliance malfunction, you should first call toll-free 1 (800) 233-9054 between the hours of 9:00 am and 5:00 pm Central Standard Time and ask for CONSUMER SERVICE stating that you are a consumer with a problem. Please refer to model number SD8SR when you call.

**In-Warranty Service (USA):** For an appliance covered under the warranty period, no charge is made for service or postage. Call for return authorization 1 (800) 233-9054.

**Out-of-Warranty Service:** A flat rate charge by model is made for out-of-warranty service. Include \$6.00 (U.S.) for return shipping and handling. We will notify you by mail of the amount of the charge for service and require you to pay in advance for the repair or replacement.

**For Products Purchased in the USA, but Used in Canada:** You may return the product insured, packaged with sufficient protection, and postage and insurance prepaid to the USA address listed below. Please note that all customs duty / brokerage fees, if any, must be paid by you and we will require you to pay the cost of customs duty / brokerage fees to us in advance of our performing any service.

**Risk During Shipment:** We cannot assume responsibility for loss or damage during incoming shipment. For your protection, carefully package the product for shipment and insure it with the carrier. Be sure to enclose the following items with your appliance: any accessories related to your problem, your full return address and daytime phone number, a note describing the problem you experienced, a copy of your sales receipt or other proof of purchase to determine warranty status. C.O.D. shipments cannot be accepted.

**To return the appliance, ship to:**

ATTN: Repair Center  
Salton, Inc.  
708 South Missouri Street  
Macon, MO 63552

**To contact us, please write to, call, or email:**

Salton, Inc.  
P.O. Box 7366  
Columbia, MO 65205-7366  
1-800-233-9054  
E-mail: Salton@Saltonusa.com

**Limitation of Remedies:** No representative or person is authorized to assume for Salton, Inc. any other liability in connection with the sale of our products. There shall be no claims for defects or failure of performance or product failure under any theory of tort, contract or commercial law including, but not limited to negligence, gross negligence, strict liability, breach of warranty and breach of contract. Repair, replacement or refund shall be the sole remedy of the purchaser under this warranty, and **in no event shall Salton be liable for any incidental or consequential damages, losses or expenses.** Some states do not allow the exclusion or limitation of incidental or consequential damages, so the above limitation or exclusion may not apply to you.

**Legal Rights:** This warranty gives you specific legal rights, and you may also have other rights which vary from state to state.

For more information on Salton products: visit our website: [www.salton-maxim.com](http://www.salton-maxim.com)

**NOTE:** Trademarks are used under license and should not be copied or used in any way without prior permission from the Licensor and/or Licensee.

TM & © 2001 Hanna-Barbera



WB SHIELD: TM & ©2001 Warner Bros.  
(s01)

©2001 Salton, Inc. All rights reserved.

Made in China

P/N 60831

08/01

## Free Manuals Download Website

<http://myh66.com>

<http://usermanuals.us>

<http://www.somanuals.com>

<http://www.4manuals.cc>

<http://www.manual-lib.com>

<http://www.404manual.com>

<http://www.luxmanual.com>

<http://aubethermostatmanual.com>

Golf course search by state

<http://golfingnear.com>

Email search by domain

<http://emailbydomain.com>

Auto manuals search

<http://auto.somanuals.com>

TV manuals search

<http://tv.somanuals.com>