

	Page
BEFORE USE	2
SPECIFICATIONS	2
TILT DISPLAY	2
OPERATIONS	2
STATUS DISPLAY AND COUNTER	3
CHECK & CORRECT	3
Auto replay	3
Preview/Next	4
Correct	4
Insert	5
Delete	5
REPEAT ENTRY	6
CHANGE	6
LAST ANSWER FUNCTION	7
ANSWER CHECK (COMPARISON)	8
CALCULATING TAX	9
BASIC CALCULATIONS	10
BATTERY REPLACEMENT	12

BEFORE USE

- Do not press too hard against the LCD panel because it contains glass.
- Never dispose of battery in fire.
- Keep battery out of reach of children.
- Do not use or store the calculator where fluids can splash onto it.
- Please press **C-CE** if you see **no** indication.
- When "0.E" is displayed, calculation formulae stored in memory will be cleared.
- The maximum number of calculation steps that can be stored is 102.
- This product, including accessories, may change due to upgrading without prior notice.

SPECIFICATIONS

Type: Electronic calculator
 Operating capacity: 12 digits
 Power supply: Built-in solar cell and Lithium battery (3V (DC) CR2032 × 1)

Automatic Power-off: Approx. 5 min.
 Operating temperature: 0°C - 40°C (32°F-104°F)
 Dimensions: 130 mm(W) × 209 mm(D) × 21 mm(H)
 5-1/8"(W) × 8-7/32"(D) × 13/16"(H)

Weight: Approx. 215 g (0.47 lb.) (with battery)
 Accessories: Lithium battery (installed), Operation manual

STATUS DISPLAY AND COUNTER

(1) 23 2 4 11.5 **F543210A**

(2)	(3)
C-CE C-CE 00	0
23	23
x	23
2	2

÷	02	46
4	03	4
=	04	15

CHECK & CORRECT

Auto replay (**AUTO REPLAY**)

- Auto Scroll starts by pressing **AUTO REPLAY** and you can recall a calculation formula automatically.
- Auto Scroll stops by pressing **AUTO REPLAY** during Auto Scroll and pressing **AUTO REPLAY** again starts Auto Scroll to resume.

(1) (400 80 500) 3 2460 **F543210A**

(2)	(3)
C-CE C-CE 05	2460
400 - 80 +	=
500 x 3 =	
AUTO REPLAY	01 PLAYBACK
	02 PLAYBACK

AUTO REPLAY	03 PLAYBACK	500
AUTO REPLAY	04 PLAYBACK	3
AUTO REPLAY	05 PLAYBACK	2460

- 1 -

PRINTED IN CHINA
01BT(TINSE0471EHZZ)

Preview/Next (**PREV** / **NEXT**)

- Each time **NEXT** is pressed, calculation formulas are recalled in the order they are entered, while each time **PREV** is pressed, calculation is recalled in the order of its answer.

(1) (400 80 500) 3 2460 **F543210A**

(2)	(3)
C-CE C-CE 05	2460
400 - 80 +	=
500 x 3 =	
PREV	05 PLAYBACK
PREV	04 PLAYBACK

PREV	03 PLAYBACK	500
PREV	02 PLAYBACK	80
PREV	01 PLAYBACK	400

Correct (**CORRECT**)

(1) (400 80 500) 3 (400 100 500) 3 2400 **F543210A**

(2)	(3)
C-CE C-CE 05	2460
400 - 80 +	=
500 x 3 =	
NEXT	01 PLAYBACK
NEXT	02 PLAYBACK
CORRECT	02 PLAYBACK CORRECT
100	02 PLAYBACK CORRECT

CORRECT	02 PLAYBACK	100
NEXT AUTO REPLAY	03 PLAYBACK	500
NEXT AUTO REPLAY	04 PLAYBACK	3
NEXT AUTO REPLAY	05 PLAYBACK	2400

- 4 -

TILT DISPLAY

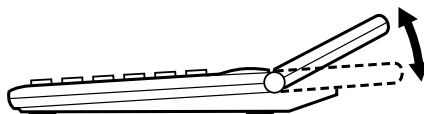

OPERATIONS

- Before starting calculations, press **CA** to clear (zero-clear).
- The position of any switch that is not specifically designated, may be set to any position.
- For expressing calculation examples, only the symbols that are required for explanation are mentioned.
- Example procedures are listed in following manner unless otherwise specified.

(1) Example (2) Key operations (3) Display

- 2 -

Insert (**INS**)

(1) (400 80 500) 3 (400 80 500) 2 3 1230 **F543210A**

(2)	(3)
C-CE C-CE 05	2460
400 - 80 +	=
500 x 3 =	
PREV	05 PLAYBACK
PREV	04 PLAYBACK
INS	04 PLAYBACK CORRECT INSERT
÷	04 PLAYBACK CORRECT INSERT

2	04 PLAYBACK CORRECT INSERT	2
CORRECT	04 PLAYBACK	2
NEXT AUTO REPLAY	05 PLAYBACK	3
NEXT	06 PLAYBACK	1230

Delete (**DEL**)

(1) (400 80 500) 3 (400 500) 3 2700 **F543210A**

(2)	(3)
C-CE C-CE 05	2460
400 - 80 +	=
500 x 3 =	
NEXT	01 PLAYBACK
NEXT	02 PLAYBACK

DEL	02 PLAYBACK	500
NEXT AUTO REPLAY	03 PLAYBACK	3
NEXT	04 PLAYBACK	2700

- To check a calculation formula after performing the Correct, Insert and Delete function, press **NEXT** / **PREV** repeatedly or press **AUTO REPLAY**.

- 5 -

REPEAT ENTRY

- This function is used for entering the same calculation formula repeatedly.

(1) 4.95 2.55 2.55 12.6 **F543210A**

(2)	(3)
C-CE C-CE 00	0
4.95 +	+
2.55	2.55

REPEAT	03	255
REPEAT	04	255
=	05	126

CHANGE

- This is used for determining the amount of change.

(1) \$130.00 is paid for a \$126.00 purchase.
How much change should be returned?

(2)	(3)	
C-CE C-CE 03	126	
126 =	=	
130	130	
CHANGE	05	4

REPEAT	03	255
REPEAT	04	255
=	05	126

Be sure to press **=** immediately after entering a number.

(1) \$50 is paid for a total purchase of \$48.70.
What is the amount of change?

(2)	(3)	
C-CE C-CE 03	48.7	
23.5 + 25.2	=	
50	50	
CHANGE	05	13

CHANGE	05	4
---------------	----	---

- 6 -

LAST ANSWER FUNCTION

- This function stores the result of the last calculation (result obtained by Pressing [=]).
- After performing the calculation 1+7=8, the result "8" can be used in The next calculation such as: $\frac{64}{1+7}$

F 5 4 3 2 1 0 A

(2)	(3)
CCE CCE 1 + 7	02 + 7
=	03 =
64 (x) 2 (+)	05 + 128
ANS	06 + 8
=	07 - 16

• By pressing [=], a new calculation is performed. Therefore, the number stored in the last answer memory changes to "16" since it is the newest calculation result.

- The last answer function uses only one memory location to store one number. This memory is always stored with the latest calculation result.

ANSWER CHECK (COMPARISON)

- If the answer obtained with [=], [%] agrees with the succeeding tested result, "OK" will be displayed.
- Pressing [CA] will clear the previous calculated result, disabling the comparison.
- Comparison with the counter or values of memory calculation, or comparison during calculation process will not be performed.
- The Answer Check function is not available for tax rate calculations and change calculations.

GT ANSWER CHECK F 5 4 3 2 1 0 A ±54↑

(1) 120 3652 670 258 438652	(2)	(3)	
	CCE CCE	00	
120 (x)	01 x	120	First calculation
3652 (+)	02 +	438240	
670 (-)	03 -	438910	
258 (=)	05 =	438652	
	CCE CCE	00	
120 (x)	03 x	438910	Second calculation
3652 (+)	04 +	438652	
670 (-)	05 -	438652	
258 (=)	05 =	438652	

Displayed when agrees with the previous calculated result. (Not displayed if disagrees.)

CALCULATING TAX

- To perform a tax calculation, first it is absolutely necessary to set and check the tax rate. (The initial tax rate is 0.)
- A tax rate can be set (or changed) with a number containing up to four digits. (Decimal point is not regarded as a digit.)
- The set tax rate is retained until it is changed. However, the set tax rate may be changed or lost if the battery is consumed largely.

- Confirming the tax rate. (0%)

F 5 4 3 2 1 0 A

(2)	(3)
CCE CCE RATE RECALL -TAX	01 =

- Set a 5% tax rate. Calculate the tax on \$800 and calculate the total Including tax.

F 5 4 3 2 1 0 A

(2)	(3)
CCE CCE	00
BASE SET +TAX 5	01 =
RATE SET +TAX	01 =
CCE CCE 800	02 =
+TAX	02 =
+TAX	03 =

- 7 -

- Perform two calculations using \$840 and \$525, both of which already include tax. Calculate the tax on the total and the total without tax.

F 5 4 3 2 1 0 A

(2)	(3)
CCE CCE 840 (+) 525	03 =
=	03 =
-TAX	04 =
-TAX	05 =

- 8 -

9 ÷ 36 = 25 (%)	9 (+) 36 (%)	25.
200 + (200 × 10%) = 220	200 (+) 10 (%)	220.
4 ⁶ = (4 ³) ² = 4096	4 (x) (=) (=) (x) (=)	4 096.
1/8 = 0.125	8 (+) (=)	0.125
25 × 5 = 125	(CM) 25 (x) 5 (M+)	125. ^M
-) 84 ÷ 3 = 28	84 (+) 3 (M-)	28. ^M
+) 68 + 17 = 85	68 (+) 17 (M+)	85. ^M
182	(RM)	182. ^M
2 + 3 → 2 + 4 = 6	2 (+) 3 (C) (=) 4 (=)	6.
5 × 2 → 5 ÷ 2 = 2.5	5 (x) (+) 2 (=)	2.5
123456 → 123478	123456 (M) (=) 78	123 478.
987654320988 ÷ 0.444 × 555 = 1234.56790123 × 10 ¹²	987654320988 (÷) 0.444 (x) (C) 555 (=)	2.22444666889 E 1234.56790123
	(1234.56790123 × 10 ¹² = 1234567901230000)	
GT ANSWER CHECK F 5 4 3 2 1 0 A ±54↑		
23.5 + 42.3 = 65.8	(GT) 23.5 (+) 42.3 (=)	65.8 ⁰
72.4 - 37.321 + 12 = 47.08	72.4 (-) 37.321 (+) 12 (=)	47.08 ⁰
+) 27 - 19 - 21.61 = -13.61	27 (-) 19 (-) 21.61 (=)	-13.61 ⁰
99.27	(GT)	99.27 ⁰
F 5 4 3 2 1 0 A		
1 \$ 45¢	145 (+)	1.45
45 \$ 00¢	4500 (-)	46.45
-7 \$ 63¢	763 (=)	38.82
38 \$ 82¢		

Note: (C) was not used in the entries.

- 9 -

BATTERY REPLACEMENT

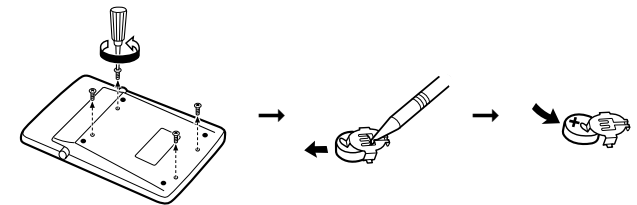

BASIC CALCULATIONS

F 5 4 3 2 1 0 A

(1)	(2)	(3)
	CCE (CA)	0.
(-24+2) ÷ 4 = -5.5	(-) 24 (+) 2 (+) 4 (=)	-5.5
13 × (-4) + 2 = -26	13 (x) 4 (-) 2 (+) 2 (=)	-26.
34 + 57 = 91	34 (+) 57 (=)	91.
45 + 57 = 102	45 (=)	102.
38 - 26 = 12	38 (-) 26 (=)	12.
35 - 26 = 9	35 (=)	9.
68 × 25 = 1700	68 (x) 25 (=)	1 700.
68 × 40 = 2720	40 (=)	2 720.
35 ÷ 14 = 2.5	35 (÷) 14 (=)	2.5
98 ÷ 14 = 7	98 (=)	7.
200 × 10% = 20	200 (x) 10 (%)	20.

- 10 -

- 11 -

- 12 -

VX-792C(U1E)-2①

SHARP

SHARP ELECTRONICS CORPORATION
Sharp Plaza, Mahwah, New Jersey 07430-2135

SHARP CORPORATION

Free Manuals Download Website

<http://myh66.com>

<http://usermanuals.us>

<http://www.somanuals.com>

<http://www.4manuals.cc>

<http://www.manual-lib.com>

<http://www.404manual.com>

<http://www.luxmanual.com>

<http://aubethermostatmanual.com>

Golf course search by state

<http://golfingnear.com>

Email search by domain

<http://emailbydomain.com>

Auto manuals search

<http://auto.somanuals.com>

TV manuals search

<http://tv.somanuals.com>