

AudioSource®

S3D60



Basic Sound Bar Installation Tablet PC / MP3 Player / Cell Phone to S3D60

Tablet PC



S3D60 Input / Output Section

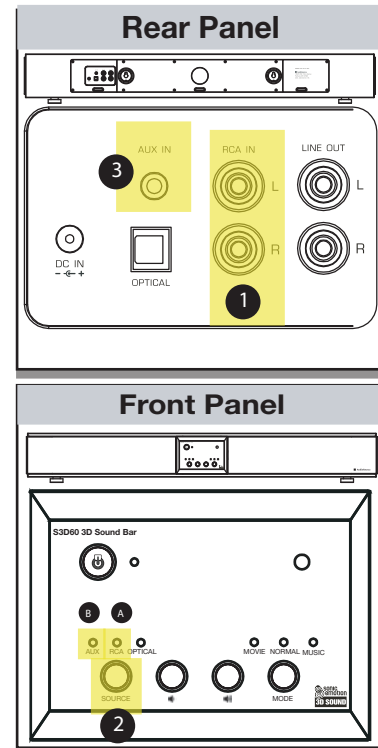

Option 1

- 1 Connect the Headphone OUTPUT of the device to the RCA INPUT of the S3D60 using a 3.5mm to RCA Cable
- 2 Using the source button on the front panel of the S3D60 select RCA Input **A**

Option 2

- 3 Connect the Headphone OUTPUT of the device to the Aux INPUT of the S3D60 using a 3.5mm Mini Cable
- 2 Using the source button on the front panel of the S3D60 select AUX Input **B**

Option 1 3.5mm Mini to RCA Cable



Option 2 3.5mm Mini to Mini Cable



Free Manuals Download Website

<http://myh66.com>

<http://usermanuals.us>

<http://www.somanuals.com>

<http://www.4manuals.cc>

<http://www.manual-lib.com>

<http://www.404manual.com>

<http://www.luxmanual.com>

<http://aubethermostatmanual.com>

Golf course search by state

<http://golfingnear.com>

Email search by domain

<http://emailbydomain.com>

Auto manuals search

<http://auto.somanuals.com>

TV manuals search

<http://tv.somanuals.com>