

DSP-5

instructions



Brady Worldwide Identification Solutions

6555 West Good Hope Road

P.O. Box 2131

Milwaukee, WI 53201-2131

Phone: (800) 537-8791

Fax: (800) 292-2289

www.bradyid.com

05/01



CONTENTS

Read this user's manual before use to ensure proper operation. Keep the manual on hand for reference in case there is a problem.

Warranty Information	2
Features	3
Notes	3
Repair Policy	3
Specifications	3
Set-up	4
Operation/Adjustments	5
Maintenance	6
Legend	6
Exploded View	7

WARRANTY POLICY FOR DSP SERIES LABEL DISPENSERS

Brady Corporation warrants all parts on DSP series label dispensers against defects in design, materials and workmanship for a period of 180 days. Labor to replace defective parts will be performed at no charge for the first 90 days after date of purchase. Warranty does not cover transportation costs.

Our sole obligation under this warranty is limited to repair, replacement or credit of the purchase price, at our option, for the machines listed above, which do not perform properly the function for which they were designed.

Warranty repair is contingent upon our examination and determination that alleged defects have not been caused by misuse, abuse, improper installation or application, repair, alteration, accident or neglect in use, storage, transportation or handling.

The above warranty and remedy constitutes Brady Corporation's sole liability hereunder and are in lieu and exclusive of all other warranties and remedies expressed, implied, or statutory, including, but not limited to, those of merchantability and fitness for a particular purpose.

EXPLODED VIEW

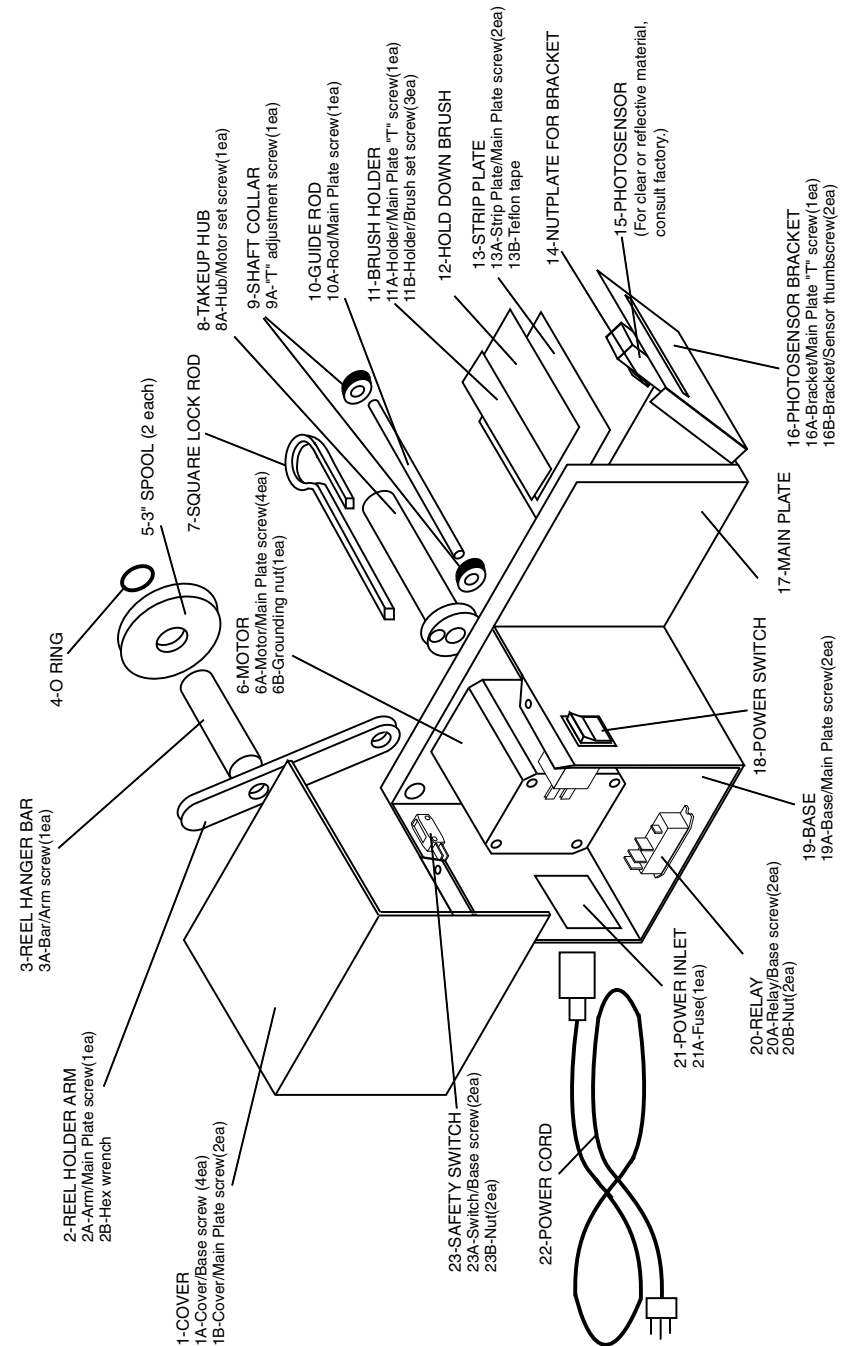

SET-UP INSTRUCTIONS

Using 5/32" (4mm) hex wrench, adjust reel holder arm to vertical.

Place the label roll on the 1" (25mm) reel hanger bar.

If roll has 3" (76.2mm) core, use plastic spool

Slide "O" ring onto reel hanger bar to hold roll against reel holder arm to ensure it is held straight.

(Hex wrench, O-ring and spool included.)

Thread the liner under the guide rod, between the hold down brush and the strip plate, then back under the strip plate. Lay the liner across the slot in the take-up hub. Slide the lock rod into the slot to secure the liner. Align shaft collar on guide rod with edge of liner to keep material feeding straight.

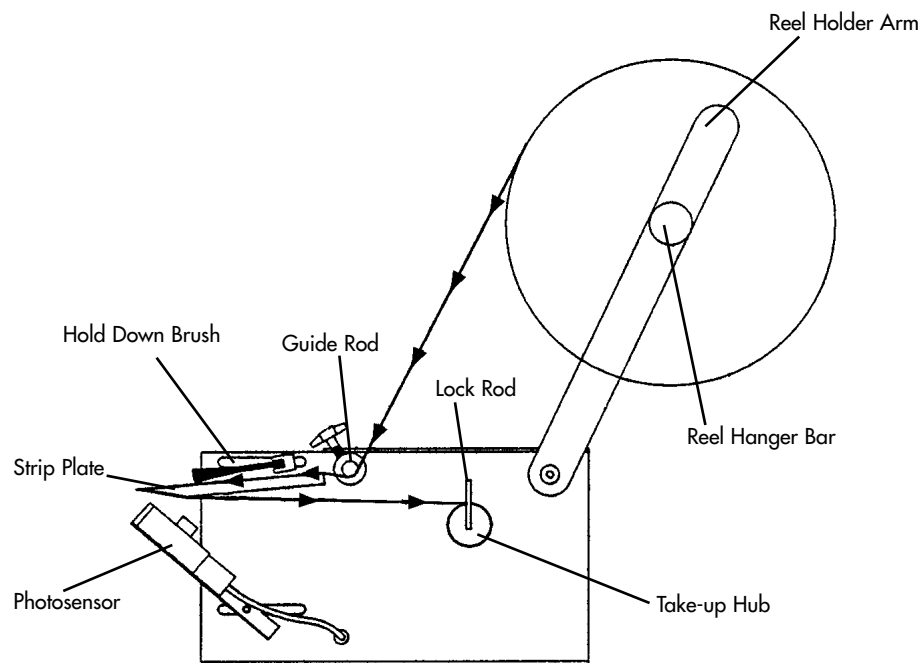

ADJUSTMENTS

Hold Down Brush:

Using the upper thumbscrew on the side of the machine, adjust the hold down brush for tensioning.

For best results, labels should be pressed firmly against the strip plate. If labels are held too tightly, they will cause excessive drag on the motor.

Photosensor:

The photosensor can be adjusted in any direction to accommodate virtually any label. Loosening the lower thumbscrew allows the photosensor to swivel and sets the overhang distance of the label over the strip plate. When the label is being fed the correct distance, tighten the lower thumbscrew.

Loosen the two screws on the front of the sensor holder to align the photosensor with the center of the label. If there are two or more labels across, align the photosensor with the last label to be removed. When these two screws are tightened, the machine is set.

Positioning of Photosensor

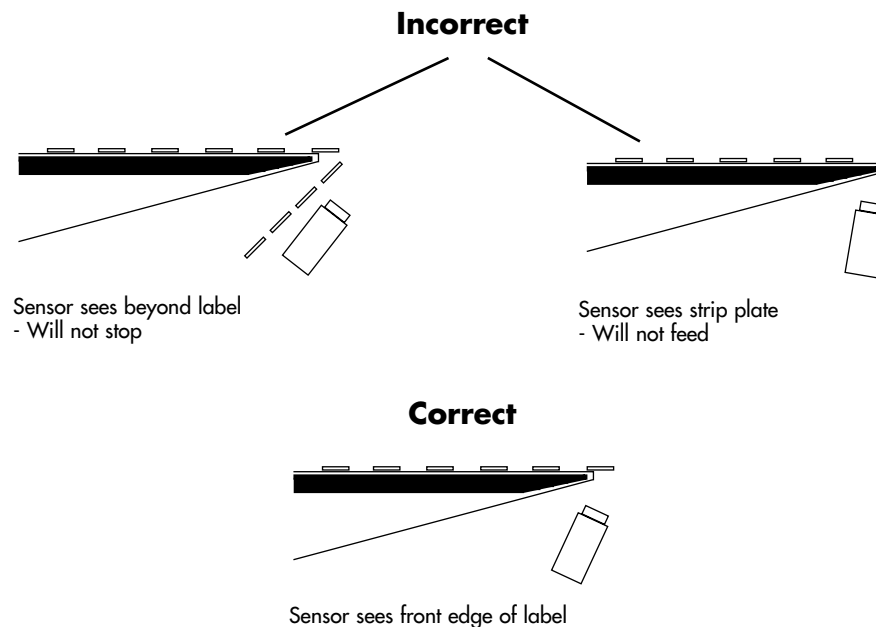

MAINTENANCE

Turn machine off when not in use. Remove liner material from take-up hub at approximately 3" in diameter or if motor appears to be straining. Do not operate machine without covers in place. Do not operate if inspection reveals a damaged power or sensor cord.

LEGEND	
Model DSP-5	
Item #	Part #
1	NV50008
1A	NV50008-1
1B	NV50008-2
2	NV50010
2A	NV50010-1
2B	NV50010-2
3	NV50017
3A	NV50017-1
4	NV50017-2
5	NV-SPOOL
6	NV50001A (115V) NV50001C (220V)
6A	NV50001-1
6B	NV50018-2
7	NV50013A
8	NV50012
8A	NV50012-1
9	NV50014-1
9A	NV50014-3
10	NV50014
10A	NV50017-1
11	NV50026B
11A	NV50011-2
11B	NV50026-1
12	NV50026A
13	NV50015
13A	NV50017-1
13B	NV50015A
14	NV50011A
15	NV50002A
16	NV50011
16A	NV50011-2
16B	NV50011-1
17	NV50007
18	NV50003
19	NV50009
19A	NV50007-1
20	NV50021 (115V) NV50021A (220V)
20A	NV50005-1
20B	NV50021-1
21	NV50019
21A	NV50019F
22	NV50018C
23	NV50005
23A	NV50005-1
23B	NV50021-1

FEATURES

- Will dispense butt-cut and die-cut material.
- Adjustable photosensor for pinpoint accuracy.
- Handled lock rod makes scrap removal easy.
- No tools required for adjustment.

NOTES

- Keep strip plate free of adhesive build-up.
- Clean photosensor with compressed air or dry cloth.
- Do not drop the dispenser or subject it to heavy shock.
- Turn off machine when not in use.

REPAIR POLICY

Contact BRADY CORPORATION to determine nature of problem.

Furnish Brady with the following information:

1. Who the unit was purchased from.
2. Model number and serial number.
3. Date purchased (copy of invoice or packing slip required).

Brady will issue an RGA (Return Goods Authorization) for repair. Return machine to Brady by UPS, insured and prepaid. Brady will notify the customer if there is a repair charge.

SPECIFICATIONS:	
Model#	DSP-5
Liner Capacity Width	.25" to 4.5" (6.35mm to 115mm)
Label Length	.125" to 7" (3.2mm to 178mm)
Roll Capacity	12" (30.5mm)
Feed Speed	1.3" / sec* (3.3mm / sec.)
Dimensions Inches	10.8 (L) x 10.8 (W) x 14.5 (H)
Centimeters	27.4 (L) x 27.4 (W) x 36.8 (H)
Weight	10.5 lb. (4.76 kg.)
Electrical Requirements	117V 50/60Hz, <1 amp (220V 50/60Hz available)

*at start-up

Free Manuals Download Website

<http://myh66.com>

<http://usermanuals.us>

<http://www.somanuals.com>

<http://www.4manuals.cc>

<http://www.manual-lib.com>

<http://www.404manual.com>

<http://www.luxmanual.com>

<http://aubethermostatmanual.com>

Golf course search by state

<http://golfingnear.com>

Email search by domain

<http://emailbydomain.com>

Auto manuals search

<http://auto.somanuals.com>

TV manuals search

<http://tv.somanuals.com>