

Part Number P707-MDEH1

SAFETY CONSIDERATIONS

Installing, starting up, and servicing equipment can be hazardous due to system pressures, electrical components and equipment location (roofs, elevated structures, etc.). Only trained, qualified installers and service mechanics should install, start up, and service this equipment.

When working on the equipment, observe precautions in the literature and on tags, stickers, and labels attached to the equipment.

⚠ WARNING

Before installation, always check to be sure main power to systems are OFF. Electrical shock can cause personal injury or death.

GENERAL

The MDEH1 dehumidistat is used with Totaline SHR series heat recovery ventilators. See Fig. 1. The dehumidistat is used to control the indoor humidity level. High humidity is a major

cause of structure damage and IAQ problems such as mold and mildew.

INSTALLATION

NOTE: For technical assistance, call 1-800-747-1762.

To install the dehumidistat, perform the following procedure:

1. Determine the mounting location for the dehumidistat. Location should be in an easily accessible area. Do not locate where humidity sensor could be affected by direct humidity sources.
2. All controls are low voltage. Use 22 to 26 gage field-provided wire.
3. Connect two wires to the DEHUM terminals on ventilator. See Fig. 2. Polarity does not matter. Either wire can be connected to either terminal.
4. Run wire to mounting location. Do not run control wire with power wiring. Interference from power wiring can cause changes to control signal.

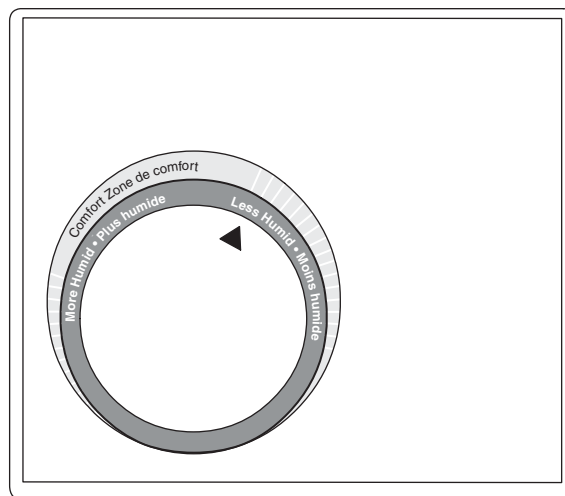

Fig. 1 — Dehumidistat

5. The dehumidistat consists of two pieces, a mounting plate and the cover. Remove cover from the mounting plate. Pull wiring through the hole in the mounting plate.
6. Connect wiring to the terminals on the mounting plate of the dehumidistat. Two spade connector are provided in the dehumidistat for wiring connections. See Fig. 3.
7. Mount the dehumidistat on the wall with the two screws and wall anchors provided.
8. Snap on the cover on the mounting plate.

OPERATION

When the dehumidistat is installed, the humidity dial should be set to the desired level. When the indoor humidity level at the dehumidistat is exceeded, the ventilator will go into Override mode. Override mode will continue until relative humidity drops below the set point of the dehumidistat.

It is not necessary to change the humidity setting every day. To avoid window condensation, monitor the average weekly temperature to find a comfortable level. Adjust the control when needed.

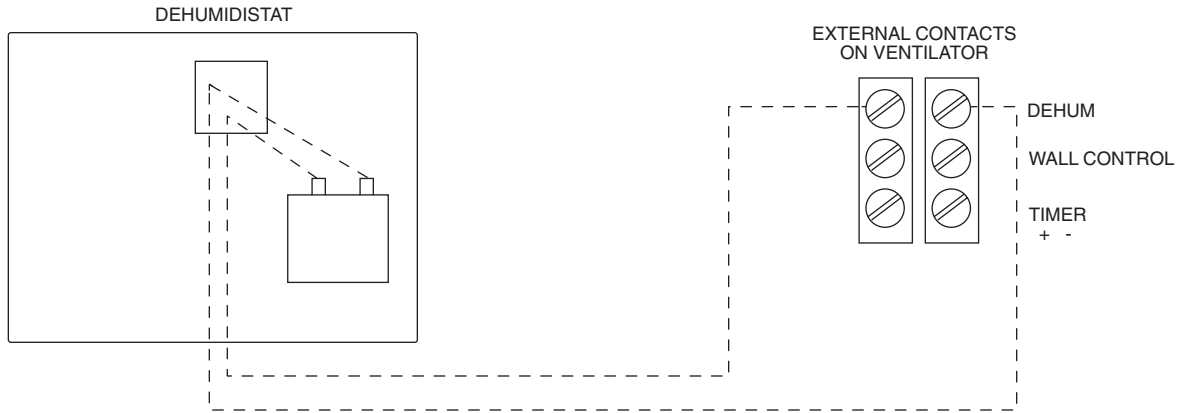

Fig. 2 — Dehumidistat Wiring

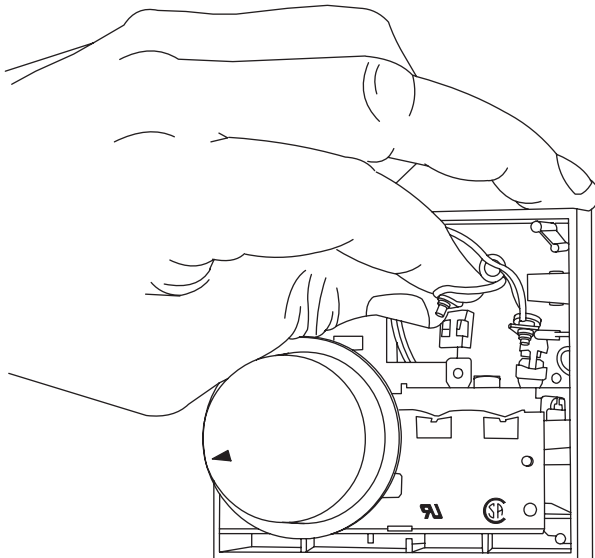

Fig. 3 — Dehumidistat Terminal Connections

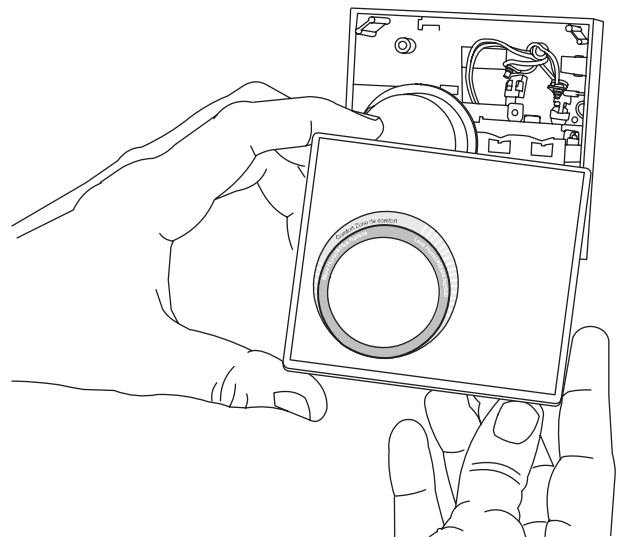

Fig. 4 — Replacing Cover

LIMITED TWO-YEAR WARRANTY

TWO-YEAR WARRANTY — This CARRIER CORPORATION product is warranted to be free from defects in material and workmanship under normal use and maintenance for a period of two years from the date of original installation. A new or remanufactured part to replace the defective part will be provided without charge for the part itself, through a qualified servicing CARRIER CORPORATION dealer or service, PROVIDED the defective part is returned to our distributor. The replacement part assumes the unused portion of the warranty.

THIS WARRANTY DOES NOT INCLUDE ANY ADDITIONAL LABOR ALLOWANCE OR OTHER COSTS incurred for diagnosis, repairing, removing, installing, shipping, servicing, or handling of either defective parts or replacement parts. SUCH COSTS MAY BE COVERED BY a separate warranty provided by the installer.

LIMITATIONS OF WARRANTIES — ALL IMPLIED WARRANTIES (INCLUDING IMPLIED WARRANTIES OF MERCHANTABILITY) ARE HEREBY LIMITED IN DURATION TO THE PERIOD FOR WHICH THE LIMITED WARRANTY IS GIVEN. THE EXPRESSED WARRANTIES MADE IN THIS WARRANTY ARE EXCLUSIVE AND MAY NOT BE ALTERED, ENLARGED, OR CHANGED BY ANY DISTRIBUTOR, DEALER, OR OTHER PERSON WHATSOEVER.

CARRIER WILL NOT BE RESPONSIBLE FOR:

1. Normal maintenance as outlined in the installation and servicing instructions or owner's manual including replacement of filters or bulbs.
2. Damage or repairs required as a consequence of faulty installation or application by others.
3. Failure to start due to voltage conditions, blown fuses, open circuit breakers or other damages due to the inadequacy or interruption of electrical service.
4. Damage or repairs needed as a consequence of any misapplication, abuse, improper servicing, unauthorized alteration, or improper operations.
5. Damage as a result of floods, winds, fires, lightning, accidents, corrosive atmosphere, or other conditions beyond the control of CARRIER CORPORATION.
6. Parts not supplied or designated by CARRIER CORPORATION.
7. CARRIER CORPORATION products installed outside the continental U.S.A., Alaska, Hawaii, and Canada.
8. ANY SPECIAL INDIRECT OR CONSEQUENTIAL PROPERTY OR COMMERCIAL DAMAGE OF ANY NATURE WHATSOEVER. Some states do not allow the exclusion of incidental or consequential damages, so the above limitation may not apply to you.

Model No.

Unit Serial No.

Date of Installation

Installed by

Name of Owner

Address of Installation

Manufacturer reserves the right to
discontinue, or change at any time,
specifications or designs without notice
and without incurring obligations.

REPLACEMENT COMPONENTS DIVISION
© CARRIER CORPORATION 2004 2-04
PRINTED IN U.S.A.

LITERATURE NUMBER P707-3SI
REPLACES: New
CATALOG NUMBER 570-330

Download from [Www.Somanuals.com](http://www.Somanuals.com). All Manuals Search And Download.

Free Manuals Download Website

<http://myh66.com>

<http://usermanuals.us>

<http://www.somanuals.com>

<http://www.4manuals.cc>

<http://www.manual-lib.com>

<http://www.404manual.com>

<http://www.luxmanual.com>

<http://aubethermostatmanual.com>

Golf course search by state

<http://golfingnear.com>

Email search by domain

<http://emailbydomain.com>

Auto manuals search

<http://auto.somanuals.com>

TV manuals search

<http://tv.somanuals.com>