

# CASIO®

## TQ-131U

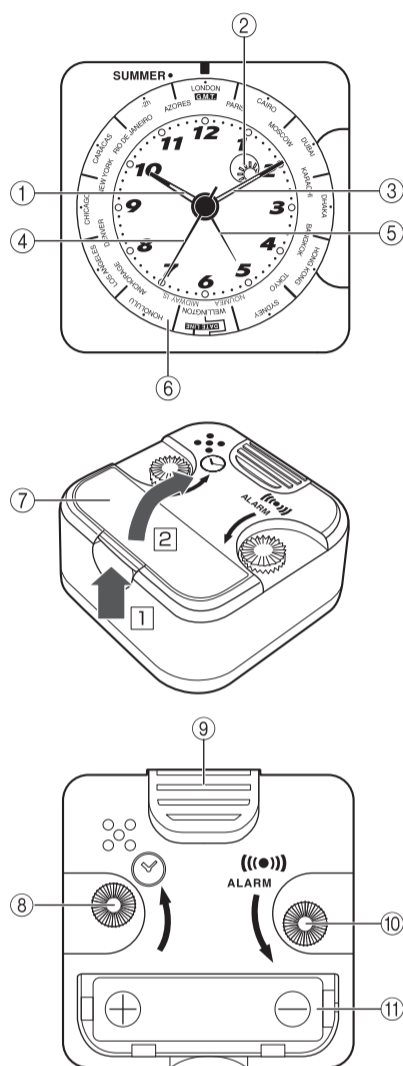

### City Code Table

City	UTC Offset	City	UTC Offset
MIDWAY IS.	-11	PARIS	+1
HONOLULU	-10	CAIRO	+2
ANCHORAGE	-9	MOSCOW	+3
LOS ANGELES	-8	DUBAI	+4
DENVER	-7	KARACHI	+5
CHICAGO	-6	DHAKA	+6
NEW YORK	-5	BANGKOK	+7
CARACAS	-4	HONG KONG	+8
RIO DE JANEIRO	-3	TOKYO	+9
-2h	-2	SYDNEY	+10
AZORES	-1	NOUMEA	+11
LONDON	0	WELLINGTON	+12
G.M.T(UTC)			

- Based on data as of June 2008.
- UTC offsets and the use of summer time are subject to change in the country where they are used.
- \* In December 2007, the UTC offset for Caracas, Venezuela (CCS) was changed from -4 to -4.5. However, this Clock still uses the old UTC offset of -4 when the Caracas (CCS) city code is selected.

## ENGLISH

- Depending on the clock model, its configuration may differ somewhat from that shown in the illustration.

### OPERATING PRECAUTIONS

- Do not use or store this clock in areas exposed to temperature extremes, strong magnetism, strong vibration, or strong impact.
- Heat can shorten battery life and cause malfunction. Keep the clock away from heaters and direct sunlight when using it.
- Never use the clock in a bathroom or any other area subject to high humidity.
- Never try to take the clock apart. Doing so can cause malfunction.
- To clean the clock, use a soft, dry cloth or a cloth moistened in a solution of water and a mild neutral detergent. Wring out all excess moisture from the cloth. Never use thinner, benzene, alcohol or other similar agents.
- Be sure to keep all user documentation handy for future reference.

CASIO COMPUTER CO., LTD. assumes no responsibility for any loss, or any claims by third parties that may arise through the use of this clock.

### GENERAL GUIDE

- ① Hour hand
- ② Time of day indicator  
Sun: Daytime  
Moon: Nighttime
- ③ Minute hand
- ④ Second hand
- ⑤ Alarm hand
- ⑥ Bezel  
For selecting the city whose time you want to view.
- ⑦ Battery cover
- ⑧ Time adjustment dial
- ⑨ Alarm ON/OFF switch
- ⑩ Alarm time adjustment dial
- ⑪ Battery

### USING THE CLOCK

1. Open the **Battery cover** (⑦) as shown in the illustration.
2. Ensuring that its ends are facing correctly, load a **Battery** (⑪) into the clock.
3. Remove the **Battery** (⑪) from the clock when the **Second hand** (④) reaches 12 o'clock.
4. Rotate the **Bezel** (⑥) counterclockwise until the city code you want to select is located at 12 o'clock (or SUMMER in the case of summer time).
  - If you rotate the **Bezel** (⑥) clockwise and the **Hour hand** (①) passes over the **Alarm hand** (⑤), the alarm hand will start to move along with the hour hand.
5. Use the **Time adjustment dial** (⑧) to adjust the current time setting.
  - Check to make sure that the proper **Time of day indicator** (②) is shown for the time you are setting. The sun indicates daytime, while the moon indicates nighttime.
6. At the top of a minute, load the **Battery** (⑪) to start timekeeping.

### USING THE ALARM

#### Setting the Alarm Time

- Rotate the **Alarm time adjustment dial** (⑩) to move the **Alarm hand** (⑤) to the time you want the alarm to sound.
- The alarm does not distinguish between a.m. and p.m.
  - The alarm will continue to sound for about 60 minutes if you do not stop it.

#### Turning the Alarm On or Off

Use the **Alarm ON/OFF switch** (⑨) to turn the alarm on or off.



#### Stopping the Alarm

While the alarm is sounding, press the **Alarm ON/OFF switch** (⑨) to stop it.

### USING THE WORLD TIME

With World Time, you can select a city by rotating the bezel so the city is located at 12 o'clock. This will cause the hands of the clock to move to the current time in that city. Rotate the bezel counterclockwise.

#### Using Summer Time

If summer time (DST) is in effect in the city you select, rotate the bezel so the city is located at SUMMER instead of 12 o'clock.  
\*DST=Daylight Saving Time

Rotate the **Bezel** (⑥) counterclockwise so select the city you want.  
If you rotate the **Bezel** (⑥) clockwise and the **Hour hand** (①) passes over the **Alarm hand** (⑤), the alarm hand will start to move along with the hour hand.

After you view the time in a city, you can rotate the **Bezel** (⑥) back to your home city, if you want.  
If you leave the bezel set to a city that does not match your home city, the alarm will sound at the alarm time in the currently selected city.

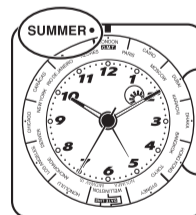

### BATTERY REPLACEMENT

Low battery power is indicated when timekeeping slows or stops completely. Should either of these symptoms occur, replace the battery as soon as possible. Do not leave a low or dead battery in the clock.

1. Open the **Battery cover** (⑦) as shown in the illustration.
2. Remove the old battery.
3. Load a new battery. Make sure that its positive (+) and negative (-) ends are facing correctly.
4. Replace the **Battery cover** (⑦).

#### Battery precautions

- Keep batteries out of the reach of small children. If a battery is swallowed accidentally, contact your physician immediately.
- Be sure to load the battery with its positive (+) and negative (-) ends facing correctly.
- Never charge the battery that comes with the clock.
- Should a battery ever leak while in the clock, wipe out the fluid with a cloth, taking care not to get any onto your skin.
- Replace the battery at least once a year, even if it is still supplying power.
- The battery that comes with the clock loses some of its power during transport and storage.

### SPECIFICATIONS

**Accuracy at normal temperature:** ±20 seconds a month  
**Readout:** 3 hands (hour, minutes, seconds)

**Alarm:** Daily alarm

**Battery:** One AA size battery (Type: R6P)

**Battery life:** 1 year under the following conditions

- 2-minute alarm operation per day

**Operating temperature:** -10°C to 50°C

## Free Manuals Download Website

<http://myh66.com>

<http://usermanuals.us>

<http://www.somanuals.com>

<http://www.4manuals.cc>

<http://www.manual-lib.com>

<http://www.404manual.com>

<http://www.luxmanual.com>

<http://aubethermostatmanual.com>

Golf course search by state

<http://golfingnear.com>

Email search by domain

<http://emailbydomain.com>

Auto manuals search

<http://auto.somanuals.com>

TV manuals search

<http://tv.somanuals.com>