

COBY®

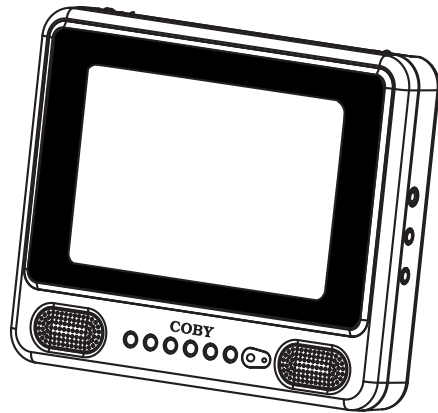

TF-TV505

Please read this manual before connection and use.

Customer Service Hours

Monday- Friday 8:00AM ~ 11:00PM (EST) 1-800-681-2629 or 718-416-3197

Monday- Friday 6:30PM ~ 11:00PM (EST) 1-800-727-3592

Saturday- Sunday 9:00AM ~ 11:00PM (EST) 1-800-727-3592

Or Send E-Mail to: Customerservice@cobyusa.com / techsupport@cobyusa.com

English

Important Safety Instruction



WARNING: TO REDUCE THE RISK OF FIRE OR ELECTRIC SHOCK, DO NOT EXPOSE THIS APPLIANCE TO RAIN OF MOISTURE.



The lightning flash with arrowhead symbol, within an equilateral triangle, is intended to alert the user to the presence of uninsulated "dangerous voltage" within the product's enclosure that may be of sufficient magnitude to constitute a risk of electric to persons.



The exclamation point within an equilateral triangle is intended to alert the user to the presence of important operating and maintenance (servicing) instructions in the literature accompanying the appliance.

IMPORTANT FOR LASER PRODUCTS CLASS 1 LASER PRODUCT

DANGER:

Visible laser radiation when open and interlock failed or defeated. Avoid direct exposure to beam.

CAUTION:

These servicing instructions are for use by qualified service personnel only. To reduce the risk of electric shock, do not perform any servicing other than that contained in the operating instructions unless you are qualified to do so. Refer to manual for servicing instructions.

POWER SUPPLY:

Connect the supplied adapter to the side of the unit in the slot marked DC 12V. Plug the two-prong end of the power cord to an AC100-240V outlet. If you have difficulty inserting the plug, turn it over and reinsert it, if the unit will not be used for a long time, disconnect the plug from the outlet.

NOTE:

Before plugging the power cord into an AC outlet, make sure that all the connections have been made.

Important Safety Instruction

1. Read these instructions.
2. Keep these instructions.
3. Heed all warnings.
4. Follow all instructions.
5. Do not use near water.
6. Clean only with dry cloth.
7. Do not block any ventilation openings. Maintain well ventilated conditions around the product. Do not put product on bed, sofa or anything that blocks ventilation. Install according to instructions.
8. Do not install near any heat sources such as radiators, heat registers, stoves, or other apparatus (including amplifiers) that produce heat.
9. Do not defeat the safety purpose of the polarized or grounding-type plug. A polarized plug has two blades with one wider than the other. If the provided plug does not fit into your outlet, consult an electrician for replacement of the obsolete outlet.
10. Protect the power cord from being walked on or pinched particularly at plugs, convenience receptacles, and the point where they exit from the apparatus.
11. Only use attachments/accessories specified by the manufacturer.
12. Use only with the cart, stand, tripod, bracket, or table specified by the manufacturer, or sold with the apparatus. When a cart is used, use caution when moving the cart/apparatus combination to avoid injury from tip-over.
13. Unplug this apparatus during lightning storms or when unused for long periods of time.
14. Refer all servicing to qualified service personnel. Servicing is required when the apparatus has been damaged in any way, such as power-supply cord or plug is damaged, liquid has been spilled or objects have fallen into the apparatus, the apparatus has been exposed to rain or moisture, does not operate normally, or has been dropped.
15. Apparatus shall not be exposed to dripping or splashing and no objects filled with liquids, such as vases, shall be placed on the apparatus.

Copyright Protection

Unauthorized copying, broadcasting, public performance, and lending of disks are prohibited. This product incorporates copyright protection technology that is protected by method claims of certain U.S. patents and other intellectual property rights owned by Macrovision Corporation and other rights owners. Use of this copyright protection technology must be authorized by Macrovision Corporation, and is intended for home and other limited viewing uses only unless otherwise authorized by Macrovision Corporation. Reverse engineering or disassembly is prohibited.

Table of Contents

Table Of Contents

Important Safety Instruction	
Unpacking	1
Main Features	2
Unit View.....	3-4
Remote Control	5-7
Power Connections.....	8-9
Cable Connections.....	10
TV Function.....	11-13
AV Function.....	14
Troubleshooting	15
Specifications	16

Unpacking

Please make sure the following items are included with your LCD TV/monitor. If any items are missing, contact your dealer.



Remote Control

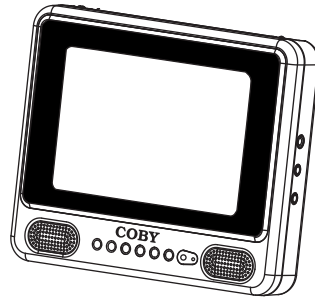

TFT-LCD

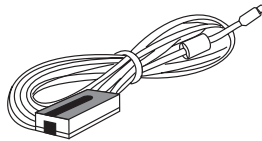

DC Adapter

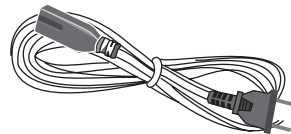

Power Cord

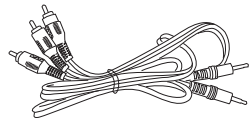

RCA Cable

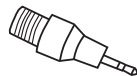

Antenna Adapter

Main Features

TV Mode

AV Mode

You can enjoy programs from external input sources.

High Quality Property

High Resolution

Superior sound

Built-in Dolby Digital decoder to output high quality sound effects.

Screen

Support the picture size of a normal screen (4:3).

LCD (Liquid Crystal Display)

Designed with color TFT liquid crystal display

Clearly shows the data.

Stereo amplifier

Built-in 2x1.5 W speakers.

NOTE: It is normal for a TFT screen to experience some light or dark spots appearing on the LCD screen.

Front/Top/Side Panel

Unit View

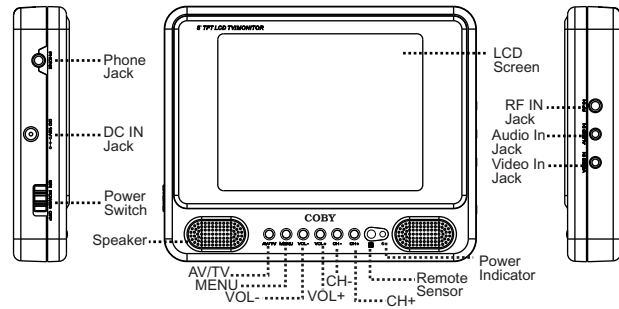

- | | |
|--|---|
| <p>1. AV/TV button
Press to select AV or TV mode.</p> <p>2. MENU button
Press to show menu.</p> <p>3. VOL-/+ button
Press to decrease / increase volume.
Press to make adjustment while working with menu.</p> <p>4. CH -/+ button
Press to select channels.
Also work as direction buttons while working with menu.</p> <p>5. POWER Switch
Press to turn power on/off.</p> <p>6. LCD Screen
Present high resolution pictures.</p> <p>7. Speakers
Two speakers produce stereo sound.</p> | <p>8. Remote sensor
Sense remote signal.</p> <p>9. Power On Indicator
In normal playback status, it lights green.
while in the standby mode, turns red.</p> <p>10. RF IN Jack
Connect to external antenna to receive TV program in TV mode.</p> <p>11. VIDEO IN Jack
Connect to external video input.</p> <p>12. AUDIO IN Jacks
Connect to external audio input .</p> <p>13. PHONE Jack
Connect to stereophone.</p> <p>14. DC 12V IN Jack
Connect to power supply</p> |
|--|---|

3

Unit View

Rear Panel

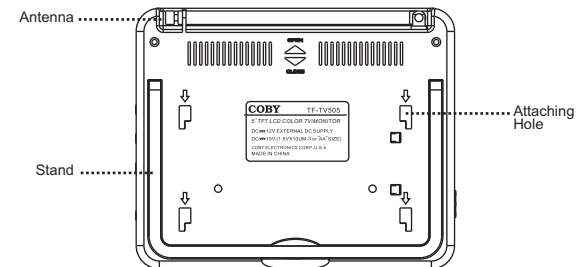

Using Stand

There is a stand on the back of the unit to support the player.

- a) Lift up the stand from its groove.
- b) Erect the unit by supporting it against the stand.
- c) A slopewise viewing position is realized.

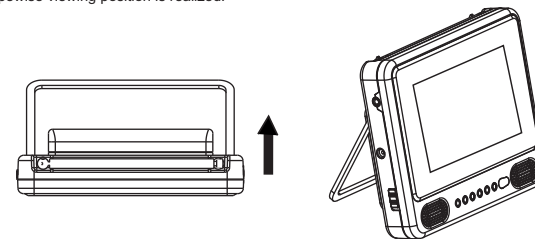

4

Remote Control

Remote Control Drawing

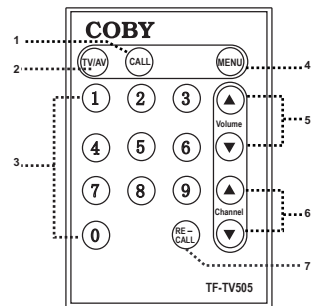

1. CALL: Press to show current program number.
2. TV/AV: Press to select TV or AV.
3. Numeric key pad: Press to input number.
4. MENU: Press to enter menu setup window.
5. VOLUME +/- : Press to adjust sound level.
6. CHANNEL +/-: Press to select channel.
7. RECALL: Press to view previous program.

5

Remote Control

Remote Control Drawing

Using Coin Lithium Battery

To install the battery, follow below steps:

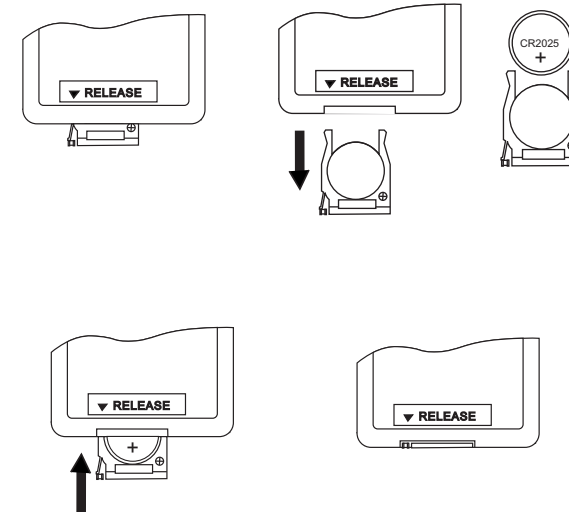

6

Remote Control

Remote Control

Preparation of Remote Control

Take the back cover off of the remote control and insert supplied coin battery and put on the cover. (Refer pg6 for detail)

Using Remote Control

Point the remote to the sensor by about 60 degrees of no more than 7 meters

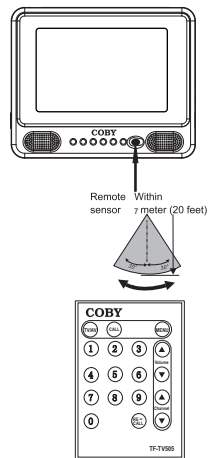

The operating distance may vary depending to the brightness around.

Notes:

- Do not point bright lights directly at the remote control sensor.
- Do not place objects between the remote control unit and the remote control sensor.
- Do not use this remote control unit while simultaneously operating the remote control unit of any other equipment.

7

Power Connections

Connect to AC adaptor

**Do not connect the power cord until all other connections have been made.
Power is supplied through the provided appropriate power adaptor, one end of which is connected to the DC IN jack on the main unit, another to wall outlet with AC100-240V.

Note:

- If you have difficulty inserting the plug, turn it over and reinsert it.
- If the unit will not be in use for long periods of time, disconnect the plug from the outlet.
- In order to prolong the operation life, the intervals of continuous power on should be not less than 30s.

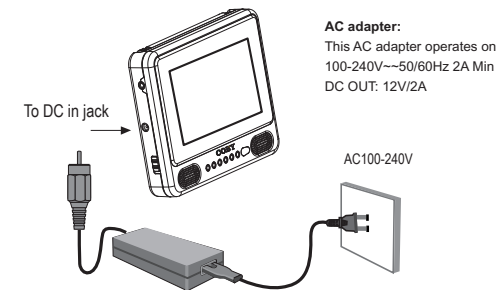

8

Power Connections

Battery pack connection

- Match the four hooks to its attaching slots on the bottom of the main unit.
- Slide downward to lock it into position.
- To release the battery, press it upward.

Please refer to below diagram for better understanding.

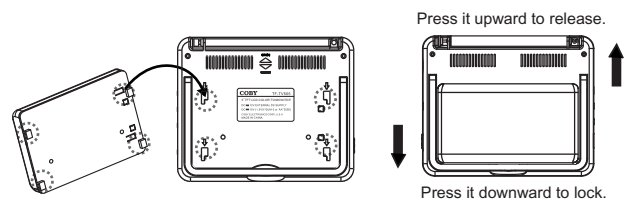

Using battery pack

- Loosen the screw.
- Slide the cover downward to open the battery pack.
- Insert ten batteries.
- Slide the pack cover up to lock it.
- Tighten the screw.

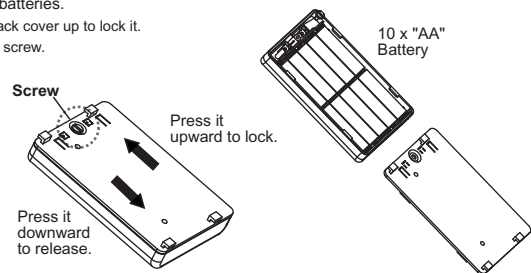

9

Cable Connections

Cable connections

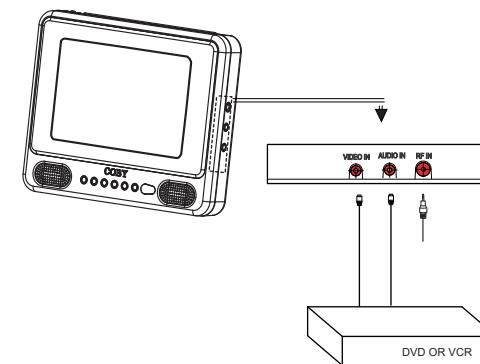

Connecting an External Aerial Antenna or Cable Television

To view television channels, a signal must be received by the device from one of the following sources:

- The internal antenna
- An outdoor aerial antenna
- A cable television network
- A satellite network

- Connect the supplied antenna adaptor into the "RF IN" jack located on the side of this device.
- Connect the external antenna source to the adaptor.

Connecting Audio and Video sources (DVD Player, VCR, Game Console, Etc.)

- Using the supplied composite cable, connect the yellow video plug into the "VIDEO IN" and the black audio plug into the "AUDIO IN" jack located on the side of this device.
- On the other end of the cable, connect the yellow plug into the "VIDEO OUT" and the red and white plugs into the "AUDIO OUT" of your DVD player, VCR, game console, etc.
- Connect audio sources (including DVD/VCR/CAMCORDER/PC) to "AUDIO IN" ports by RCA cable.
- Connect video sources (DVD/VCR/CAMCORDER) to the "VIDEO IN" port.

10

TV Function

TV Function

Basic Operation

1. Connect the TV RF source to the RF IN jack on the unit side panel.
2. Connect the power supply cord. If the player is in standby mode, set POWER switch to "ON".
3. Press the AV/TV button to select the TV mode.
4. Press CH+/- buttons to select the channel or use the number buttons directly.
5. Press VOL+/- button to adjust volume.

Parameters setup

TV Setup

1. Press MENU button. TV-MENU window appears.
2. Press VOL+/- button to select TV system from PAL-N/PAL-M/NTSC.

NTSC TV System

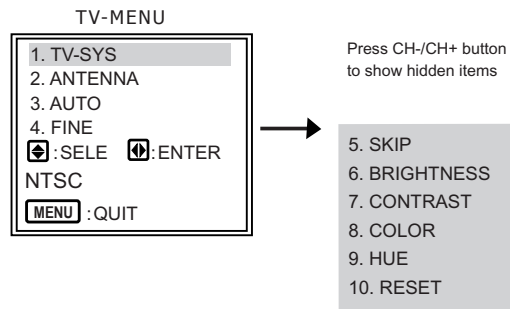

11

TV Function

Parameters setup

Refer below table for detail.

NOTE: While working with setup menu, press CH-/CH+ button to highlight a desired item and press VOL-/++ to make adjustment. Press MENU button to exit setup window.

ITEM	DISCRIPTION
ANTENNA	Select antenna type from Air or Cab
AUTO	Search channel automatically
FINE	Select to tune picture
SKIP	Select from on/off to skip unwanted program
BRIGHTNESS	Adjust LCD brightness
CONTRAST	Adjust LCD contrast
COLOR	Adjust LCD color
HUE	Adjust LCD color
RESET	Select to restore setting to the default.

PAL-M/PAL-N/TV System

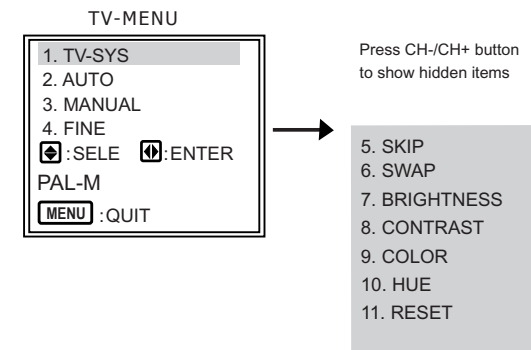

12

TV Function

Parameters setup

Refer below table for detail.

NOTE: While working with menu, press CH-/CH+ button to highlight a desired item and press VOL-/+ to make adjustment. Press MENU button to exit .

ITEM	DISCRIPTION
MANUAL	Search channel manually. ▢
AUTO	Search channel automatically
FINE ▢	Select to tune picture
SKIP ▢ ▢	Select from on/off to skip unwanted program
SWAP	Select to change channel
BRIGHTNESS	Adjust LCD brightness
CONTRAST ▢ ▢	Adjust LCD contrast
COLOR ▢	Adjust LCD color
HUE ▢ ▢ ▢	Adjust LCD color
RESET	Select to restore setting to the default.

AV Function

AV Function

The player has AV functions. You can enjoy programs from external input sources.

Preparation

1. Connect the external AV signal source to VIDEO IN or AUDIO IN jack.
2. Turn on the power of the unit
3. Press the TV/AV button to select AV mode.

Parameters setup

AV - Setup

1. Under the AV mode, press MENU button. AV-MENU appears .
2. Press VOL+/- button to select COLOR-SYS from PAL-N/PAL-M/NTSC.

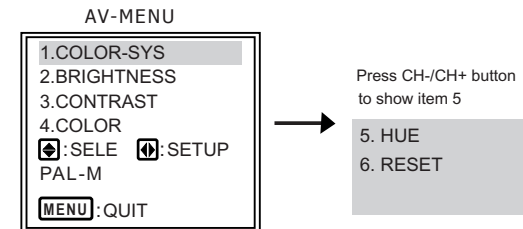

Refer below table for detail.

ITEM	DISCRIPTION
BRIGHTNESS	Adjust LCD brightness
CONTRAST ▢ ▢	Adjust LCD contrast
COLOR ▢	Adjust LCD color
HUE ▢ ▢ ▢	Adjust LCD tue
RESET	Select to restore setting to the default.

Trouble Shooting

Symptom	Check and Action
No power	<ul style="list-style-type: none"> • Make sure the unit has been powered on manually. • Check if the power cord has been properly connected to the power outlet. • Check if the main power has been switched on.
No picture	<ul style="list-style-type: none"> • Try another TV channel • Check if the system connection is proper and secure. • Check if the connection cables are damaged.
No sound	<ul style="list-style-type: none"> • Increase the volume. • Check if the sound system has been properly set. • Check if the AV audio signal input cable has been connected properly.
Color distorted	<ul style="list-style-type: none"> • Reset the color system of the unit. • Check if the system has been properly connected. • Check if the AV video signal input cable is connected properly.
Picture and sound are interfered	<ul style="list-style-type: none"> • Check if the system has been properly connected. • If using antenna, adjust the antenna.
Remote control does not work	<ul style="list-style-type: none"> • Make sure the POWER button on the unit has been turned on manually. • Remove the obstacles between the remote control and the player. • Point the remote control towards the remote sensor on the player. • Check if the batteries of the remote control have been loaded with correct polarities. • Replace the batteries of the remote control.
Malfunction	<ul style="list-style-type: none"> • Should the player develop a malfunction, unplug the player for 30 minutes. After that, power on the player and the restore function should reset the player.

Specification

Size	5"	
TV system	NTSC/PAL	
AC/DC Adapter	AC input	100-240V 50/60Hz
	DC output	(+12V / 2A)
Power consumption	On working	15W (Max)
	Speaker	1.5 W
Operating temperature range	10 ℃-40 ℃	
Dimension	165x132x65 mm	
Weight	413g	

Free Manuals Download Website

<http://myh66.com>

<http://usermanuals.us>

<http://www.somanuals.com>

<http://www.4manuals.cc>

<http://www.manual-lib.com>

<http://www.404manual.com>

<http://www.luxmanual.com>

<http://aubethermostatmanual.com>

Golf course search by state

<http://golfingnear.com>

Email search by domain

<http://emailbydomain.com>

Auto manuals search

<http://auto.somanuals.com>

TV manuals search

<http://tv.somanuals.com>