

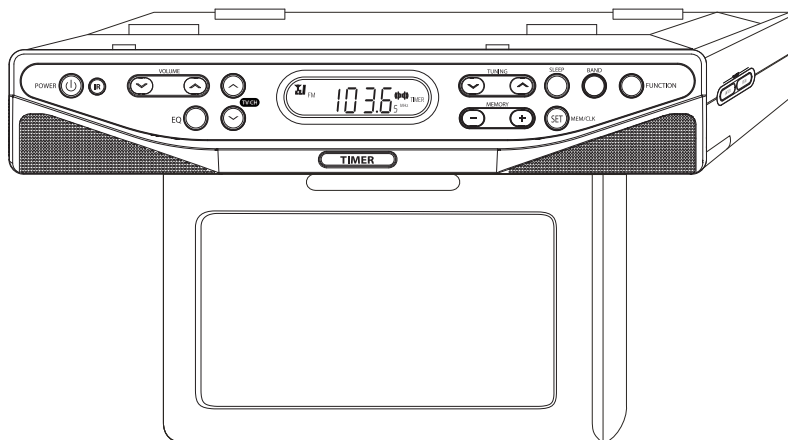

MODEL NO. KCR2610

# UNDERCOUNTER LCD TV CLOCK RADIO

OWNER'S MANUAL



PLEASE READ BEFORE OPERATING THIS EQUIPMENT



**CAUTION:** TO REDUCE THE RISK OF ELECTRIC SHOCK, DO NOT REMOVE COVER (OR BACK). NO USER-SERVICEABLE PARTS INSIDE. REFER SERVICING TO QUALIFIED SERVICE PERSONNEL.



**DANGEROUS VOLTAGE**

The lightning flash with arrowhead symbol, within an equilateral triangle is intended to alert the user to the presence of uninsulated dangerous voltage within the product's enclosure that may be of sufficient magnitude to constitute a risk of electric shock to persons.



**ATTENTION**

The exclamation point within an equilateral triangle is intended to alert the user to the presence of important operating and maintenance (servicing) instructions in the literature accompanying the appliance.

# PREPARATION FOR USE

## **Unpacking and Setup**

- Carefully remove the unit from the display carton and remove all packing material from the unit itself.

## **AC Operation**

Unwind the AC cord and extend it to its full length. Insert the AC cord into any convenient AC 120V~60Hz household outlet.

## LOCATION OF CONTROLS

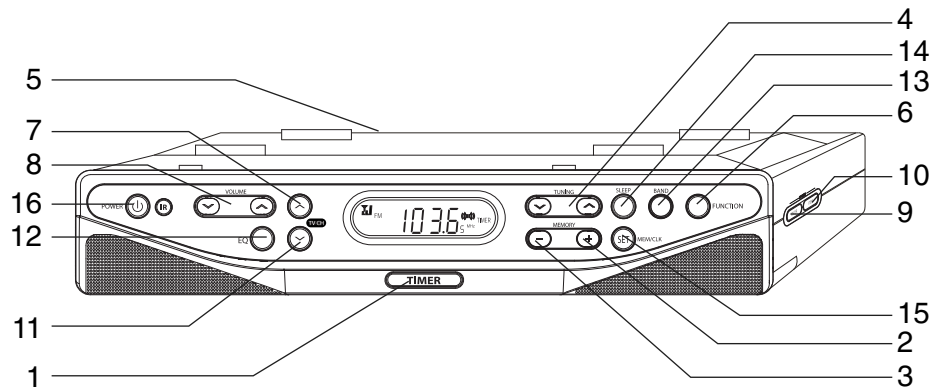

- |                     |                        |
|---------------------|------------------------|
| 1. TIMER BUTTON     | 9. ENTER BUTTON        |
| 2. MEM UP BUTTON    | 10. ITEM BUTTON        |
| 3. MEM DN BUTTON    | 11. CH. DN BUTTON      |
| 4. TUNER/CLK BUTTON | 12. EQ BUTTON          |
| 5. MOUNTING BRACKET | 13. BAND BUTTON        |
| 6. FUNCTION BUTTON  | 14. SLEEP BUTTON       |
| 7. CH. UP BUTTON    | 15. MEM/CLK SET BUTTON |
| 8. VOLUME BUTTON    | 16. POWER BUTTON       |

## LOCATION OF CONTROLS

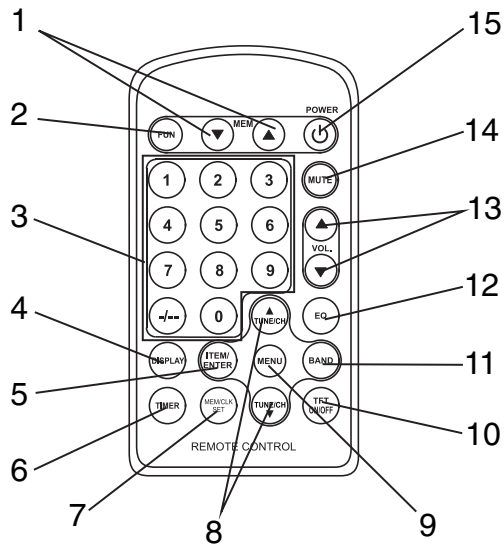

- |                          |                       |
|--------------------------|-----------------------|
| 1. MEM. CH. UP/DN BUTTON | 9. MENU BUTTON        |
| 2. FUNCTION BUTTON       | 10. TFT ON/OFF BUTTON |
| 3. NUMERDIAL BUTTONS     | 11. BAND BUTTON       |
| 4. DISPLAY BUTTON        | 12. EQ BUTTON         |
| 5. ITEM/ENTER BUTTON     | 13. VOLUME BUTTON     |
| 6. TIMER BUTTON          | 14. MUTE BUTTON       |
| 7. MEM/CLK SET BUTTON    | 15. POWER BUTTON      |
| 8. TUNE/CH BUTTON        |                       |

## POWER SOURCES

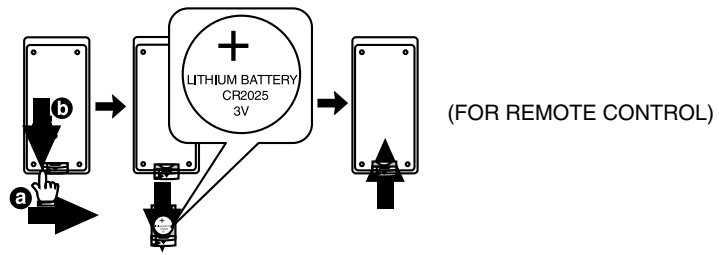

### BATTERIES

#### NOTE:

The button cell battery contains mercury, don't put in the trash. Recycle or dispose as hazardous waste.

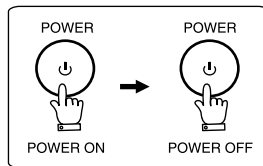

#### NOTE:

You may need to remove a protective covering from the remote's battery compartment before using the remote control.

# OPERATING INSTRUCTIONS

## 1. SETTING THE TIME (POWER OFF MODE)

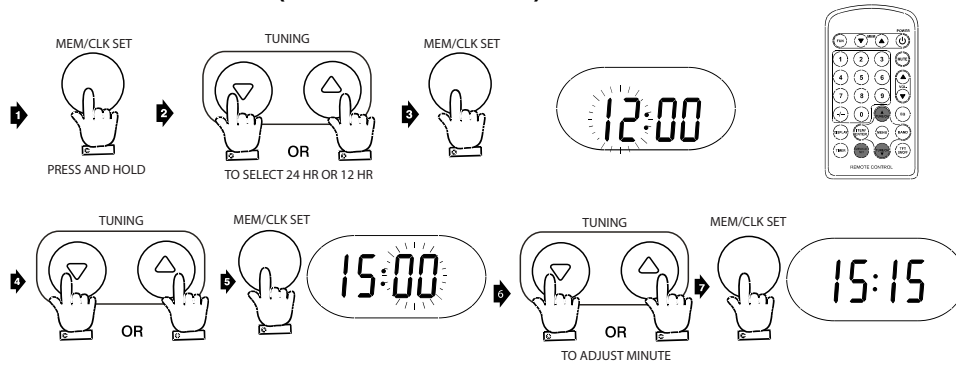

## 2. LISTENING TO THE RADIO

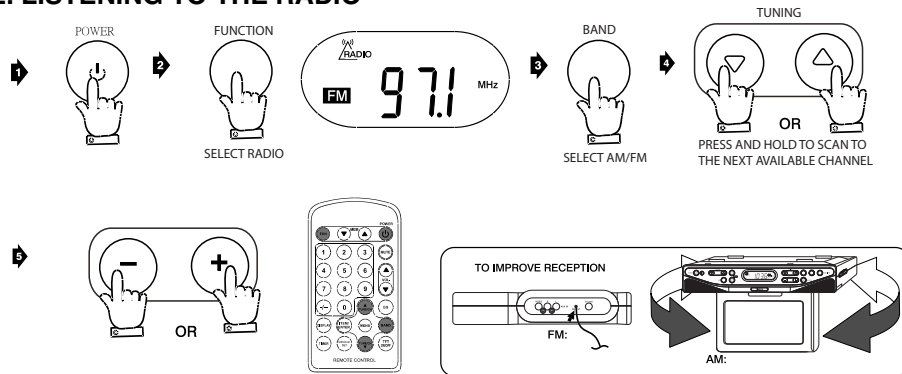

# OPERATING INSTRUCTIONS

## PROGRAM RADIO STATIONS

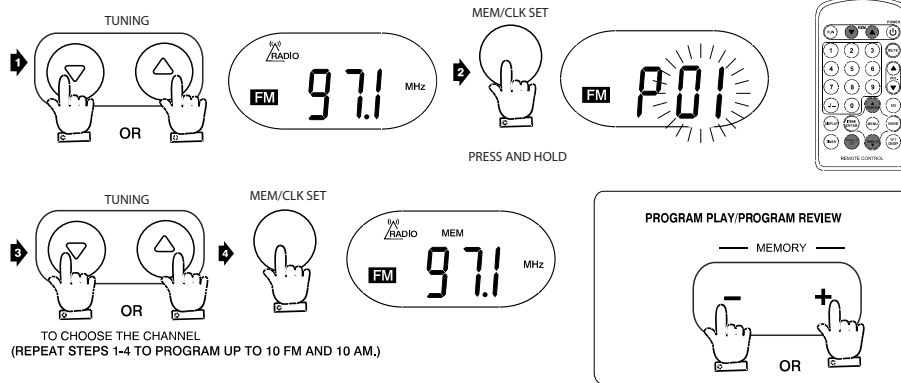

## 3. TELEVISION OPERATION

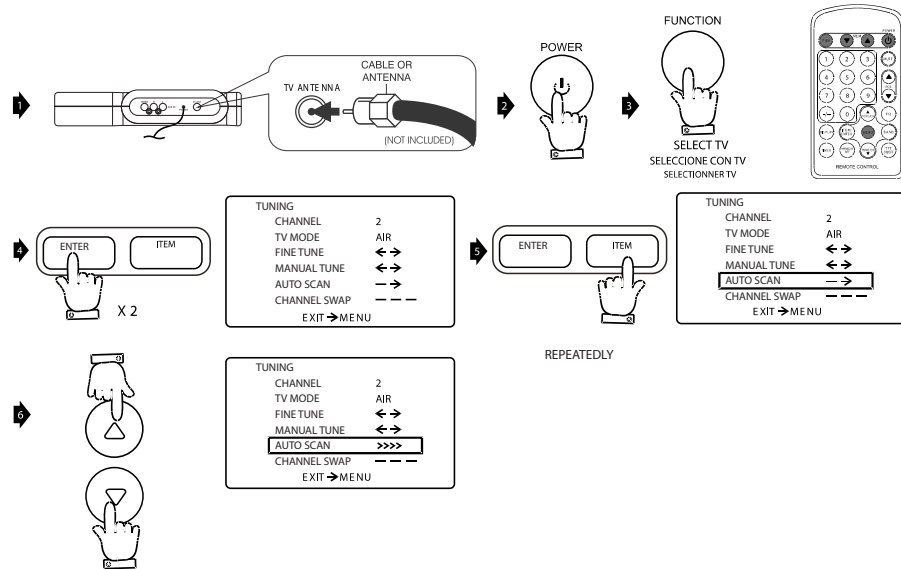



# OPERATING INSTRUCTIONS

## 4. SET UP

### PICTURE

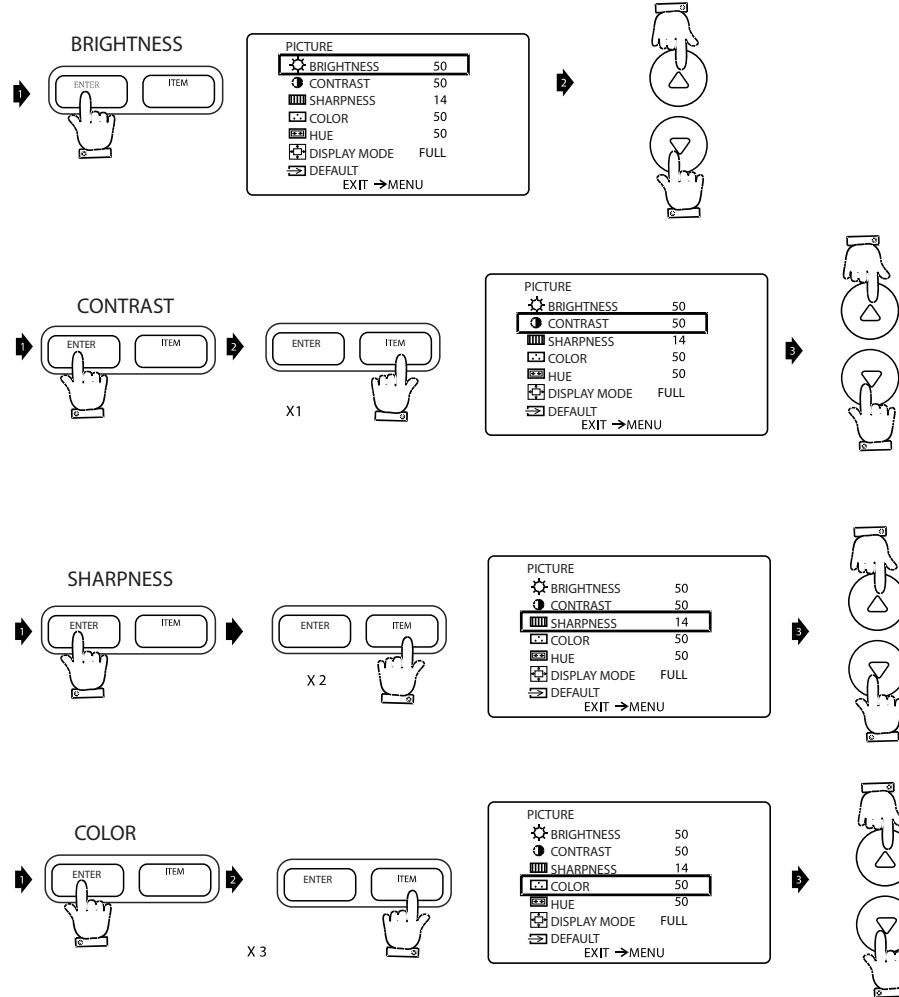

# OPERATING INSTRUCTIONS

## HUE

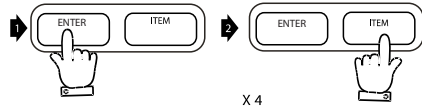

PICTURE	
BRIGHTNESS	50
CONTRAST	50
SHARPNESS	14
COLOR	50
HUE	50
DISPLAY MODE	
DEFAULT	
EXIT → MENU	

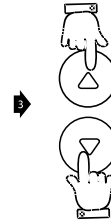

## DISPLAY MODE

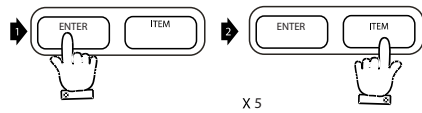

PICTURE	
BRIGHTNESS	50
CONTRAST	50
SHARPNESS	14
COLOR	50
HUE	50
DISPLAY MODE	
DEFAULT	
EXIT → MENU	

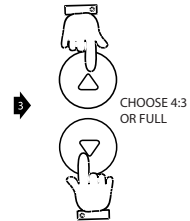

## RESET TO DEFAULT SETTING

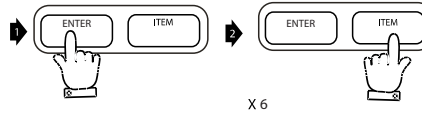

PICTURE	
BRIGHTNESS	50
CONTRAST	50
SHARPNESS	14
COLOR	50
HUE	50
DISPLAY MODE	
DEFAULT	
EXIT → MENU	

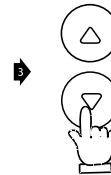

PICTURE	
BRIGHTNESS	50
CONTRAST	50
SHARPNESS	14
COLOR	50
HUE	50
DISPLAY MODE	
RESETTING	
EXIT → MENU	



PICTURE	
BRIGHTNESS	50
CONTRAST	50
SHARPNESS	14
COLOR	50
HUE	50
DISPLAY MODE	
DEFAULT	OK
EXIT → MENU	

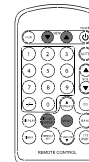

## EXIT PICTURE MENU

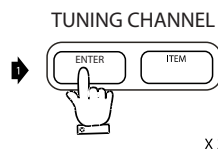
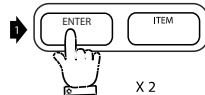

TUNING	
CHANNEL	2
TV MODE	AIR
FINE TUNE	← →
MANUAL TUNE	← →
AUTO SCAN	→
CHANNEL SWAP	---
EXIT → MENU	

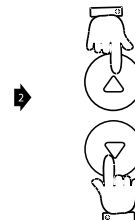

# OPERATING INSTRUCTIONS

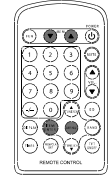
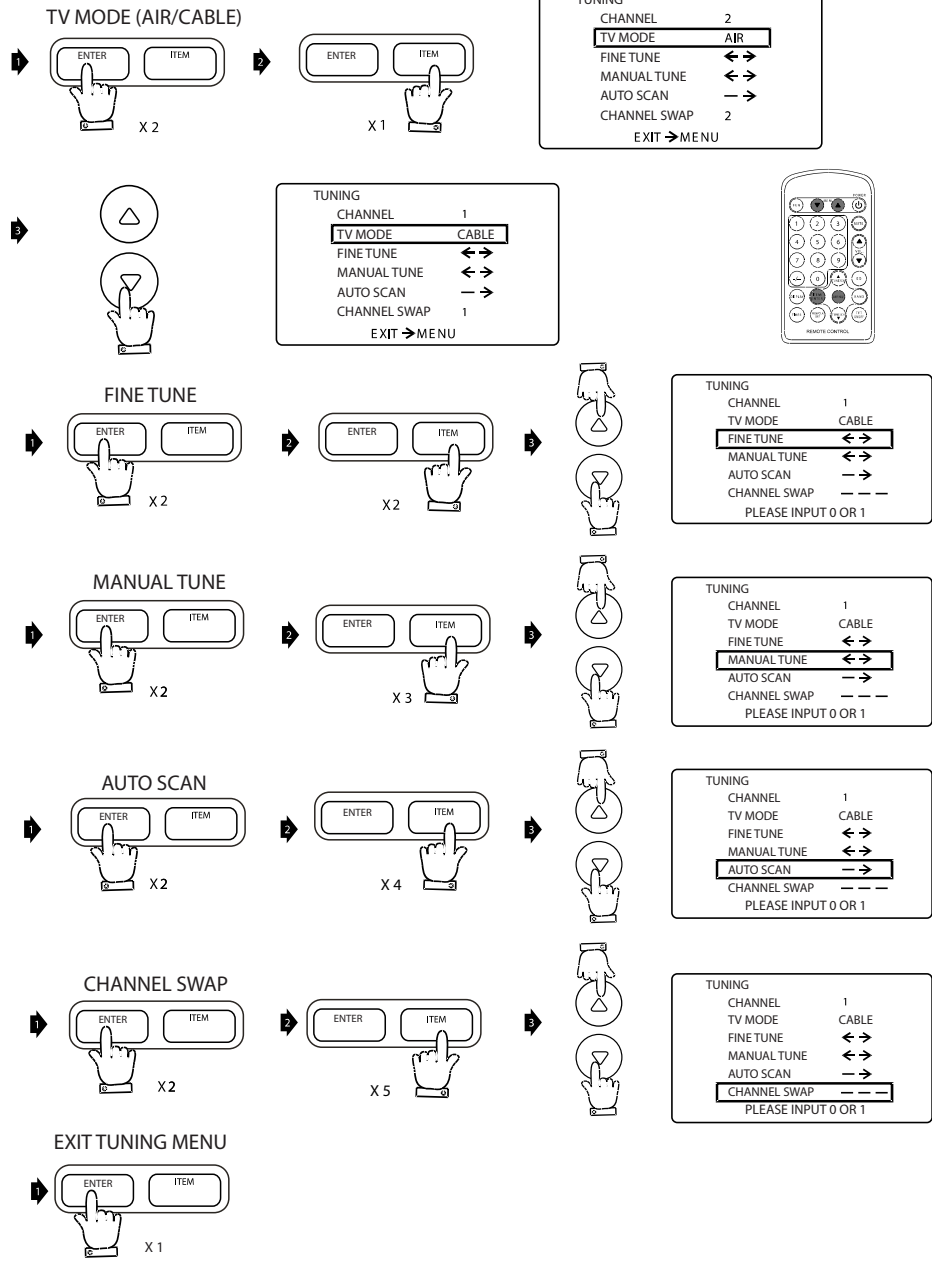

# OPERATING INSTRUCTIONS

## 5. LISTENING TO AN AUXILIARY SOURCE

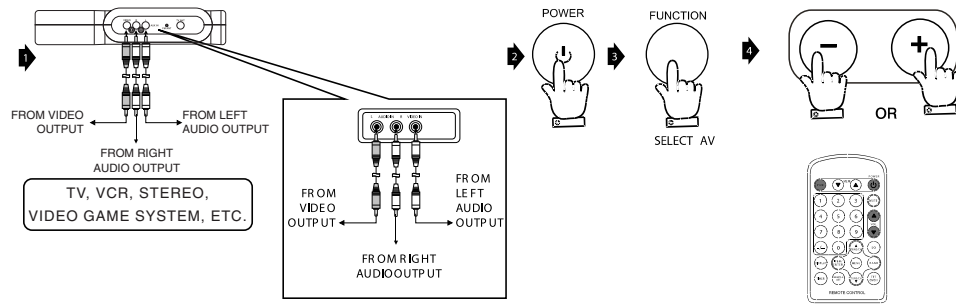

## 6. SETTING KITCHEN TIMER

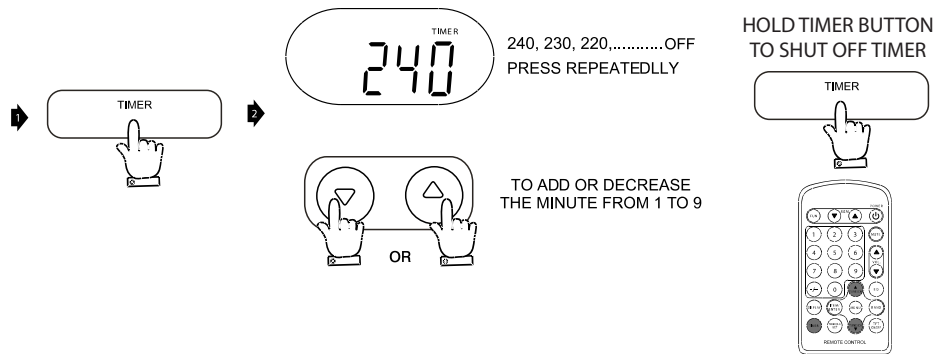

## 7. EQ

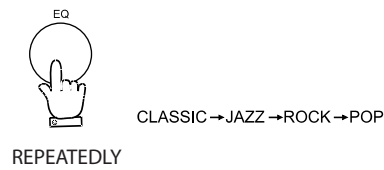

## CARE AND MAINTENANCE

### GENERAL

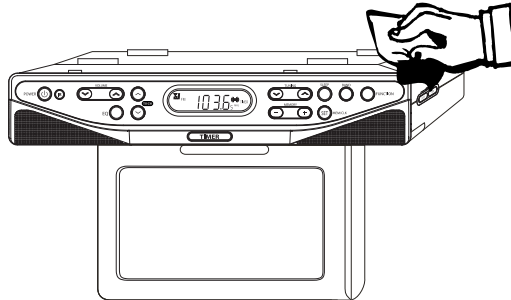

- \* Use a soft, clean cloth moistened with plain, luke-warm water to clean the exterior of the unit.
- \* Never use solvents such as benzene or other strong chemical cleaners since these could damage the unit's finish.
- \* It is important that no liquid reaches the inside of the unit.

## TROUBLESHOOTING GUIDE

PROBLEM	POSSIBLE CAUSE	SOLUTION
<b>GENERAL</b>		
No sound is heard.	Power is not on.	Press the POWER button.
	VOLUME Control is set to minimum.	Adjust the VOLUME Control.
	Mute is on.	Press Mute on remote.
<b>RADIO</b>		
No sound is heard.	Station has not been tuned properly.	Tune station properly
	FM reception is weak.	Extend the FM cord.
	Wrong function is selected.	Press the FUNCTION button to the radio position.
<b>TV</b>		
Snowy picture; noisy sound.	Station has not been tuned properly.	Align the antenna or connect an external antenna.
Dotted lines or stripes.	This may be caused by local interference (e.g. Cars, neon signs, hair dryers, etc.)	Adjust the antenna for minimum interference or connect an optional external antenna.
Double images or "ghosts".	This may be caused by reflections from nearby mountains or buildings.	A highly directional antenna may improve the picture.
Good picture; no sound.	VOLUME control is set to minimum.	Adjust the volume.
Good picture; noisy sound.	This may be caused by reflections from nearby mountains or buildings.	A highly directional antenna may improve the picture.
Good picture; no sound.	This may be caused by reflections from nearby mountains or buildings.	A highly directional antenna may improve the picture.
No picture	Power is not on.	Set the FUNCTION Switch to the TV position.

## Free Manuals Download Website

<http://myh66.com>

<http://usermanuals.us>

<http://www.somanuals.com>

<http://www.4manuals.cc>

<http://www.manual-lib.com>

<http://www.404manual.com>

<http://www.luxmanual.com>

<http://aubethermostatmanual.com>

Golf course search by state

<http://golfingnear.com>

Email search by domain

<http://emailbydomain.com>

Auto manuals search

<http://auto.somanuals.com>

TV manuals search

<http://tv.somanuals.com>