

GTP10 Herbicide Pump

311628C
ENG

For pumping herbicides. Do not use to pump other fluids including water.

Model 260410, 10 gpm (38 lpm), 12 VDC (CSA C/US listed motor)

Model 260411, 10 gpm (38 lpm), 12 VDC (CSA C/US listed motor)

Includes 8 ft (2.44 m) hose, nozzle and inlet suction tube

Model 260408, 12 gpm (45 lpm), 115 VAC

Model 260409, 12 gpm (45 lpm), 115 VAC

Includes 8 ft (2.44 m) hose, nozzle and inlet suction tube

10 psi (0.07 MPa, 0.7 bar) Maximum Working Pressure



Important Safety Instructions

Read all warnings and instructions in this manual. Save these instructions.







PROVEN QUALITY. LEADING TECHNOLOGY.



Warnings

The following general warnings are for the setup, use, grounding, maintenance, and repair of this equipment. Additional, more specific warnings may be found throughout the body of this manual where applicable. *Symbols appearing in the body of the manual refer to these general warnings. When these symbols appear throughout the manual, refer back to these pages for a description of the specific hazard.*

 WARNING	
	<p>FIRE AND EXPLOSION HAZARD</p> <p>When flammable fluids are present in the work area, such as gasoline and windshield wiper fluid, be aware that flammable fumes can ignite or explode. To help prevent fire and explosion:</p> <ul style="list-style-type: none"> • Use equipment only in well ventilated area. • Eliminate all ignition sources, such as cigarettes and portable electric lamps. • Keep work area free of debris, including rags and spilled or open containers of solvent and gasoline. • Do not plug or unplug power cords or turn lights on or off when flammable fumes are present. • Ground all equipment in the work area. • Use only grounded hoses. • If there is static sparking or you feel a shock, stop operation immediately. Do not use equipment until you identify and correct the problem. • Keep a fire extinguisher in the work area.
	<p>ELECTRIC SHOCK HAZARD</p> <p>Improper grounding, setup, or usage of the system can cause electric shock.</p> <ul style="list-style-type: none"> • Turn off and disconnect power at main switch before disconnecting any cables and before servicing equipment. • Connect only to grounded power source. • All electrical wiring must be done by a qualified electrician and comply with all local codes and regulations.
	<p>PERSONAL PROTECTIVE EQUIPMENT</p> <p>You must wear appropriate protective equipment when operating, servicing, or when in the operating area of the equipment to help protect you from serious injury, including eye injury, inhalation of toxic fumes, burns, and hearing loss. This equipment includes but is not limited to:</p> <ul style="list-style-type: none"> • Protective eyewear • Clothing and respirator as recommended by the fluid and solvent manufacturer • Gloves • Hearing protection
	<p>PRESSURIZED EQUIPMENT HAZARD</p> <p>Fluid from the gun/dispense valve, leaks, or ruptured components can splash in the eyes or on skin and cause serious injury.</p> <ul style="list-style-type: none"> • Follow Pressure Relief Procedure in this manual, when you stop dispensing and before cleaning, checking, or servicing equipment. • Tighten all fluid connections before operating the equipment. • Check hoses, tubes, and couplings daily. Replace worn or damaged parts immediately.

WARNING
**EQUIPMENT MISUSE HAZARD**

Misuse can cause death or serious injury.

- Do not operate the unit when fatigued or under the influence of drugs or alcohol.
- Do not exceed the maximum working pressure or temperature rating of the lowest rated system component. See **Technical Data** in all equipment manuals.
- Use fluids and solvents that are compatible with equipment wetted parts. See **Technical Data** in all equipment manuals. Read fluid and solvent manufacturer's warnings. For complete information about your material, request MSDS forms from distributor or retailer.
- Check equipment daily. Repair or replace worn or damaged parts immediately with genuine Graco replacement parts only.
- Do not alter or modify equipment.
- Use equipment only for its intended purpose. Call your Graco distributor for information.
- Route hoses and cables away from traffic areas, sharp edges, moving parts, and hot surfaces.
- Do not kink or over bend hoses or use hoses to pull equipment.
- Keep children and animals away from work area.
- Comply with all applicable safety regulations.

**BURN HAZARD**

Equipment surfaces and fluid that's heated can become very hot during operation. To avoid severe burns, do not touch hot fluid or equipment. Wait until equipment/fluid has cooled completely.

Installation



When unpacking pump, check for shipping damage. Report any shipping damage to delivering carrier immediately.

CAUTION
Do not use a curb pump automatic shut-off nozzle with this pump. Use of a curb pump automatic nozzle may cause priming problems, reduced output flow, and motor overheating. If an automatic shut-off nozzle is required, use Graco part number 260082 (regular) or 260083 (unleaded) or Catlow, Inc. part number NCLF-1 (regular) or NCNLF-1 (unleaded).

Mounting Pump

CAUTION
<ul style="list-style-type: none"> • Ensure tank being used is clean and free of welding slag. • Ensure the tank has a vent to allow air into the tank as the herbicide is being pumped out. Failure to vent tank will cause priming problems.

1. Apply herbicide compatible sealant to large thread on bung adapter (9) (2 in. x 1-1/2 in. reducer fitting). Install bung adapter on tank.
2. Assemble suction tube sections by applying PVC cement (supplied with your pump) to the inside diameter of the PVC couplers. Make sure PVC cement is applied to the complete inside diameter and slide the pipe sections into the coupler with a twisting motion.

 For tanks deeper than 36 in. (914 mm) you will need a standard 1 in. (25 mm) pipe with 1 in. npt threads on one end. Suction tubes longer than 60 in. (1.52 m) require a foot valve (Graco Part No. 260217) at the bottom of the tube to prevent loss of prime.

3. Cut the suction tube so that it is 2 in. (55 mm) from the bottom of the tank when installed in the tank.
4. Insert inlet gasket (7) into union nut (1k). Apply a herbicide compatible sealant to the threads on the

suction tube assembly (5c) and screw the suction tube into the pump inlet (1j).

5. Insert suction tube attached to pump through bung adapter (9) into tank. Position pump as desired and tighten union nut (1k) on bung adapter (9).

Mounting Hose and Nozzle

1. Apply herbicide compatible sealant to male threads on the street elbow fitting (1e) and screw fitting into the 3/4 in. npt outlet port on the top of pump. Do not over tighten.
2. Apply herbicide compatible sealant to threads on both ends of the hose assembly. Screw one end of hose into the female thread on the fitting (1e) and tighten.
3. Screw nozzle onto the other end of hose and tighten.

Electrical Installation 12 VDC

To install wiring for a negative ground system:

1. Ensure pump switch is OFF.
2. To remove electrical cover (2a), remove four bolts (2c).

 Power cable can be cut to shorter length if 18 feet (5.5 m) is not required. Cut to proper length and proceed with steps 3 and 4.

3. Strip 3 in. (76 mm) of outside insulation from power cable (6c) from end opposite of fuse.
4. Strip 3/8 in. (10 mm) of insulation from red and black wires.
5. Slide strain relief (6b) over end of power cable (6c) on the end just stripped. Male thread of strain relief should be toward stripped end.
6. Insert power cable through conduit thread in electrical cover (2a). Connect wires from power cable to wires from the motor using wire nuts (2e): red to red and black to black.

7. Screw strain relief (6b) into electrical cover (2a).
 8. Position power cable (6c) so the large diameter of power cable extends through strain relief (6b).
 9. Tighten nut on strain relief to form a seal around the power cable.
 10. Reinstall electrical cover (2a) on the pump.
 11. Remove 1/2 in. (13 mm) of insulation from wires on the fuse holder end of the power cable.
 12. Attach battery clamps (6a) with red sleeve to red wire and black sleeve to black wire. Wire must be crimped to the battery clamp firmly to get a good electrical connection.
 13. Connect red wire with fuse holder inline to positive battery terminal. Connect black wire to negative battery terminal.
6. Insert electrical power wire through conduit opening in back of pump.
 7. Using wire nuts (2e), connect wires: green to green, white to white, and black to black.
 8. Replace electrical cover.

Priming Pump

1. All pump models will prime with no fluid in the pumping chamber to a height of 5 ft (1.52 m). If pump fails to prime, remove hose from street elbow fitting on pump outlet and pour 8 oz (0.24 liter) of motor oil into the pump outlet port.
2. If suction height is too great, the pump may lose its prime if the nozzle is opened with the pump turned off.
3. To hold fluid in the suction tube, a check valve (Graco Part No. 260217) may be required on the bottom of tanks with a suction height over 5 ft (1.52 m).
4. The tank must be vented or the pump may not prime or may lose its prime due to a vacuum in the tank.

Electrical Installation 115 VAC



On 115 VAC pumps, electrical connections must be made by a licensed electrician per requirements of local, state, and national codes regarding class 1, group D installations. Only rigid conduit with threaded connections should be used. Conduit opening in pump must be sealed with waterproof, herbicide-resistant sealant. Failure to comply with this warning could result in injury from electrical shock.

1. Ensure pump switch is OFF and electrical power is disconnected.
2. Install conduit and user-supplied power cord to pump.
3. Strip 3 in. (76 mm) from power cord jacket and 1/2 in. (13 mm) from individual conductor insulation.
4. To remove electrical cover (2a), remove four bolts (2c).
5. Remove 1/2 in. (13 mm) of insulation from power wires inside pump electrical terminal cavity.

Operation



Before servicing, turn pump off and open the nozzle to relieve pressure.

CAUTION
Do not operate pump dry. Do not run pump for more than 5 minutes with nozzle closed. Do not operate pump for more than 30 minutes continuously in 1 hour.

On/Off switch lever (8d) is located under nozzle holder. Remove nozzle before turning pump on.

1. Move switch lever (8d) on.
2. Insert nozzle into tank and actuate nozzle lever to dispense herbicide.
3. Immediately after dispensing herbicide turn switch lever (8d) off.

Maintenance

1. Clean inlet strainer (3b) after every 50 hours of operation.
2. To remove inlet strainer (3b), remove four screws (3c) and strainer cover (3a). Remove and clean strainer.
3. If strainer is excessively dirty, clean tank to protect pump and the equipment.
4. After cleaning strainer, replace strainer and cover. Make sure cover seal (3d) is in place.

Flushing Pump

Proper flushing of pump after use with herbicides and chemicals is essential for long service life. Many herbicides dry quickly and will make pump inoperative if allowed to dry inside pump.

CAUTION
All fluids pumped must be compatible with wetted parts listed on page 12.

1. Remove pump from tank and insert suction tube into water or chemical agent recommended by chemical manufacturer.
2. Operate pump until fluid discharge is free of chemical.
3. For extended storage after use with herbicide or chemical, flush pump and fill with diesel fuel.

Troubleshooting

Problem	Cause	Solution
Motor runs but pump will not prime.	Motor rotation wrong. (12 VDC units only.)	Check wiring instructions for possible problems.
	Missing relief valve o-ring seal (4c).	Remove gear cover (1b) inspect seal (4c), replace if missing or damaged.
	Sheared drive key (1g).	Remove cover (1b) and inspect key (1g/10b), replace if worn or sheared.
	Dirt under relief poppet (4a) or seal (4c).	Remove cover (1b) and inspect, clean or replace if damaged.
	Strainer seal (3d) leaking.	Inspect and replace if damaged.
	Suction height too high to prime.	See Priming Pump , page 5.
	Worn or damaged gears.	Remove cover (1b) and inspect gears. Replace if worn or damaged.
	Fluid level low.	Refill tank.
	Cover seal (1f/10c) damaged.	Replace if worn or damaged.
	Inlet strainer (3b) clogged.	Remove and clean or replace.
	Air leak in suction tube.	Inspect all joints in suction tube, make sure all joints have sealant applied.
	Air lock in system.	This may occur if filter or meter or automatic shut-off nozzle is used. If this occurs, fill pump and meter with herbicide through top of pump.
	Motor does not run at proper speed.	Check electric connections. Check supply voltage for proper voltage level.
Unit pumps but output flow is low.	Clogged inlet strainer (3b).	Clean or replace.
	Air leak in suction tube.	Check to make sure all joints in suction tube are sealed.
	Suction tube too close to tank bottom.	Suction tube must have a 2 in. (51 mm) minimum clearance.
	Tank empty.	Refill tank.
	Tank not vented.	Tank must be vented to atmosphere.
	Worn or damaged gears.	Remove cover (1b) and inspect gears. Replace if worn or damaged.
	Damaged motor.	Replace motor.
	Clogged suction tube, hose, or nozzle.	Inspect and clean.
Motor stalls when nozzle is closed.	Bypass relief valve (4a) stuck.	Inspect relief valve, making sure poppet is free. Replace if damaged.
	Low supply voltage.	Check supply voltage.
	Gears (1c/10a) damaged and binding.	Inspect gears. Gears should turn freely. Replace if damaged.
	Faulty motor.	Replace motor.

Problem	Cause	Solution
Herbicide leaking in motor mount.	Faulty or damaged motor shaft seal (1h).	Replace shaft seal
	Operating pump extended time with nozzle closed.	Do not exceed 5 minutes of operation with nozzle closed.
	Motor shaft worn.	Replace motor if shaft has groove worn in seal area.
Motor overheating.	Gears (1c/10a) binding.	Check to make sure gears turn freely on shaft.
	Operating pump extended time with nozzle closed.	Do not exceed 5 minutes of operation with nozzle closed.
	Clogged inlet strainer (3b).	Clean or replace, see Maintenance , page 6.
	Clogged suction tube, hose, or nozzle.	Inspect and clean if required.
	Operating pump more than 30 minutes continuous duty.	Limit operation to 30 minutes per hour.
Switch will not turn pump on.	Blown fuse.	Replace fuse. 20 amp automotive fuse (Littelfuse ATO 257020 or Bussman ATC-20).
	Electrical problem.	Check that supply voltage is proper and getting to pump.
	Defective switch (8e).	Check and replace if defective.
	Mechanical problem.	Check switch actuator cam (8c). Cam should be actuating the switch (8e).
	Damaged or defective motor.	Check motor, replace if damaged or defective.

Parts Drawing

Models 260410 and 260411, 12 VDC
Models 260408 and 260409, 115 VAC

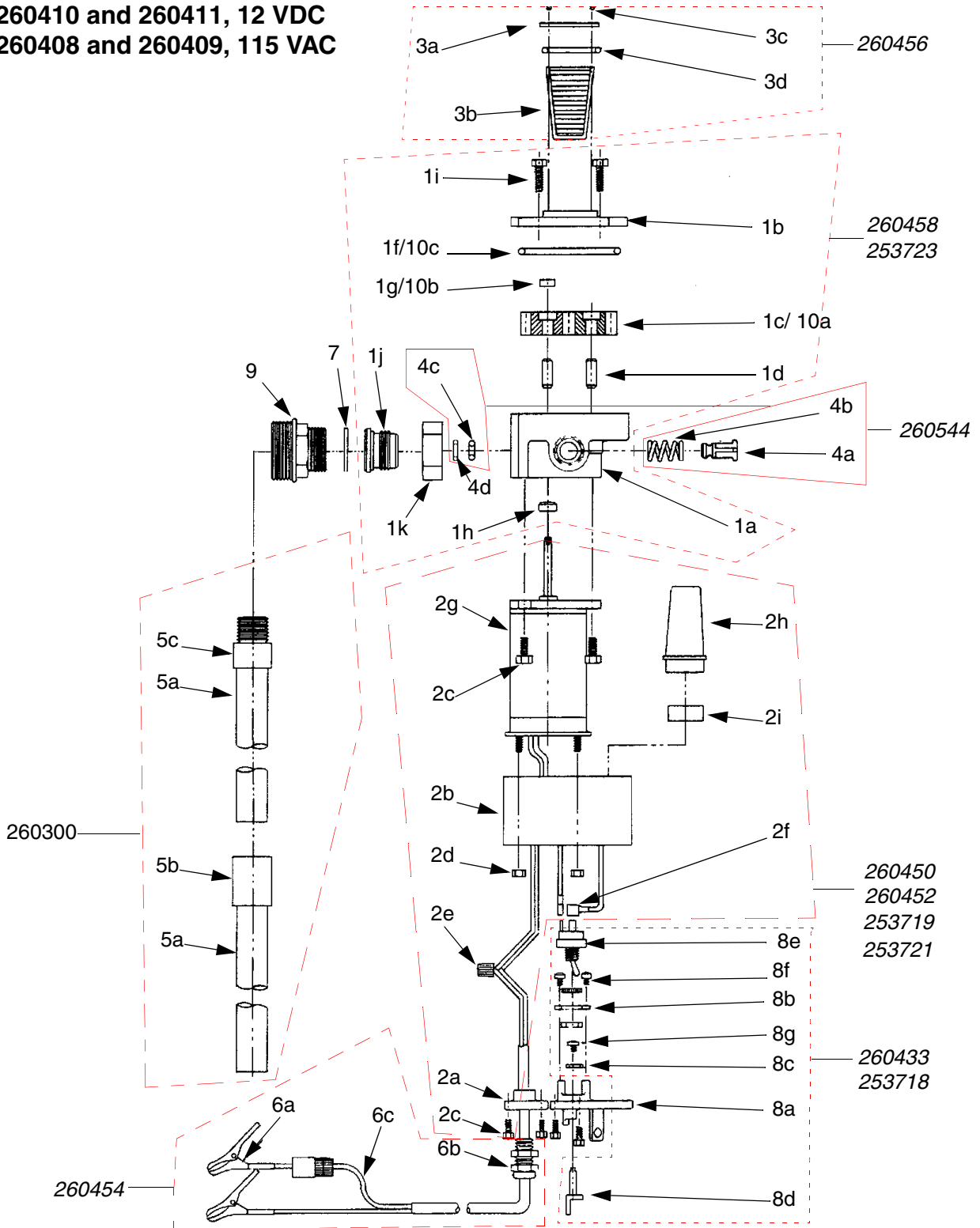

Parts List

Models 260410 and 260411, 12 VDC Models 260408 and 260409, 115 VAC

Ref. No.	Description	Qty.	Ref. No.	Description	Qty.
1	260458 KIT, pump with swivel, blue (includes items 1a-1k)		5	260300 KIT, suction, pipe; includes items 5a-5d (Models 260411, 260409 only)	
	253723 KIT, pump with swivel, black (includes items 1a-1k)		5a	PIPE, PVC	2
	1a BODY, assembly	1	5b	COUPLER, PVC, female	1
	1b COVER, gear	1	5c	ADAPTER, PVC, male	1
	1c (10a) GEAR	2	5d	CEMENT, PVC (not shown)	1
	1d SHAFT, gear	2	6*	260454 KIT, cable, 12 V (includes items 6a-6c)	
	1e FITTING, outlet, 3/4 in. npt, street elbow (not shown)	1	6a	CLAMP, battery BLACK SLEEVE RED SLEEVE	2 1 1
	1f (10c) SEAL, gear cover	1	6b	STRAIN RELIEF	1
	1g (10b) KEY, drive	1	6c	ASSEMBLY, power cable, 18 ft (5.5 m), fuse holder, 20 amp fuse	1
	1h SEAL, shaft	1	7	260084 GASKET, inlet	1
	1i BOLT, hex, 5/16-18 x 3/4 in.	4	8	260433 KIT, switch, blue (includes items 8a-8g)	
	1j FITTING, inlet	1		253718 KIT, switch, black (includes items 8a-8g)	
	1k NUT, union	1	8a	COVER, switch	1
2	260450 KIT, motor, 12 VDC, blue (includes items 2a-2i)		8b	BRACKET, switch	1
	260452 KIT, motor, 115 VAC, blue (includes items 2a-2i)		8c	CAM, actuator switch	1
	253719 KIT, motor, 12 VDC, black (includes items 2a-2i)		8d	SWITCH, actuator assy.	1
	253721 KIT, motor, 115 VAC, black (includes items 2a-2i)		8e	SWITCH	1
	2a COVER, electrical	1	8f	SCREW, phillips, 8-32 x 3/8 in.	2
	2b HOUSING, electrical, 12 V	1	8g	SCREW, phillips, 6-32 x 1/4 in.	1
	2c BOLT, hex, 1/4-20 x 3/4 in.	10	9	260061 ADAPTER, bung	1
	2d NUT, 10-32	2	10	260277 KIT, gear (includes 10a-10c)	
	2e WIRE NUT, 260450	2	10a (1c)	GEAR	2
	WIRE NUT, 260452	3	10b (1g)	KEY, drive	1
	2f FLAG TERMINAL	2	10c (1f)	SEAL, gear, cover	1
	2g MOTOR, electric	1	11	260310 HOSE, 8 ft, 3/4 in. (MBE), (Models 260411, 260409 only) (not shown)	
	2h COVER, nozzle	1	12	260079 NOZZLE, 3/4 npt (f), (Models 260411, 260409 only) (not shown)	
	2i GUIDE, nozzle	1	13▲	15G901 LABEL, warning (not shown)	
3	260456 KIT, filter, universal (includes items 3a-3d)				
	3a COVER, strainer	1			
	3b SCREEN	1			
	3c SCREW, hex head, 10-24 x 3/8 in.	4			
	3d SEAL, strainer cover	1			
4	260544 KIT, popoff (includes items 4a-4d)				
	4a POPPET, relief valve	1			
	4b SPRING, relief valve	1			
	4c SEAL, relief valve	1			
	4d RING, retaining	1			

▲ Replacement Danger and Warning labels, tags, and cards are available at no cost.

* Used on 12 VDC models only

Technical Data

Working pressure	10 psi (0.07 MPa, 0.7 bar)
Inlet size	1 in. npt
Outlet size	3/4 in. npt
Weight	20 lb (9 kg)
Power cable	18 ft (5.5 m), 14 AWG (12 VDC models only)
Current draw.	12 VDC models: 12.5 amps 115 VAC models: 2 amps
Duty cycle.	30 min/hour
Suction tube	1 in. x 34 in. (25.4 mm x 864 mm)
Wetted parts	carbon steel with zinc plating, 416 and 302 stainless steel, fluoroelastomer, Buna-N, Aluminum, Valox [®] , Nylon, Nitrile, PVC, Vellumoid, PTFE, EPDM

Valox[®] is a registered trademark of the General Electric Company

Performance Chart

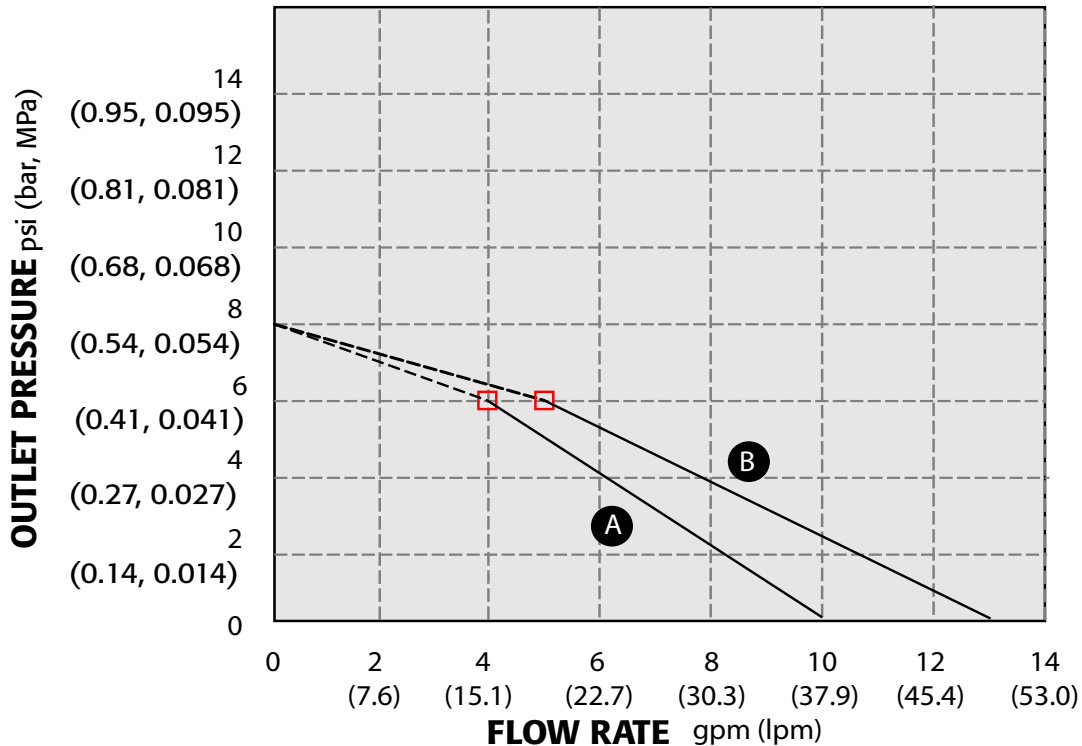

PART NUMBERS LEGEND	
Ⓐ = 12VDC	Pressure relief opens □
Ⓑ = 115VAC	



A series of horizontal lines spanning the width of the page, providing a template for technical data or notes.

Graco Standard Warranty

Graco warrants all equipment referenced in this document which is manufactured by Graco and bearing its name to be free from defects in material and workmanship on the date of sale to the original purchaser for use. With the exception of any special, extended, or limited warranty published by Graco, Graco will, for a period of twelve months from the date of sale, repair or replace any part of the equipment determined by Graco to be defective. This warranty applies only when the equipment is installed, operated and maintained in accordance with Graco's written recommendations.

This warranty does not cover, and Graco shall not be liable for general wear and tear, or any malfunction, damage or wear caused by faulty installation, misapplication, abrasion, corrosion, inadequate or improper maintenance, negligence, accident, tampering, or substitution of non-Graco component parts. Nor shall Graco be liable for malfunction, damage or wear caused by the incompatibility of Graco equipment with structures, accessories, equipment or materials not supplied by Graco, or the improper design, manufacture, installation, operation or maintenance of structures, accessories, equipment or materials not supplied by Graco.

This warranty is conditioned upon the prepaid return of the equipment claimed to be defective to an authorized Graco distributor for verification of the claimed defect. If the claimed defect is verified, Graco will repair or replace free of charge any defective parts. The equipment will be returned to the original purchaser transportation prepaid. If inspection of the equipment does not disclose any defect in material or workmanship, repairs will be made at a reasonable charge, which charges may include the costs of parts, labor, and transportation.

THIS WARRANTY IS EXCLUSIVE, AND IS IN LIEU OF ANY OTHER WARRANTIES, EXPRESS OR IMPLIED, INCLUDING BUT NOT LIMITED TO WARRANTY OF MERCHANTABILITY OR WARRANTY OF FITNESS FOR A PARTICULAR PURPOSE.

Graco's sole obligation and buyer's sole remedy for any breach of warranty shall be as set forth above. The buyer agrees that no other remedy (including, but not limited to, incidental or consequential damages for lost profits, lost sales, injury to person or property, or any other incidental or consequential loss) shall be available. Any action for breach of warranty must be brought within two (2) years of the date of sale.

GRACO MAKES NO WARRANTY, AND DISCLAIMS ALL IMPLIED WARRANTIES OF MERCHANTABILITY AND FITNESS FOR A PARTICULAR PURPOSE, IN CONNECTION WITH ACCESSORIES, EQUIPMENT, MATERIALS OR COMPONENTS SOLD BUT NOT MANUFACTURED BY GRACO. These items sold, but not manufactured by Graco (such as electric motors, switches, hose, etc.), are subject to the warranty, if any, of their manufacturer. Graco will provide purchaser with reasonable assistance in making any claim for breach of these warranties.

In no event will Graco be liable for indirect, incidental, special or consequential damages resulting from Graco supplying equipment hereunder, or the furnishing, performance, or use of any products or other goods sold hereto, whether due to a breach of contract, breach of warranty, the negligence of Graco, or otherwise.

FOR GRACO CANADA CUSTOMERS

The Parties acknowledge that they have required that the present document, as well as all documents, notices and legal proceedings entered into, given or instituted pursuant hereto or relating directly or indirectly hereto, be drawn up in English. Les parties reconnaissent avoir convenu que la rédaction du présente document sera en Anglais, ainsi que tous documents, avis et procédures judiciaires exécutés, donnés ou intentés, à la suite de ou en rapport, directement ou indirectement, avec les procédures concernées.

Graco Information

TO PLACE AN ORDER, contact your Graco distributor or call to identify the nearest distributor.

Phone: 612-623-6928 or **Toll Free:** 1-800-533-9655, **Fax:** 612-378-3590

*All written and visual data contained in this document reflects the latest product information available at the time of publication.
Graco reserves the right to make changes at any time without notice.*

This manual contains English. MM 311628

Graco Headquarters: Minneapolis

International Offices: Belgium, China, Japan, Korea

GRACO INC. P.O. BOX 1441 MINNEAPOLIS, MN 55440-1441

www.graco.com

311628 10/2006 Revised 9/2009

Download from Www.Somanuals.com. All Manuals Search And Download.

Free Manuals Download Website

<http://myh66.com>

<http://usermanuals.us>

<http://www.somanuals.com>

<http://www.4manuals.cc>

<http://www.manual-lib.com>

<http://www.404manual.com>

<http://www.luxmanual.com>

<http://aubethermostatmanual.com>

Golf course search by state

<http://golfingnear.com>

Email search by domain

<http://emailbydomain.com>

Auto manuals search

<http://auto.somanuals.com>

TV manuals search

<http://tv.somanuals.com>